



**Technical Service  
Information Bulletin**

September 28, 2001

Title:

# PRECAUTION FOR CONSOLE PANEL UPPER INSTALLATION

Models:

'02 SC 430

**BODY**  
**BO012-01**

**Introduction** When installing the console panel sub-assembly upper, be sure to close the ash receptacle door because the arm may interfere with the console box assembly and damage it if the ash receptacle door is open.

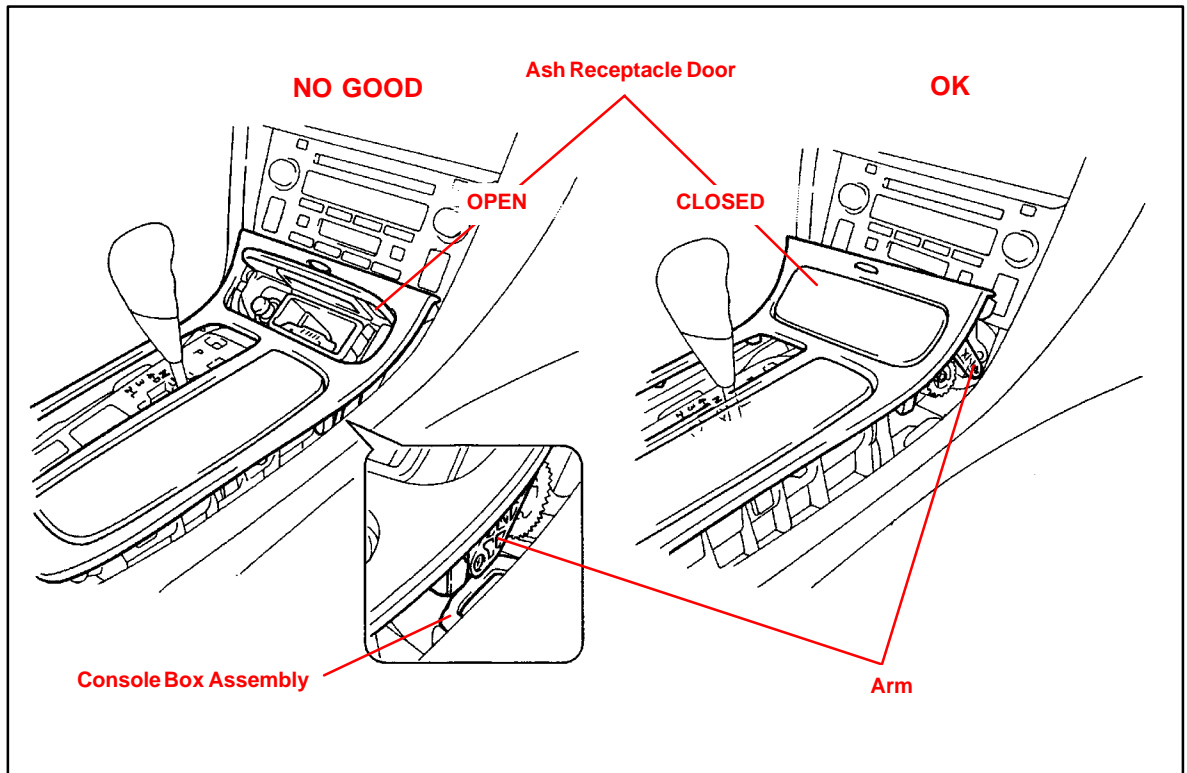

**Applicable Vehicles**

- 2002 model year **SC 430** vehicles.

**Warranty Information**

OP CODE	DESCRIPTION	TIME	OPN	T1	T2
N/A	Not Applicable to Warranty	—	—	—	—

