

# G ELECTRICAL WIRING ROUTING

## Position of Parts in Seat

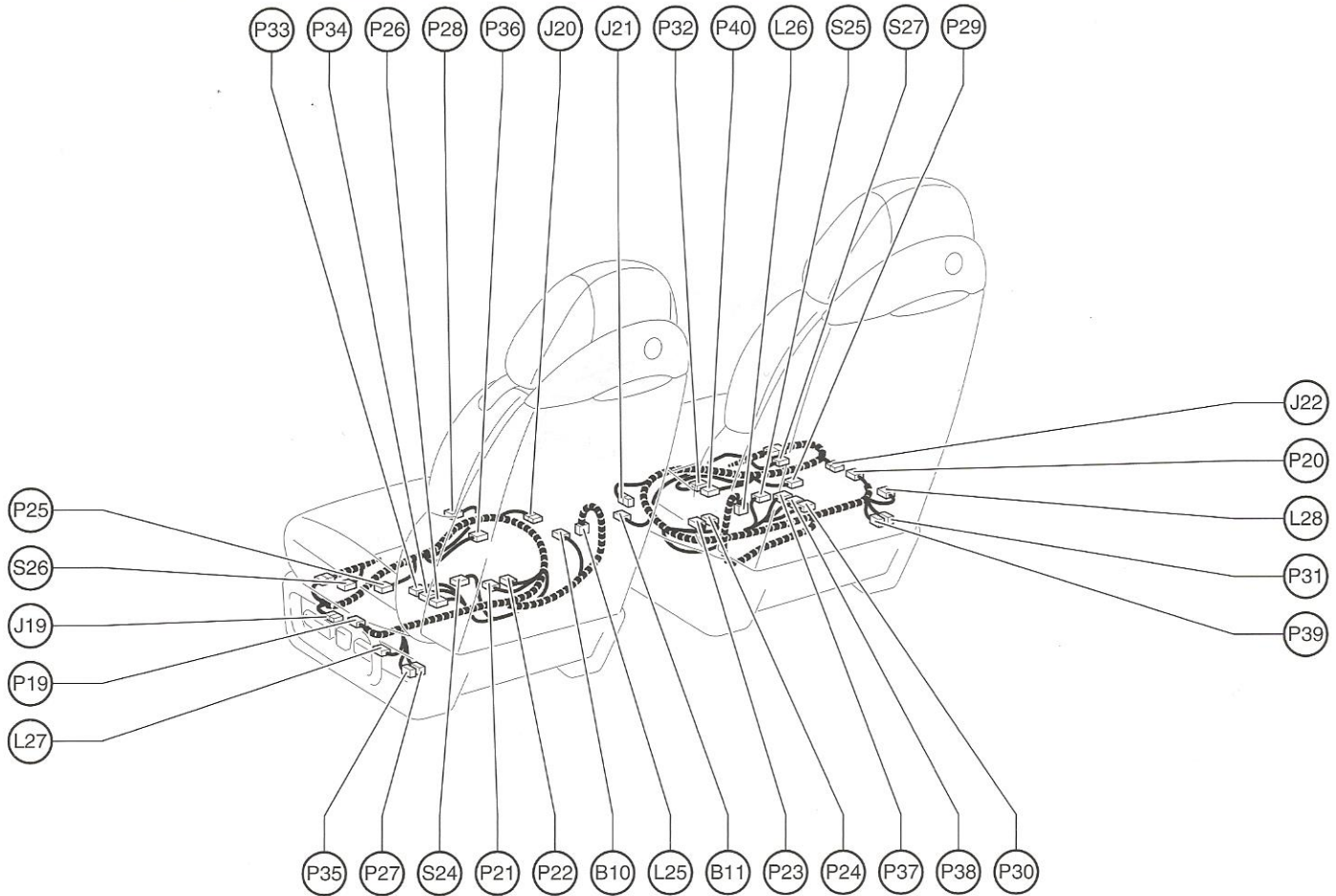

- |  |  |
|--|--|
| B 10 Buckle SW LH  | P 30 Power Seat Motor<br>(Front Passenger's Seat Lifter Control)                   |
| B 11 Buckle SW RH and Occupant Detection Sensor                          | P 31 Power Seat Motor<br>(Front Passenger's Seat Reclining Control)                |
| J 19 Junction Connector  | P 32 Power Seat Motor<br>(Front Passenger's Seat Slide Control)                    |
| J 20 Junction Connector  | P 33 Power Seat Position Sensor<br>(Driver's Seat Front Vertical Control)          |
| J 21 Junction Connector  | P 34 Power Seat Position Sensor (Driver's Seat Lifter Control)                     |
| J 22 Junction Connector  | P 35 Power Seat Position Sensor<br>(Driver's Seat Reclining Control)               |
| L 25 Lumbar Support Control Motor (Driver's Seat)                        | P 36 Power Seat Position Sensor (Driver's Seat Slide Control)                      |
| L 26 Lumbar Support Control Motor (Front Passenger's Seat)               | P 37 Power Seat Position Sensor<br>(Front Passenger's Seat Front Vertical Control) |
| L 27 Lumbar Support Control SW (Driver's Seat)                           | P 38 Power Seat Position Sensor<br>(Front Passenger's Seat Lifter Control)         |
| L 28 Lumbar Support Control SW (Front Passenger's Seat)                  | P 39 Power Seat Position Sensor<br>(Front Passenger's Seat Reclining Control)      |
| P 19 Power Seat Control SW (Driver's Seat)                               | P 40 Power Seat Position Sensor<br>(Front Passenger's Seat Slide Control)          |
| P 20 Power Seat Control SW (Front Passenger's Seat)                      | S 24 Seat Heater Controller (Driver's Seat)  |
| P 21 Power Seat ECU (Driver's Seat)                                      | S 25 Seat Heater Controller (Front Passenger's Seat)                               |
| P 22 Power Seat ECU (Driver's Seat)                                      | S 26 Side Airbag Squib LH  |
| P 23 Power Seat ECU (Front Passenger's Seat)                             | S 27 Side Airbag Squib RH  |
| P 24 Power Seat ECU (Front Passenger's Seat)                             |  |
| P 25 Power Seat Motor (Driver's Seat Front Vertical Control)             |  |
| P 26 Power Seat Motor (Driver's Seat Lifter Control)                     |  |
| P 27 Power Seat Motor (Driver's Seat Reclining Control)                  |  |
| P 28 Power Seat Motor (Driver's Seat Slide Control)                      |  |
| P 29 Power Seat Motor<br>(Front Passenger's Seat Front Vertical Control) |  |