

2010 Lexus RX350

Submodel: | Engine Type: V6 | Liters: 3.5

Fuel Delivery: FI | Fuel: GAS

Last Modified: 2010-12-6 00:00:00

Model Year: 2010

Engine Family: 2GR-FE

Title: STEERING COLUMN: STEERING WHEEL: REMOVAL (2010 RX350 to 08/2009)

A

Model: RX350

Body Type:

From:200812

Doc ID: RM0000033RT01BX

VDS: BK1BA ZK1BA

REMOVAL

CAUTION:

Some of these service operations affect the SRS airbag system. Read the precautionary notices concerning the SRS airbag system before servicing. [Click here for more information..](#)

1. PRECAUTION (w/ Navigation System for HDD)

NOTICE:

After the engine switch is turned off, the display and navigation module display (HDD navigation system) records various types of memory and settings. As a result, after turning the engine switch off, make sure to wait at least 60 seconds before disconnecting the cable from the negative (-) battery terminal.

2. PRECAUTION

NOTICE:

Be sure to read Precaution thoroughly before servicing. [Click here for more information..](#)

3. ALIGN FRONT WHEELS FACING STRAIGHT AHEAD

4. REMOVE STEERING PAD

HINT:

Refer to the instructions for Removal of the steering pad. [Click here for more information..](#)

5. REMOVE STEERING WHEEL ASSEMBLY

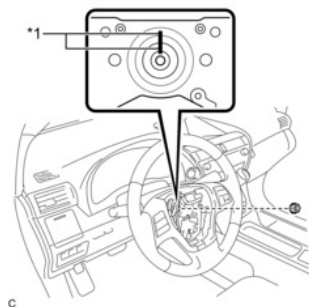

(a) Remove the steering wheel assembly set nut.

Text in Illustration

*1	Matchmark
----	-----------

(b) Put matchmarks on the steering wheel assembly and steering main shaft.

(c) Disconnect the connectors from the spiral cable.

(d) Using SST, remove the steering wheel assembly.

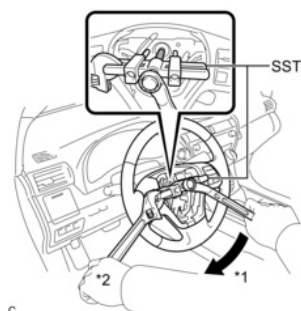

Text in Illustration

*1	Turn
----	------

*2	Hold
----	------

SST: 09950-50013

09951-05010

09952-05010

09953-05020

09954-05070

NOTICE:

Apply a small amount of grease to the threads and tip of SST (09953-05020) before use.

6. REMOVE STEERING SHAKE DAMPER



(a) Remove the 2 screws.

(b) Remove the steering shake damper from the steering wheel assembly.

7. REMOVE STEERING PAD SWITCH ASSEMBLY

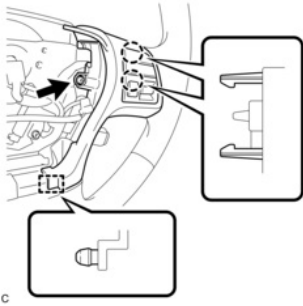

(a) Remove the screw.

(b) Disengage the 2 claws and pin to remove the steering pad switch assembly (RH side) from the steering wheel sub-assembly.

(c) Remove the screw.

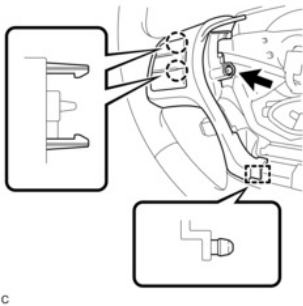

(d) Disengage the 2 claws and pin to remove the steering pad switch assembly (LH side) from the steering wheel sub-assembly.

8. REMOVE CRUISE CONTROL MAIN SWITCH [Click here for more information.](#)

9. REMOVE CRUISE CONTROL SWITCH WIRE

10. REMOVE LOWER STEERING WHEEL BOSS COVER

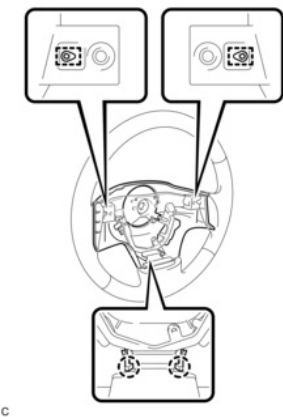

(a) Remove the 2 pins.

(b) Disengage the 2 claws to remove the lower steering wheel boss cover from the steering wheel sub-assembly.

11. REMOVE STEERING PAD ATTACHING SCREW

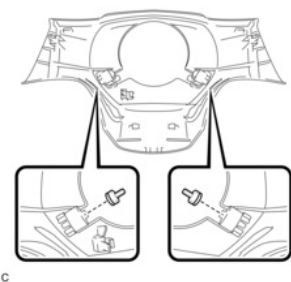

(a) Remove the 2 steering pad attaching screws from the lower steering wheel boss cover.