



**Technical Service
Information Bulletin**

March 4, 2008

Title:

**REPAIR MANUAL SUPPLEMENT:
SRS LIGHT "ON" — DTC B0111/B0116 -
OPEN SIDE SQUIB CIRCUIT**

Models:

'04 – '08 RX 330/350/400h

ELECTRICAL
EL001-08

Introduction For vehicles that exhibit Diagnostic Trouble Code (DTC) B0111 and/or B0116, a new service part has been made available for 2004 – 2008 model year RX 330, RX 350, and RX 400h vehicles. Please refer to the following enhanced Repair Manual instructions for the proper installation procedure of the new service parts.

- Applicable Vehicles**
- **2004 – 2008** model year **RX 330, RX 350, and RX 400h** vehicles.

**Parts
Information**

| SEAT TYPE | CURRENT PART NUMBER | PART NAME | QTY |
|----------------|---------------------|------------------------------|-----|
| Driver Seat | 73920-0E013 | Airbag Assembly, FR Seat, LH | 1 |
| Passenger Seat | 73910-0E013 | Airbag Assembly, FR Seat, RH | 1 |
| All | 90080-17200 | Nut | 2 |

**Warranty
Information**

| OP CODE | DESCRIPTION | TIME | OFP | T1 | T2 |
|---------|---|------|-------------|----|----|
| EL8007 | R & R Side Airbag Assembly (One Side) | 1.6 | 739#0-0E013 | 8C | 71 |
| EL8008 | R & R Side Airbag Assembly (Both Sides) | 3.0 | 73920-0E013 | 8C | 71 |

Applicable Warranty*:

This repair is covered under the Lexus Restraint Systems Warranty. This warranty is in effect for 72 months or 70,000 miles, whichever occurs first, from the vehicle's in-service date.

* Warranty application is limited to correction of a problem based upon a customer's specific complaint.



Required Tools & Equipment

| SPECIAL SERVICE TOOLS (SSTs) | PART NUMBER | QTY | DRW** |
|---|----------------|-----|-------|
| Plastic Pry Tool Set* | 00002-06000-01 | 1 | 20 |
| <p>NOTE:</p> <ul style="list-style-type: none"> All components from this kit/set are required. Plastic Panel Clip Removal Tool (P/N 00002-06001-01) Plastic Emblem Removal Tool (P/N 00002-06002-01) | | | |

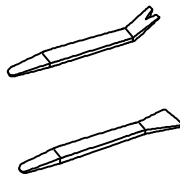

* Essential SST.
 ** Drawer number in SST Storage System.

NOTE:
 Additional SSTs may be ordered by calling SPX/OTC at 1-800-933-8335.

| REQUIRED EQUIPMENT | SUPPLIER | PART NUMBER | QTY |
|---|----------|-------------|-----|
| <p>TIS techstream*</p> <p>NOTE: Software version 2.20.015 or later is required.</p> | ADE | TSPKG1 | 1 |



* Essential SST.

NOTE:

- Additional TIS techstream units may be ordered by calling Approved Dealer Equipment (ADE) at 1-800-368-6787.
- The Lexus Diagnostic Tester and CAN Interface Module may also be used to perform the service procedures listed in this bulletin.

Airbag Disposal:

Please refer to TSIB No. SS005-07, "SRS Component Disposal as Hazardous Material Treatment", for proper disposal method of the side airbag assembly.

Repair Procedure

Follow the diagnostic procedure in the Technical Information System (TIS):

- 2004 – 2008 model year RX 330, RX 350, or RX 400h Repair Manual, *Vehicle Interior – Supplemental Restraint System – "B0111 Open In Side Squib RH Circuit"*.
- 2004 – 2008 model year RX 330, RX 350, or RX 400h Repair Manual, *Vehicle Interior – Supplemental Restraint System – "B0116 Open In Side Squib LH Circuit"*.

NOTE:

If no concern is identified after inspecting the floor harness and the center airbag sensor assembly, please follow the repair procedure below to replace the corresponding side airbag assembly.

Power Seat (Driver and Passenger):**CAUTION:**

- Always wear safety gloves because the edges of the seatback frame and seat adjuster are sharp and may cause injury.
- Work must be started more than 90 seconds AFTER the ignition switch is turned to the LOCK position and the negative (-) terminal cable is disconnected from the battery. (The SRS is equipped with a back-up power source. If work is started within 90 seconds from disconnecting the negative (-) terminal cable of the battery, the SRS may deploy.)

NOTE:

- Installation is in the reverse order of removal. However, special points concerning installation are indicated.
- Use the same procedures for the RH side and LH side.
- Be careful NOT to damage the body.

1. Remove the seat track bracket cover inner front LH.
 - A. Using a plastic pry tool, disengage the 3 claws.
 - B. Remove the seat track bracket cover inner front LH by pulling it out.

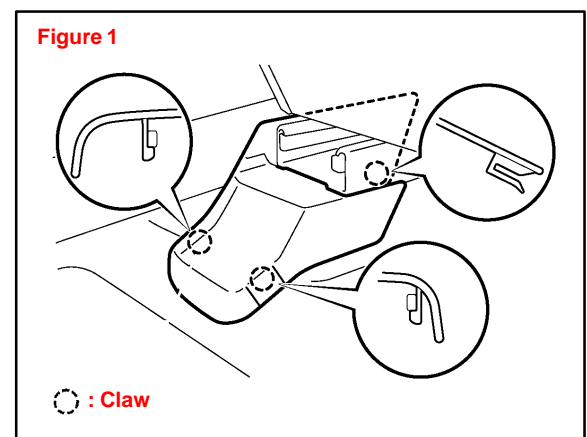

Repair Procedure
(Continued)

2. Remove the seat track bracket cover outer front LH.
Using a plastic pry tool, disengage the 2 claws and remove the seat track bracket cover outer front LH.

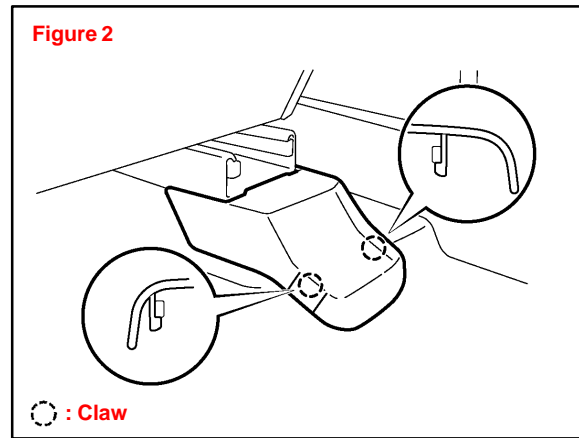

3. Remove the seat track cover RH.
Using a plastic pry tool, disengage the 4 claws and remove the seat track cover RH.
4. Remove the seat track cover LH.
Use the same procedures described for the RH side.

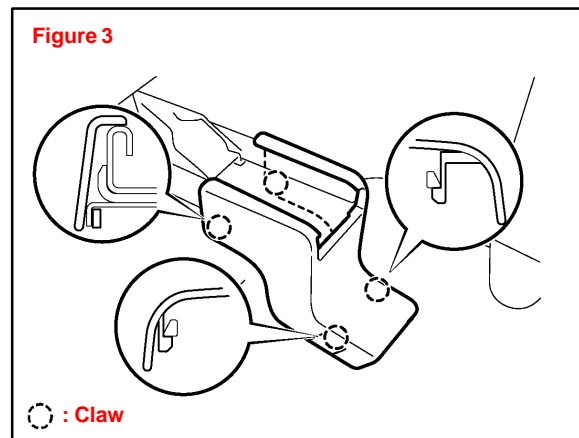

5. Remove the front seat assembly.
 - A. Disconnect the connectors under the front seat assembly.
 - B. Remove the 4 bolts and the front seat assembly.

NOTE:

Place protective cover over door sill. Be careful NOT to damage the body.

6. Remove the front seat headrest assembly.
7. Remove the reclining power seat switch knob.
Using a plastic pry tool, pry out the reclining power seat switch knob.
8. Remove the slide and vertical power seat switch knob.
Using a plastic pry tool, pry out the slide and vertical power seat switch knob.

Repair Procedure
(Continued)

9. Remove the front seat inner cushion shield.
 - A. Remove the 7 screws.
 - B. Using a plastic pry tool, disengage the 4 claws and clip, and remove the front seat cushion shield together with the front seat inner cushion shield and front seat inner cushion shield No. 1.

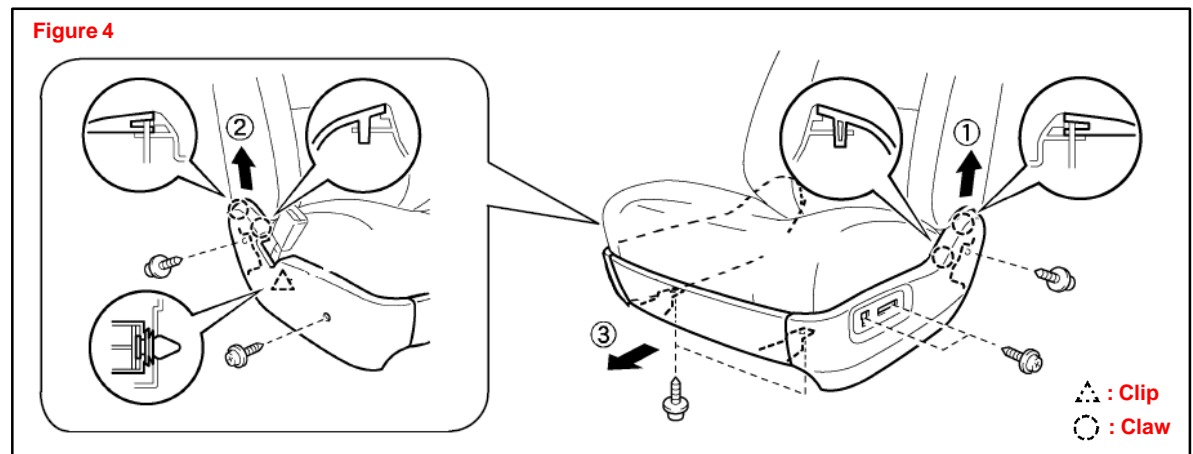

10. Remove the front seat inner cushion shield No.1.
 - C. Remove the screw and front seat inner cushion shield No. 1 from the front seat cushion shield.
11. Remove the front seatback board cover sub-assembly.
 - A. Remove the 2 screws.
 - B. Disengage the 2 claws and remove the front seatback board sub-assembly.

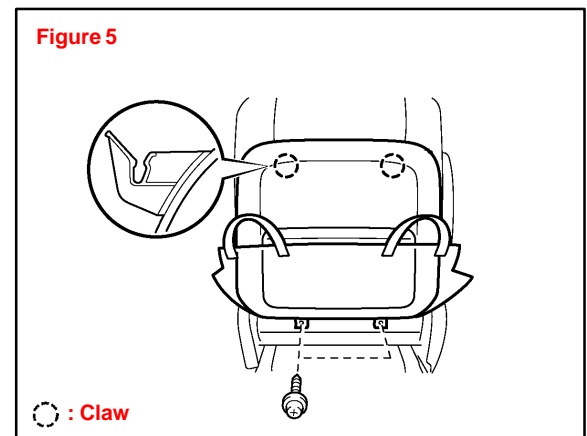

12. Remove the seat armrest cover.

Using a plastic pry tool, disengage the 2 claws and remove the seat armrest cover.

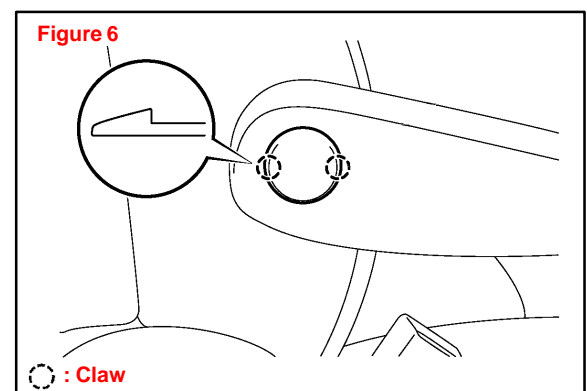

**Repair
Procedure**
(Continued)

13. Remove the seat armrest assembly.
Remove the bolt and seat armrest assembly.
14. Remove the seatback cover with pad.
 - A. Remove the nut and disengage the seatback cover bracket.
 - B. Disengage the hooks.
 - C. Disconnect the seat heater connector and disengage the 2 clips for the harness.
 - D. Remove the seatback cover with pad.

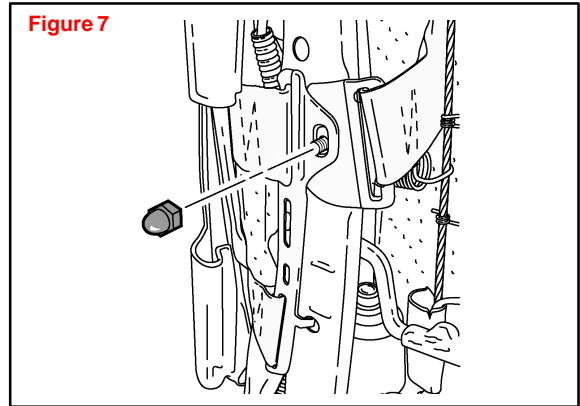

- E. Remove the front seat head support by disengaging the claw while sliding the seat cover off.
15. Remove the side airbag assembly.
 - A. Remove the 2 nuts from the side airbag assembly.
 - B. Remove the 1 clip holding the airbag wire harness.

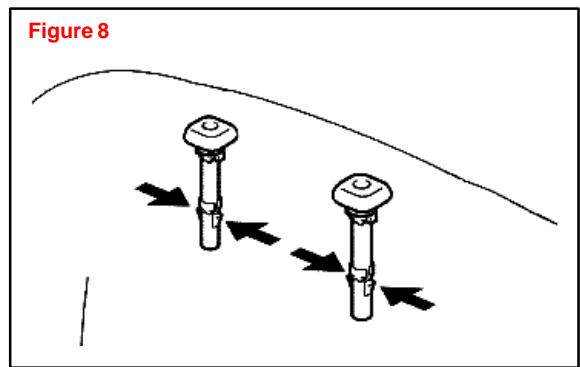

NOTE:

The remaining 5 clips holding the wire harness will be removed when installing the NEW airbag and wire harness.

Repair Procedure
(Continued)

16. Install the NEW side airbag assembly.

A. Place the side airbag into the seat frame with the wire harness in the up direction.

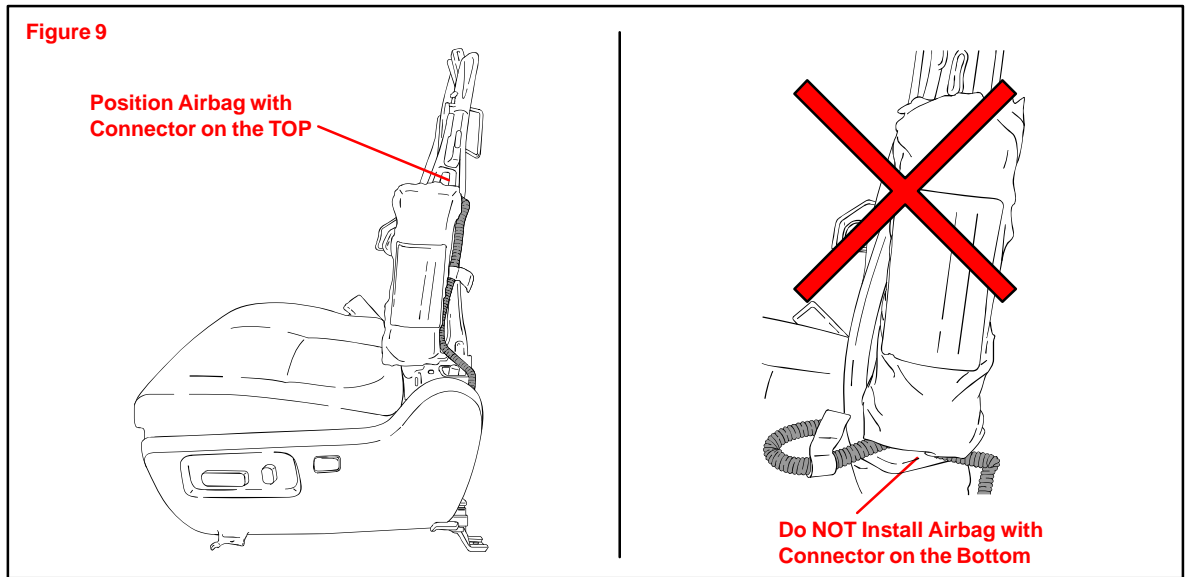

B. Secure the side airbag with 2 NEW nuts.

Torque: 5.5 N•m (56 kgf•cm, 48 in.•lbf)

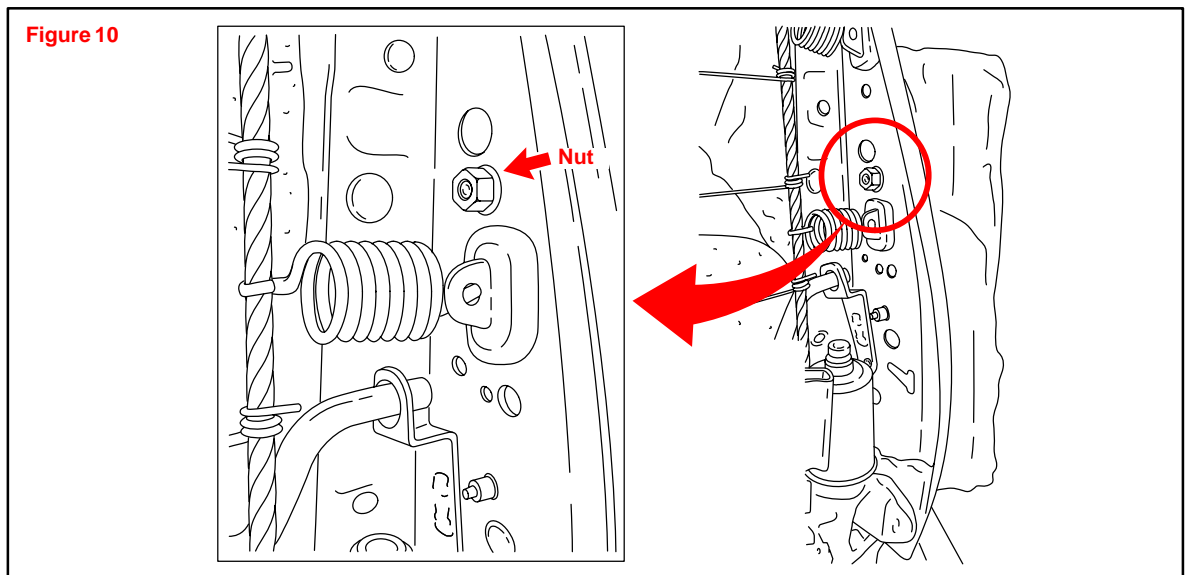

Repair Procedure
(Continued)

C. Using the diagrams below, remove the original wire harness while routing the NEW wire harness and attach the 6 retaining clips to the seat frame.

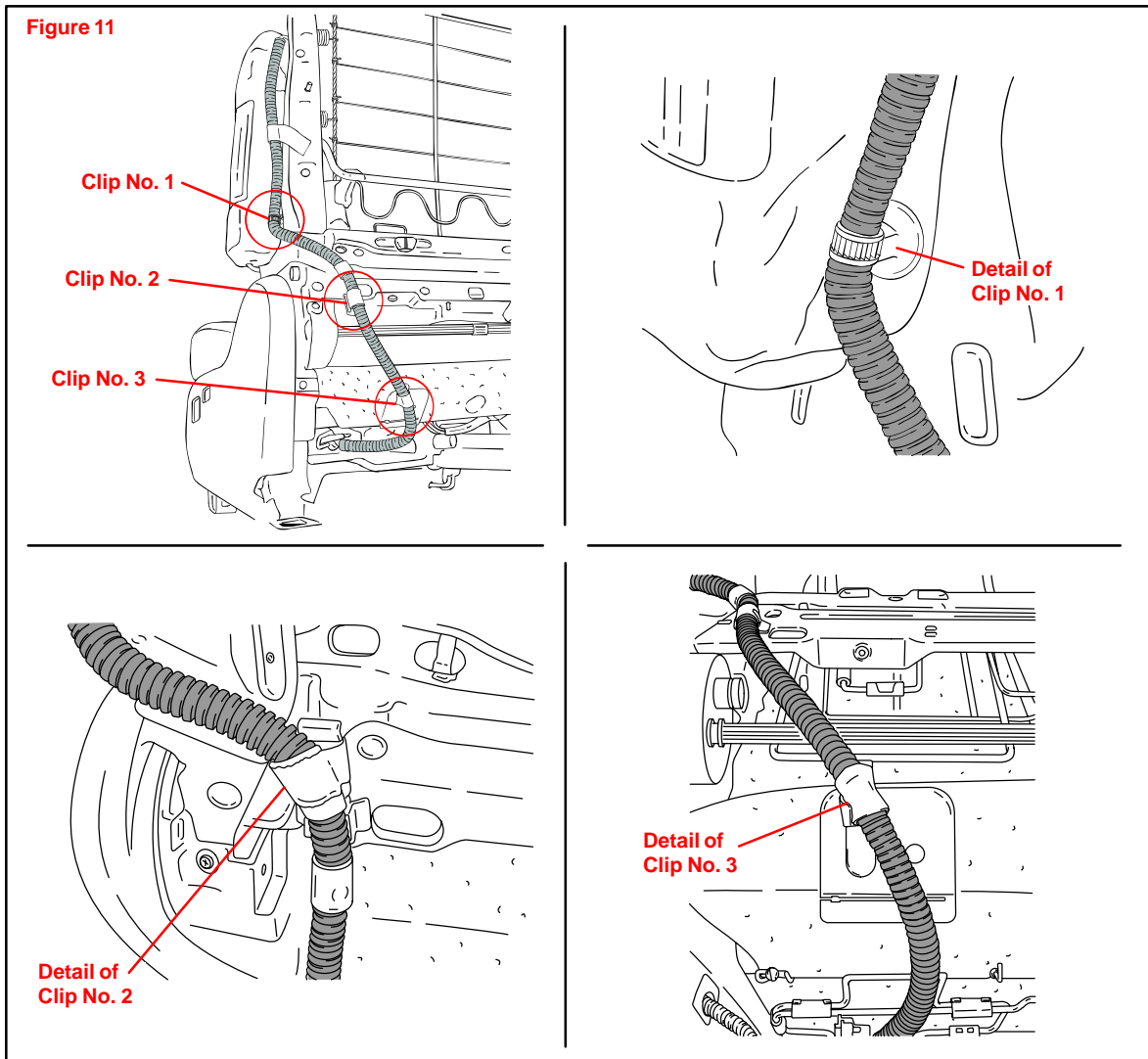

Repair Procedure
(Continued)

Figure 12

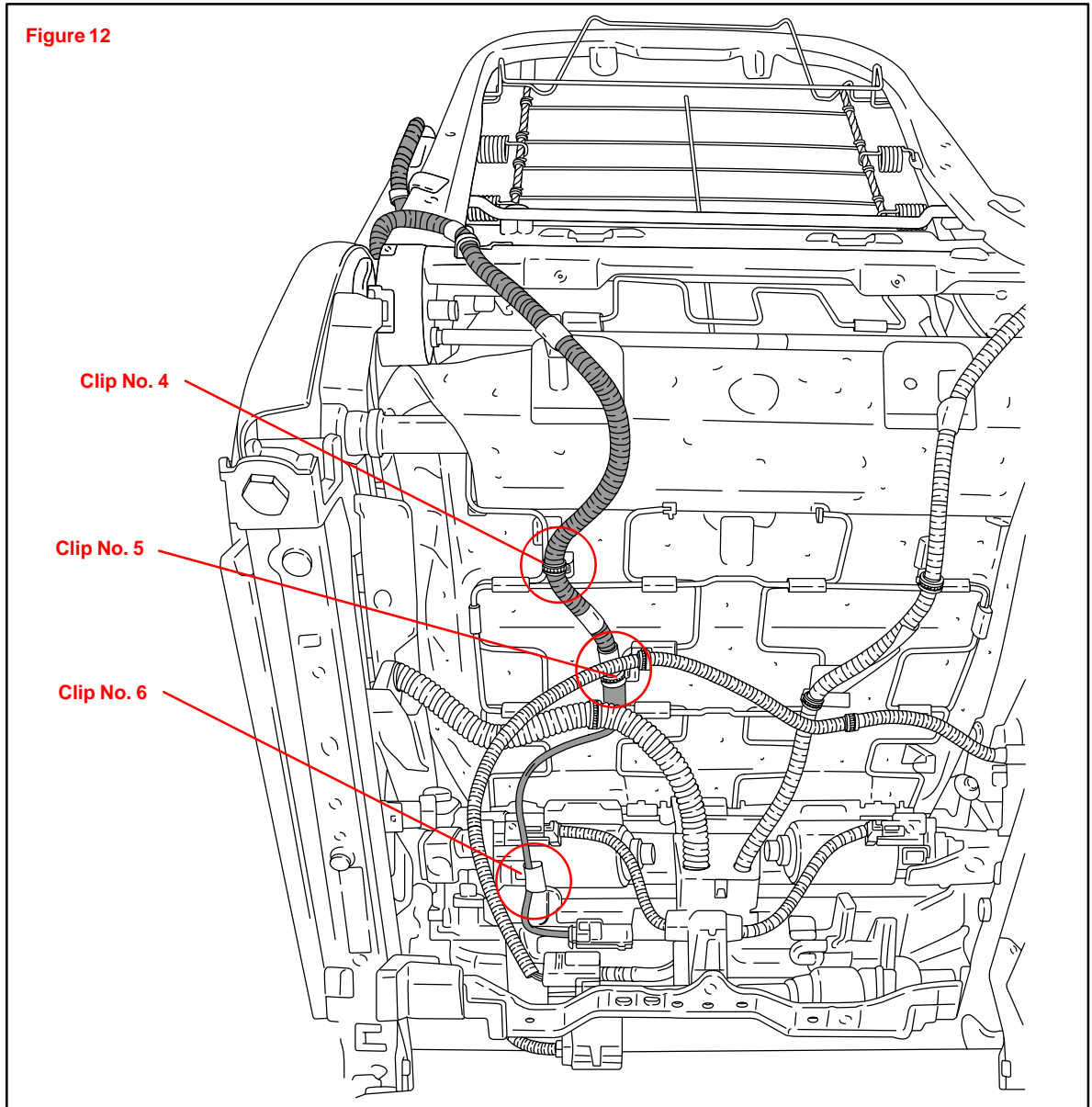
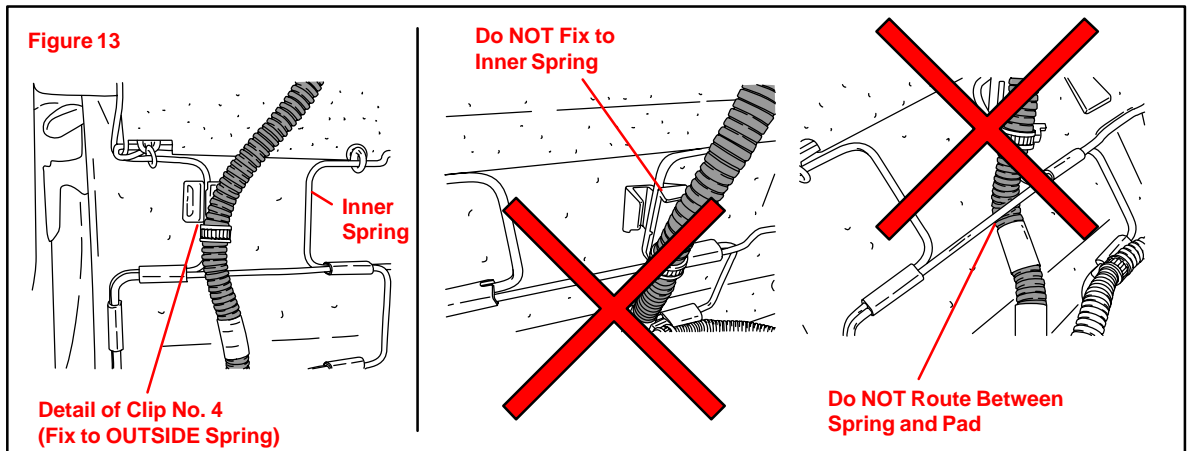
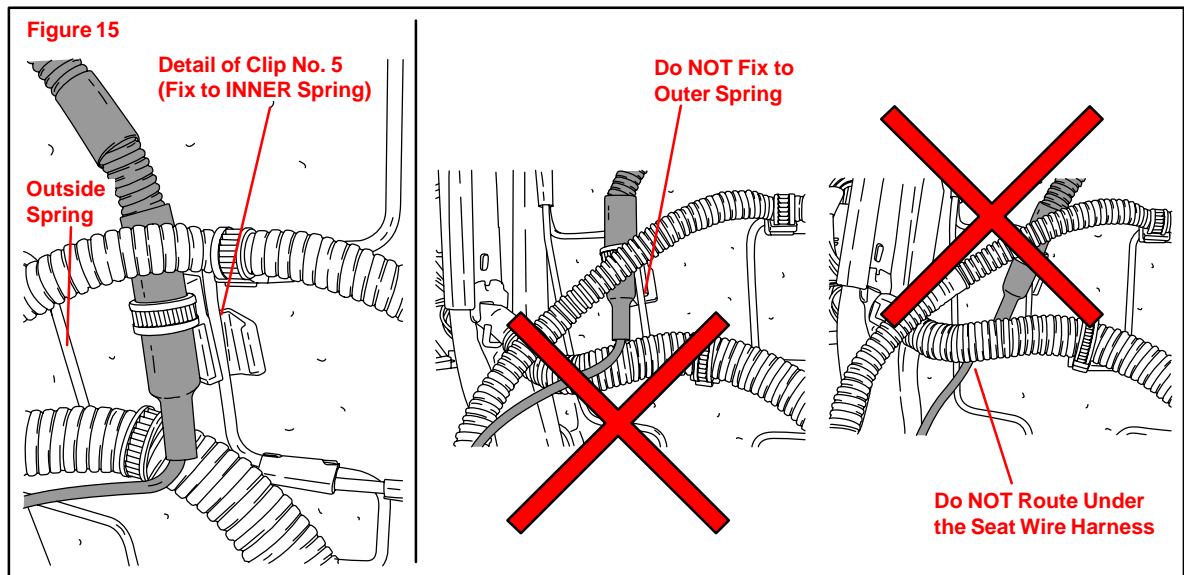
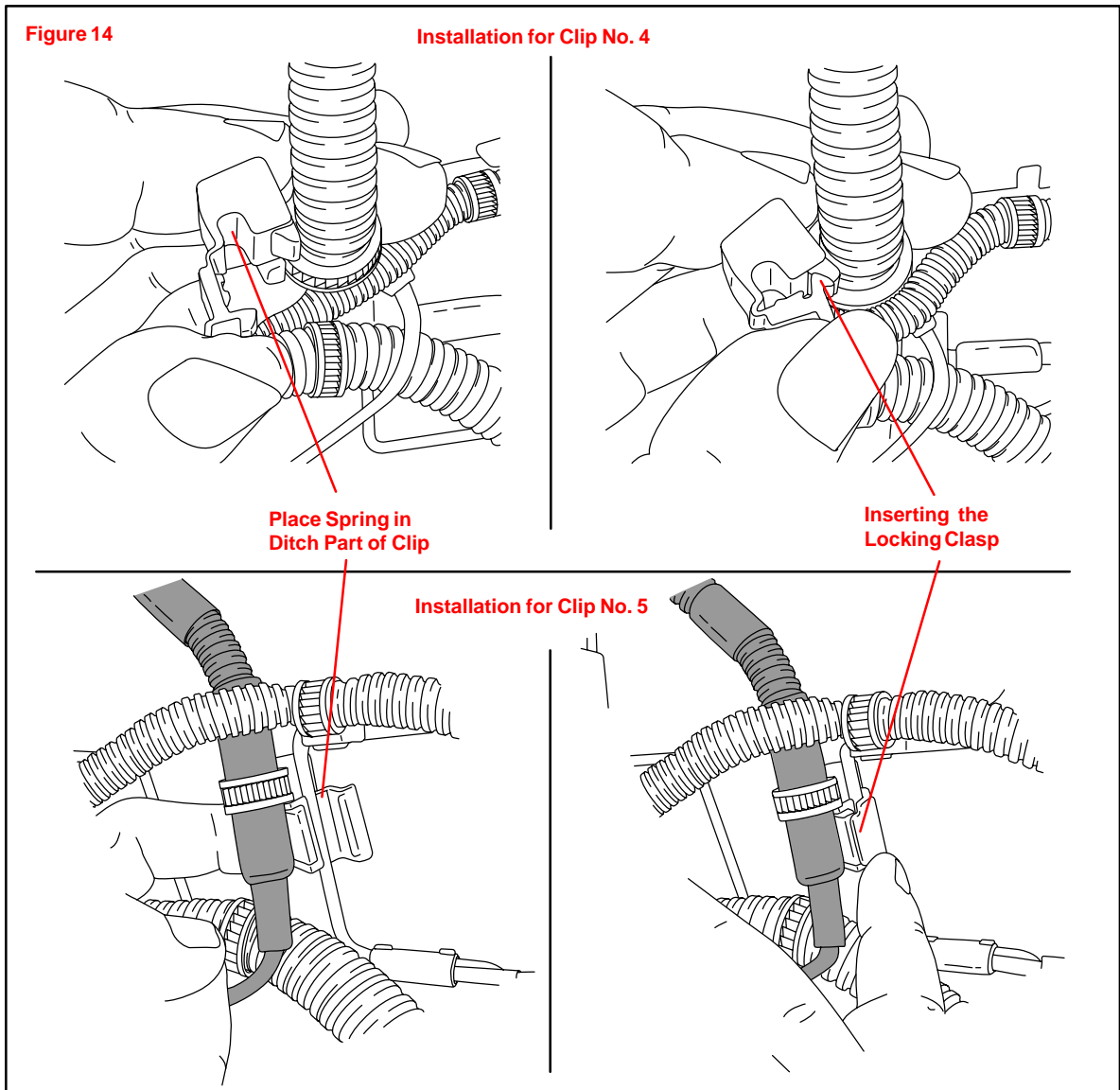

Figure 13



Repair Procedure
(Continued)



Repair Procedure
(Continued)

Figure 16

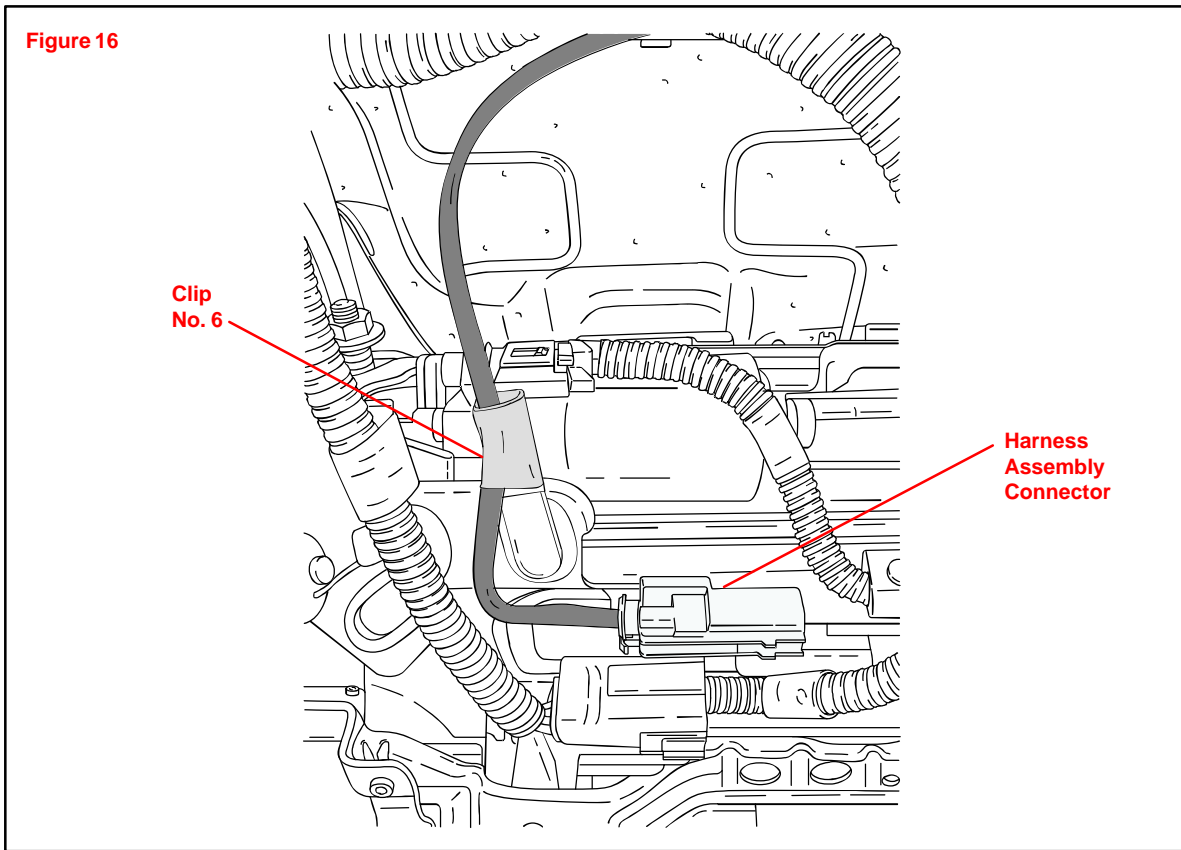
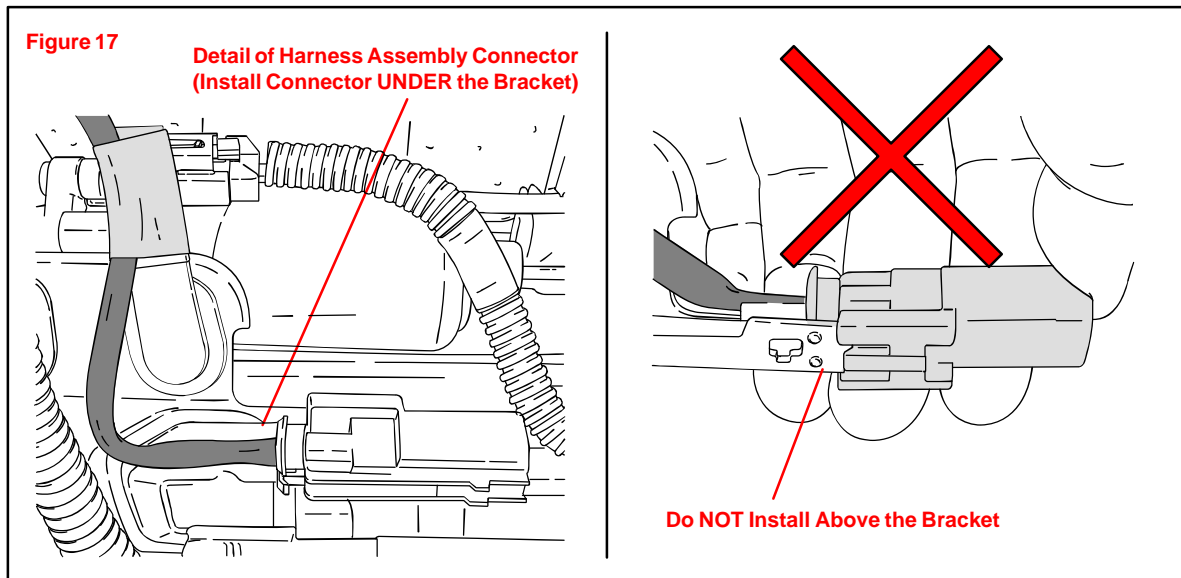

Figure 17



**Repair
Procedure**
(Continued)

17. Install the seatback pad and then the cover.
 - A. Place the inside strap on first and then the outside strap.
 - B. Install the seatback cover bracket with the nut.

Torque: 5.5 N•m (56 kgf•cm, 48 in•lbf)

18. Reconnect the seat heater connector and 2 harness clips.

NOTE:

- For vehicle with side airbag, the side airbag may NOT be activated normally unless the seatback cover is securely installed.
- After installing the bracket, check that the strap is NOT twisted.

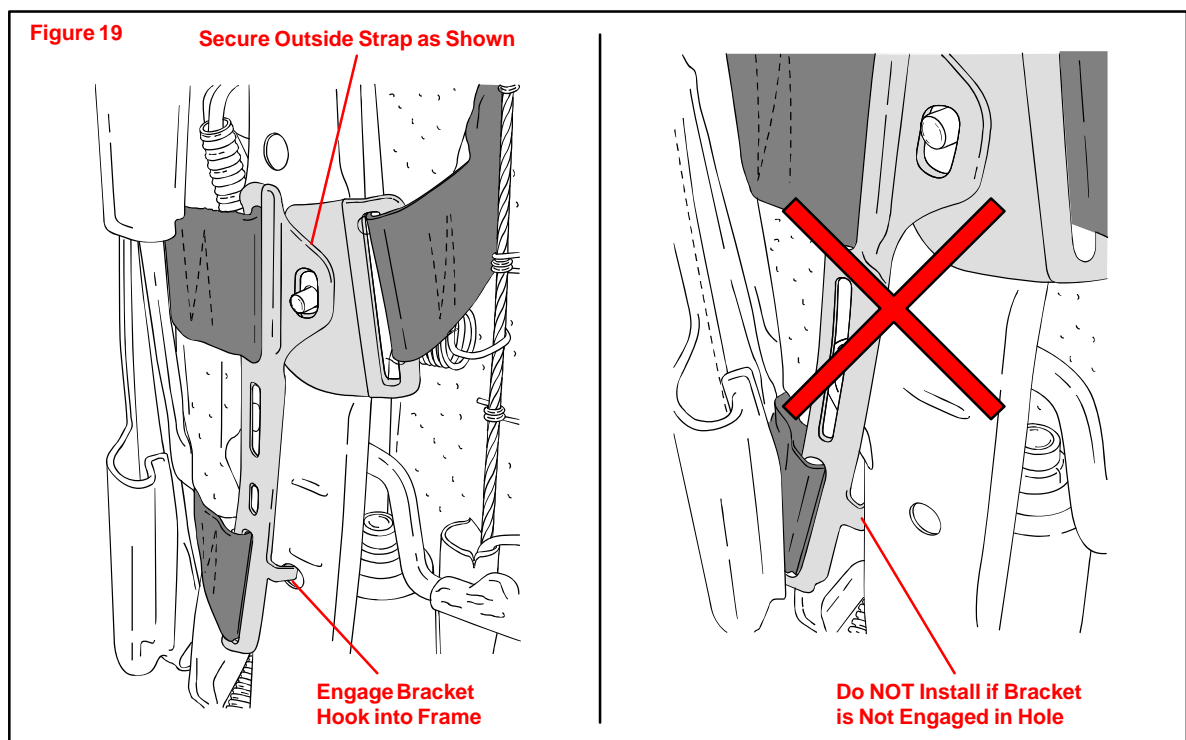
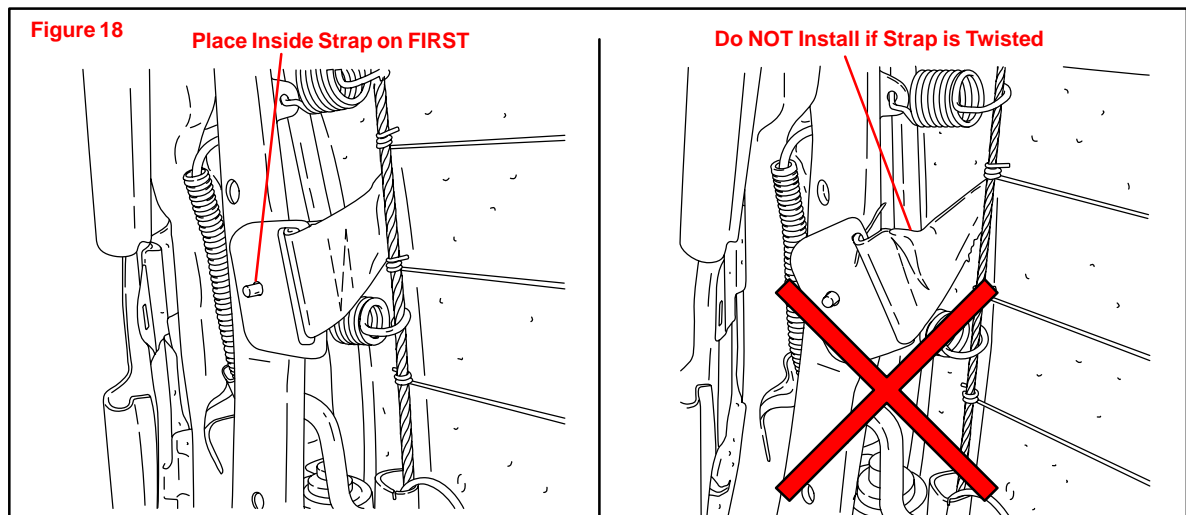

**Repair
Procedure**
(Continued)

19. Attach the seat cover by installing the seat cover hooks to the seat frame.

NOTE:

- Be careful NOT to damage the cover.
- Take care to minimize wrinkles as much as possible.

20. Install the armrest assembly.

A. Install the armrest with the bolt.

Torque: 20 N•m (200 kgf•cm, 14 ft•lbf)

B. Install the armrest cap.

21. Install the front seat assembly.

A. Place the seat assembly in the cabin.

NOTE:

Be careful NOT to damage the body.

B. Connect the connectors under the seat assembly.

C. Tighten the 2 bolts on the front side of the seat assembly.

Torque: 37 N•m (375 kgf•cm, 27 ft•lbf)

D. Tighten the 2 bolts on the rear side of the seat assembly.

Torque: 37 N•m (375 kgf•cm, 27 ft•lbf)

E. Install the 2 seat track covers.

22. Initialize the front passenger Occupant Classification System (OCS) (passenger seat only).

23. Check SRS warning lights.

24. Inspect power seat operation.

25. Check seat heater operation.

26. Initialize power systems (windows, moonroof, etc.). Refer to appropriate service bulletin.

NOTE:

Follow the initialization procedure in the Technical Information System (TIS): 2004 – 2008 model year RX 330, RX 350, or RX 400h Repair Manual, *Vehicle Interior – Supplemental Restraint System – “Initialization”*.

Airbag Disposal:

Please refer to TSIB No. SS005–07, “SRS Component Disposal as Hazardous Material Treatment”, for proper disposal method of the side airbag assembly.