

FRONT AXLE HUB COMPONENTS

SA07B-11

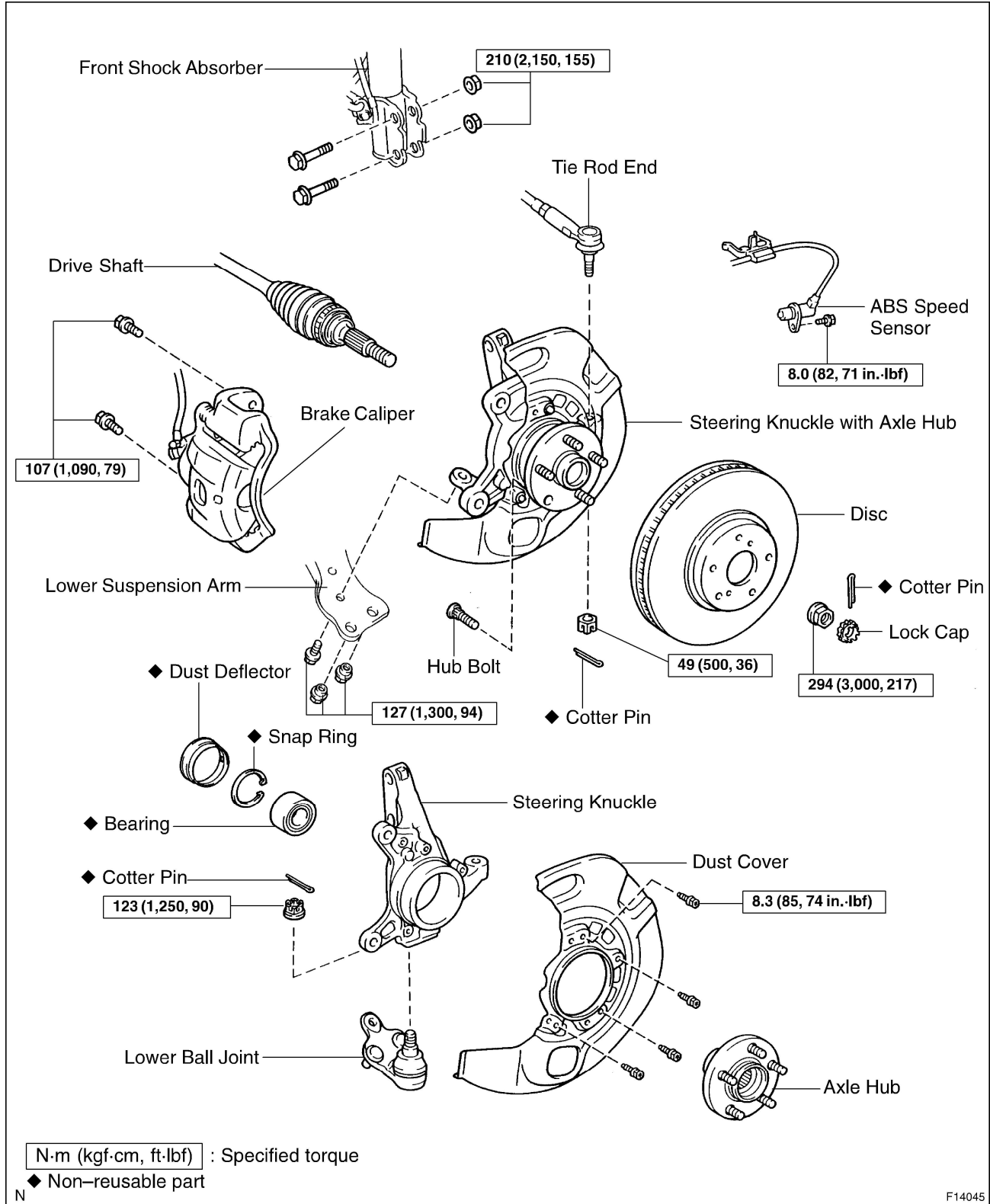

N

F14045

REMOVAL

1. REMOVE FRONT WHEEL

Torque: 103 N·m (1,050 kgf·cm, 76 ft·lbf)

2. CHECK BEARING BACKLASH AND AXLE HUB DEVIATION

- Remove the 2 bolts, brake caliper and disc.
- Support the brake caliper securely.

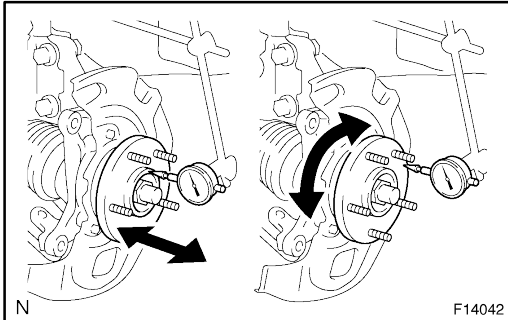

- Using a dial indicator, check the backlash near the center of the axle hub.

Maximum: 0.05 mm (0.0020 in.)

If the backlash exceeds the maximum, replace the bearing.

- Using a dial indicator, check the deviation at the surface of the axle hub outside the hub bolt.

Maximum: 0.05 mm (0.0020 in.)

If the deviation exceeds the maximum, replace the bearing.

- Install the disc, brake caliper and 2 bolts.

Torque: 107 N·m (1,090 kgf·cm, 79 ft·lbf)

3. REMOVE DRIVE SHAFT LOCK NUT

- Remove the cotter pin and lock cap.
- While applying the brakes, remove the nut.
- Remove the 2 bolts, brake caliper and disc.
- Support the brake caliper securely.

Torque: 107 N·m (1,090 kgf·cm, 79 ft·lbf)

4. REMOVE ABS SPEED SENSOR AND WIRE HARNESS CLAMP

Torque: 8.0 N·m (82 kgf·cm, 71 in·lbf)

5. LOOSEN 2 NUTS ON LOWER SIDE OF SHOCK ABSORBER

Torque: 210 N·m (2,150 kgf·cm, 155 ft·lbf)

HINT:

Do not remove the nuts and bolts.

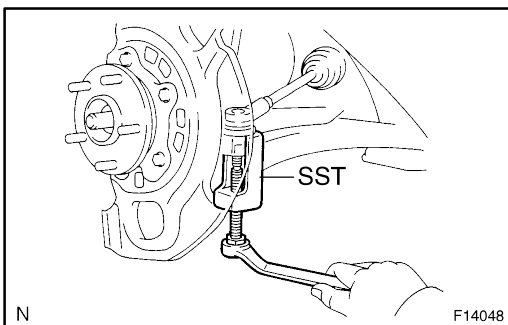
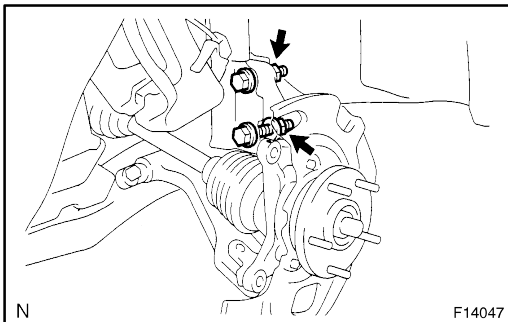
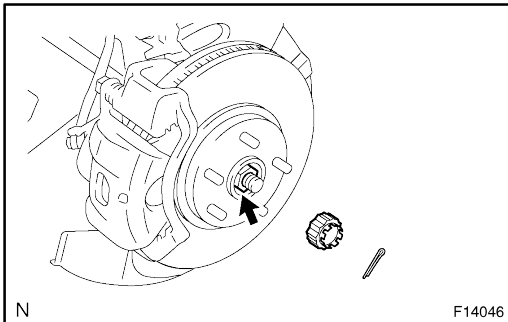

6. DISCONNECT TIE ROD END FROM STEERING KNUCKLE

- Remove the cotter pin and nut.
- Using SST, disconnect the tie rod end from the steering knuckle.

SST 09610-20012

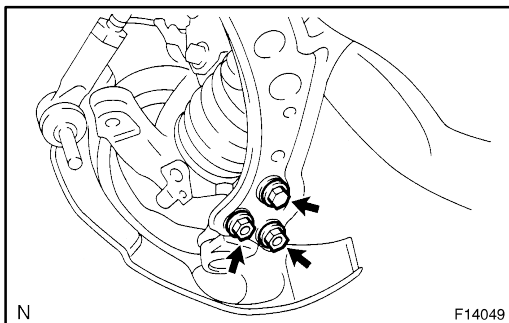

7. DISCONNECT LOWER BALL JOINT FROM LOWER SUSPENSION ARM

Remove the 2 nuts and bolt.

Torque: 127 N·m (1,300 kgf·cm, 94 ft·lbf)

8. REMOVE STEERING KNUCKLE WITH AXLE HUB

- (a) Remove the 2 bolts and nuts on the lower side of the shock absorber.

HINT:

At the time of installation, coat the nut's threads with engine oil.

- (b) Remove the steering knuckle with the axle hub.

NOTICE:

Be careful not to damage the boot and ABS speed sensor rotor.

DISASSEMBLY

1. REMOVE DUST DEFLECTOR

Using a screwdriver, remove the dust deflector.

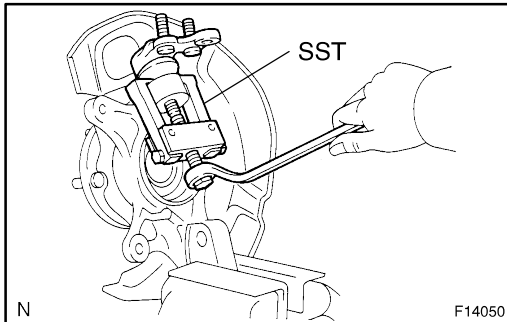

2. REMOVE LOWER BALL JOINT

- (a) Remove the cotter pin and nut.
- (b) Using SST, remove the lower ball joint.
SST 09628-62011

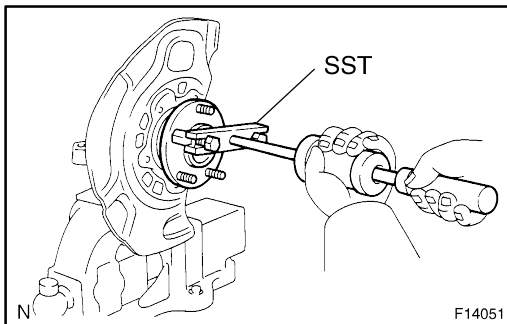

3. REMOVE AXLE HUB

- (a) Using SST, remove the axle hub.
SST 09520-00031

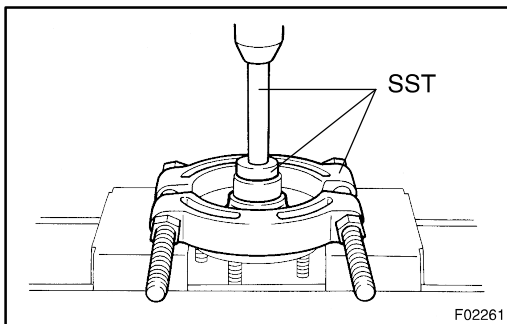

- (b) Using SST and a press, remove the inner race (outside) from the axle hub.
SST 09950-00020, 09950-60010 (09951-00400),
09950-70010 (09951-07100)

4. REMOVE DUST COVER

Using a torx wrench (T30), remove the 4 bolts and dust cover.

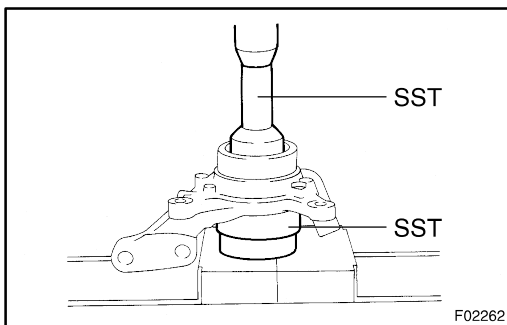

5. REMOVE BEARING FROM STEERING KNUCKLE

- (a) Using snap ring pliers, remove the snap ring.
- (b) Place the inner race on the outside of the bearing.
- (c) Using SST and a press, remove the bearing.
SST 09310-35010, 09527-17011

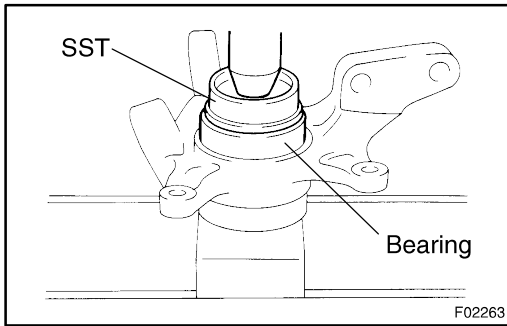

REASSEMBLY

1. INSTALL BEARING

- (a) Using SST and a press, install a new bearing to the steering knuckle.

SST 09608-32010

- (b) Using snap ring pliers, install a new snap ring.

2. INSTALL DUST COVER

Using a torx wrench (T30), install the dust cover with 4 bolts.

Torque: 8.3 N·m (85 kgf·cm, 74 in.-lbf)

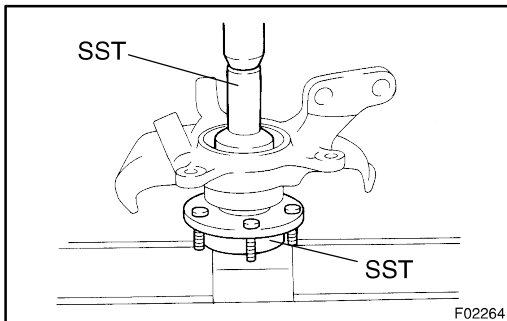

3. INSTALL FRONT AXLE HUB

Using SST and a press, install the axle hub.

SST 09310-35010, 09608-32010

4. INSTALL LOWER BALL JOINT

- (a) Install the lower ball joint and tighten the nut.

Torque: 123 N·m (1,250 kgf·cm, 90 ft·lbf)

- (b) Install a new cotter pin.

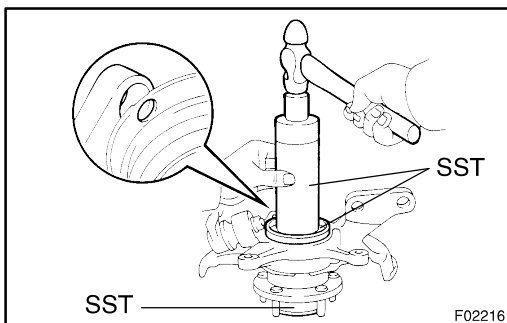

5. INSTALL DUST DEFLECTOR

Using SST and a hammer, install a new dust deflector.

SST 09316-60011 (09316-00011, 09316-00041),
09608-32010

HINT:

Align the hole for the ABS speed sensor in the dust deflector with the hole in steering knuckle.

INSTALLATION

Installation is in the reverse order of removal (See page SA-10).

HINT:

After installation, check the ABS speed sensor signal (See page DI-205) and front wheel alignment (See page SA-4).