

CIGARETTE LIGHTER ASSY REPLACEMENT

670U3-01

HINT:

LOCATION: See page 67-1

1. REMOVE SHIFT LEVER KNOB SUB-ASSY (See page 40-38)
2. REMOVE CONSOLE PANEL UPPER FRONT (See page 71-10)
3. REMOVE INSTRUMENT PANEL FINISH PANEL LOWER (See page 71-10)

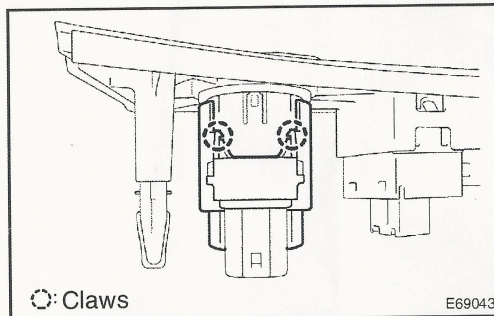

4. REMOVE CIGARETTE LIGHTER COVER

- (a) Disengage the 2 claws, and remove the cigarette lighter cover.

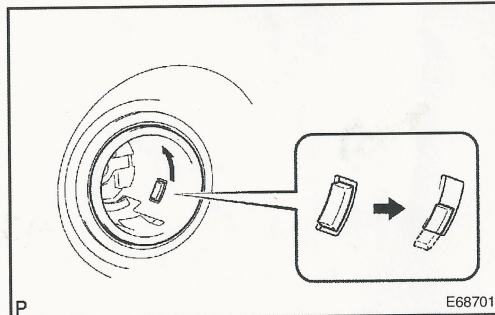

5. REMOVE CIGARETTE LIGHTER ASSY

- (a) Remove the cigarette lighter knob and element assy.
- (b) Turn the socket in counterclockwise as shown in the illustration.
- (c) Disengage the claw between the socket and the cigarette lighter bezel stay, and push out the socket.
- (d) Align the socket with the notch on the cigarette lighter bezel stay, and remove the cigarette lighter assy.

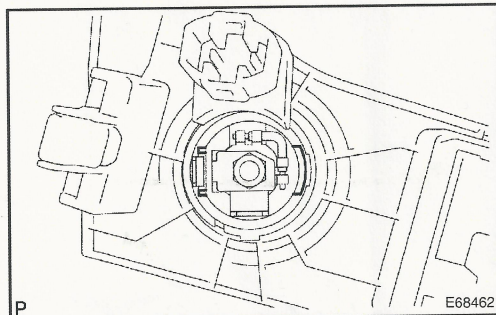

6. INSTALL CIGARETTE LIGHTER ASSY

- (a) Align the socket with the notch on the cigarette lighter bezel stay, push in the cigarette lighter assy as hard as possible to install it.
- (b) Install the cigarette lighter knob and element assy.