

## 1. REMOVE INSTRUMENT PANEL FINISH PANEL END LH

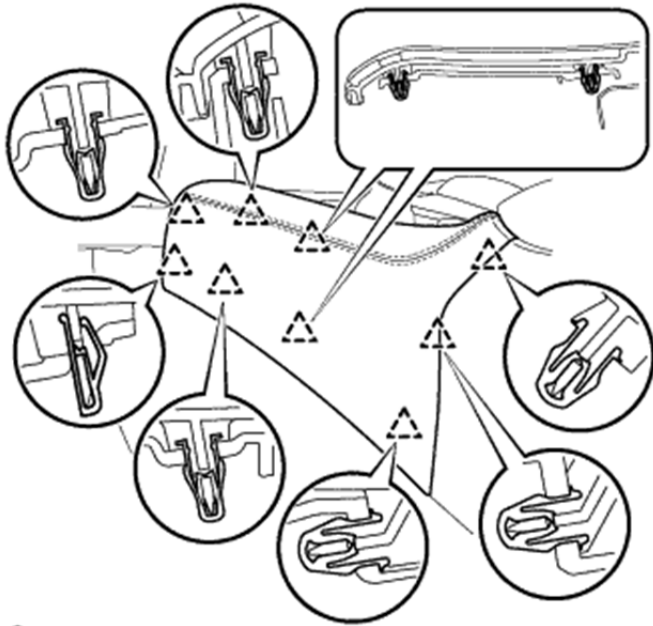

0

- a. Pull the front part of the instrument panel finish panel end LH to detach the 6 clips.
- b. Pull the instrument panel finish panel end LH to detach 3 clips and remove the instrument panel finish panel end LH.

## 2. REMOVE INSTRUMENT PANEL FINISH PANEL END RH

**HINT:**

Use the same procedure described for the LH side.

## 3. REMOVE SHIFT LEVER KNOB SUB-ASSEMBLY

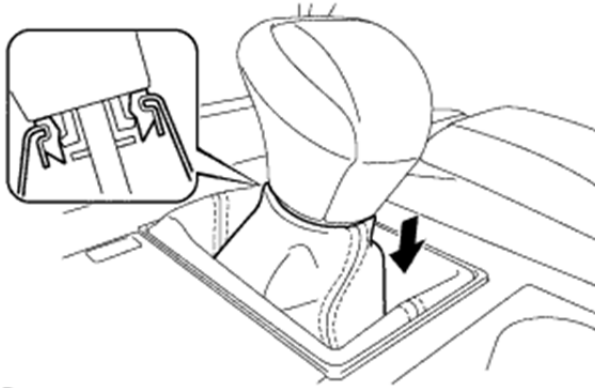

0

- a. Lower the shift lever boot and disconnect it from the shift lever knob sub-assembly.

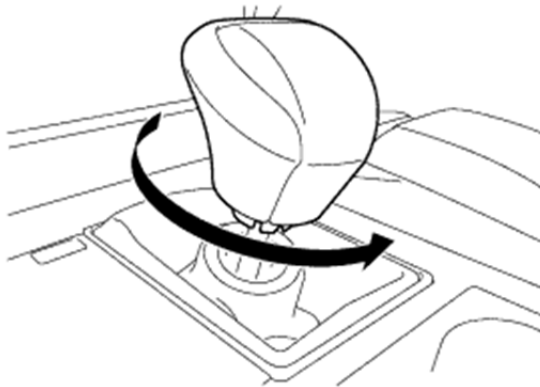

0

- b. Twist the shift lever knob sub-assembly in the direction indicated by the arrow and remove it.

**4. REMOVE NO. 3 BOX PANEL**

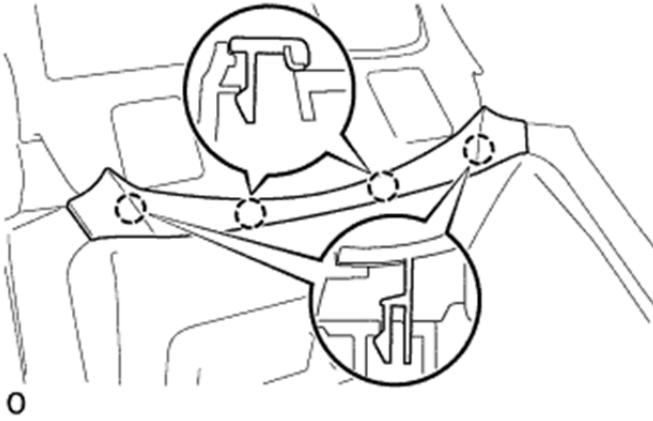

- a. Detach the 4 claws and remove the No. 3 box panel.

**5. REMOVE UPPER REAR CONSOLE PANEL SUB-ASSEMBLY**

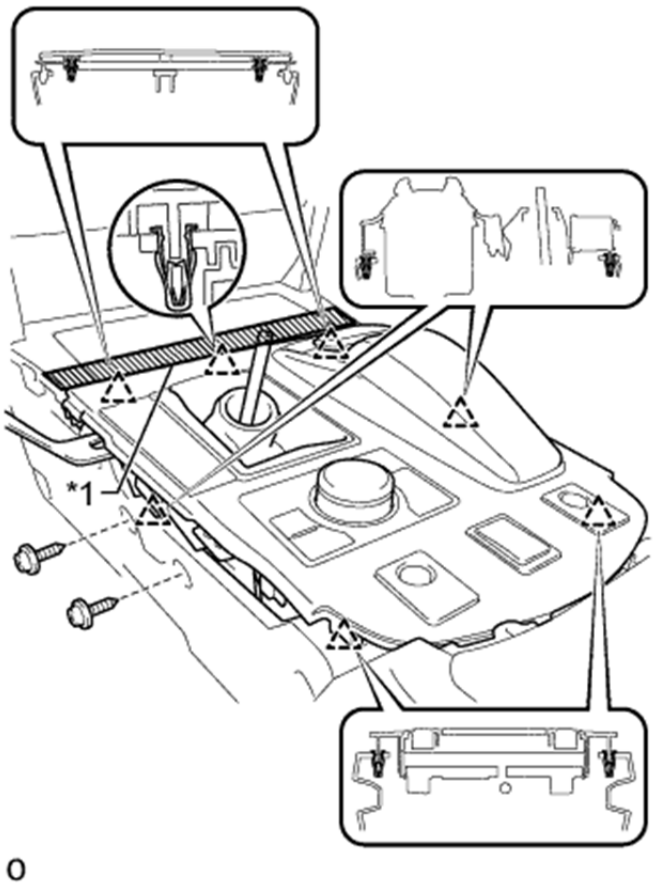

- a. Apply protective tape as shown in the illustration.

<b>Text in Illustration</b>	
*1	Protective Tape

- b. Move the shift lever to N.
- c. Remove the 2 screws.
- d. Detach the 6 clips and remove the upper rear console panel sub-assembly.
- e. Disconnect each connector and each wire harness clamp.

## 6. REMOVE UPPER INSTRUMENT CLUSTER FINISH PANEL

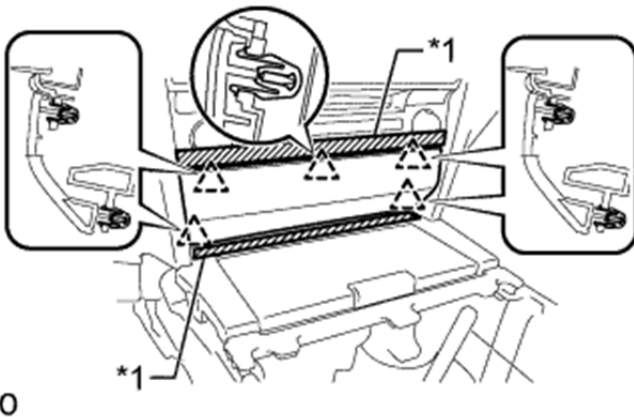

- a. Apply protective tape as shown in the illustration.

<b>Text in Illustration</b>	
*1	Protective Tape

- b. Detach the 5 clips and remove the upper instrument cluster finish panel.

## 7. REMOVE UPPER CONSOLE PANEL SUB-ASSEMBLY

- a. Disconnect the connector.

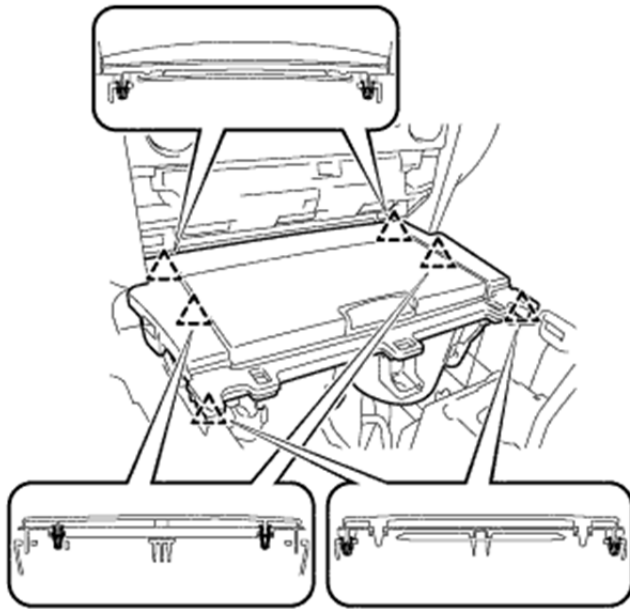

0

- b. Detach the 6 clips and remove the upper console panel sub-assembly.

**8. REMOVE LOWER NO. 1 INSTRUMENT PANEL FINISH PANEL**

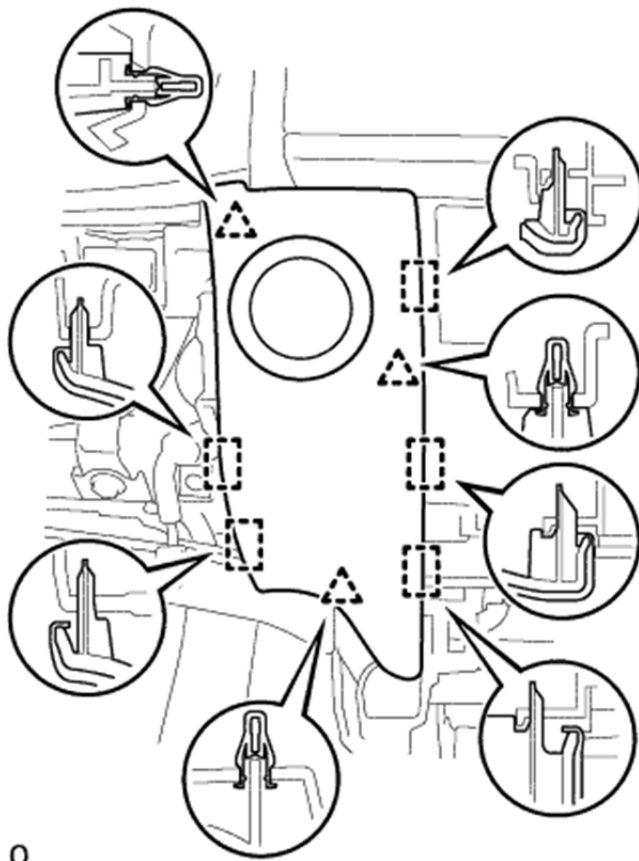

0

- a. Detach the 4 clips and 5 guides and remove the lower No. 1 instrument panel finish panel.
- b. Disconnect the connector.

## 9. REMOVE ENGINE SWITCH

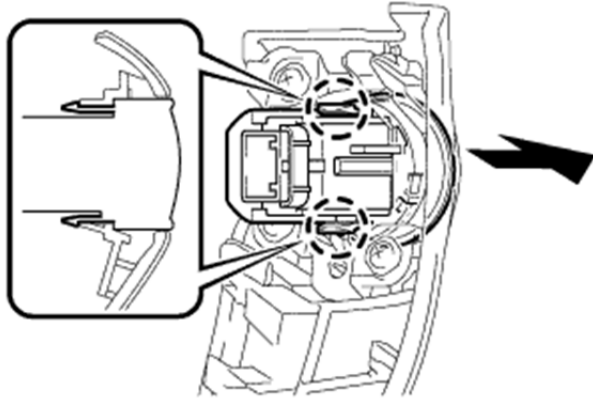

P

- a. Detach the 2 claws and remove the engine switch.