

Last Modified: 8-16-2012	6.4 A	From: 200708
Model Year: 2008	Model: LS460	Doc ID: RM000000SKC016X
Title: 1UR-FSE IGNITION: IGNITION COIL AND SPARK PLUG: REMOVAL (2008 LS460)		

REMOVAL

1. REMOVE COWL TOP VENTILATOR LOUVER RH INFO
2. DISCONNECT CABLE FROM NEGATIVE BATTERY TERMINAL

CAUTION:

Wait at least 90 seconds after disconnecting the cable from the negative (-) battery terminal to prevent airbag and seat belt pretensioner activation.

NOTICE:

After the engine switch is turned off, the HDD navigation system requires approximately 6 minutes to record various types of memory and settings. As a result, after turning the engine switch off, wait 6 minutes or more before disconnecting the cable from the negative (-) battery terminal.

3. REMOVE V-BANK COVER SUB-ASSEMBLY

- (a) While using both hands, lift the rear side of the cover upwards to detach the 4 clips B. Slide the cover towards the front of the vehicle to detach the 2 clips labeled A, and remove the V-bank cover.

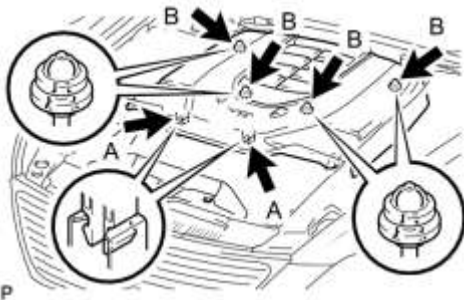

NOTICE:

The V-bank cover may be damaged if its front and rear are lifted at the same time.

4. REMOVE AIR CLEANER INLET COVER

- (a) Remove the 5 clips A.
- (b) Lift up the air cleaner inlet cover to detach the 4 clips B, and remove the cover.

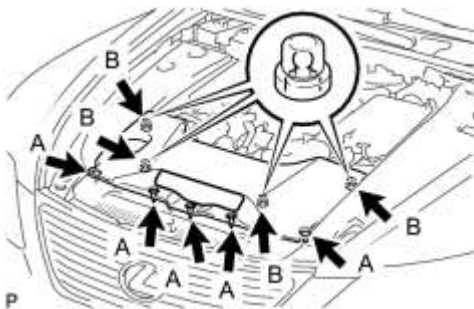

5. REMOVE NO. 1 AIR CLEANER INLET

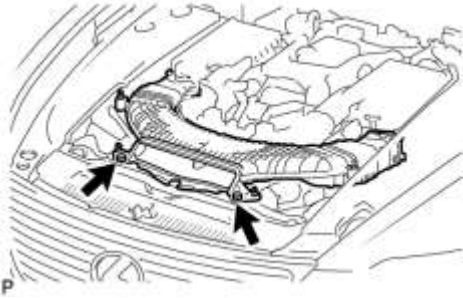

(a) Remove the 2 bolts.

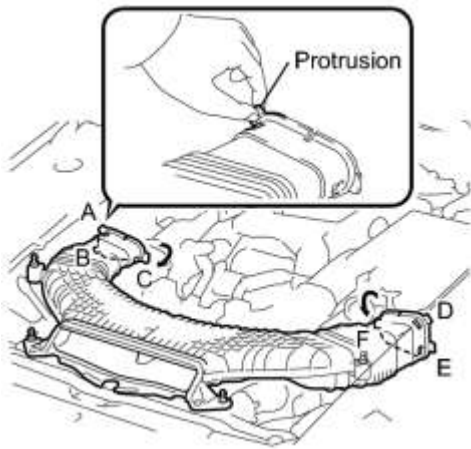

(b) Hold the air cleaner inlet by the protrusions A and B, and detach the connections.

(c) Rotate the No. 1 air cleaner inlet as shown in the illustration to detach the protrusion C.

(d) Hold the air cleaner inlet by the protrusions D and E, and detach the connections.

(e) Rotate the No. 1 air cleaner inlet as shown in the illustration to detach the protrusion F.

5. REMOVE ENGINE ROOM SIDE COVER LH

Remove the 4 clips and engine room side cover.

6. REMOVE ENGINE ROOM SIDE COVER RH

Remove the 4 clips and engine room side cover.

7. REMOVE NO. 1 AIR CLEANER INLET

8. REMOVE SKID CONTROL ECU INFO

9. REMOVE SKID CONTROL ECU BRACKET INFO

10. REMOVE BATTERY

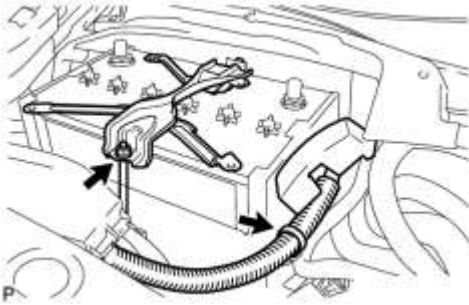

(a) Disconnect the positive (+) battery cable from the battery terminal.

(b) Disconnect the battery cable clamp.

(c) Remove the nut, battery clamp and No. 2 battery clamp bolt.

(d) Remove the battery insulator.

(e) Remove the battery.

11. REMOVE BATTERY TRAY

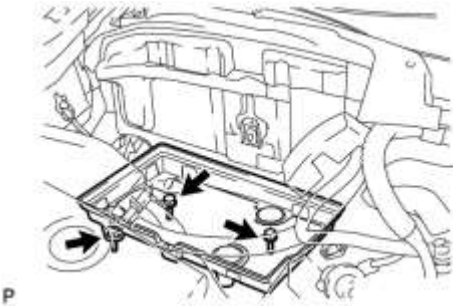

(a) Remove the 3 bolts and battery tray.

12. REMOVE AIR CLEANER ASSEMBLY LH INFO

13. REMOVE AIR CLEANER ASSEMBLY RH INFO

14. REMOVE IGNITION COIL ASSEMBLY

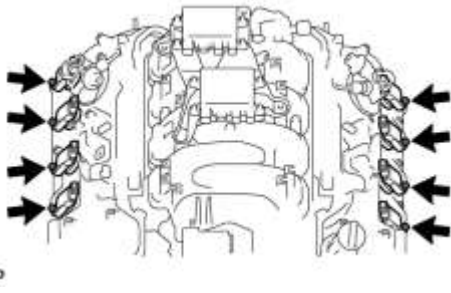

(a) Disconnect the 8 ignition coil connectors.

(b) Remove the 8 bolts.

(c) Using a screwdriver, pry at the cutouts to remove the 8 ignition coils together with the 8 spark plug tube gaskets.

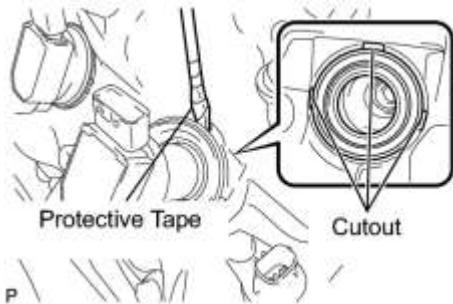

NOTICE:

Do not damage the cylinder head cover when removing the spark plug tube gasket.

HINT:

Tape the screwdriver tip before use.

15. REMOVE SPARK PLUG

(a) Using a 16 mm plug wrench, remove the 8 spark plugs.