

## FRONT BUMPER



### COMPONENTS

**Fig. 1: Removing And Installing Of Front Bumper (1 Of 2)**  
Courtesy of TOYOTA MOTOR SALES, U.S.A., INC.

**Fig. 2: Removing And Installing Of Front Bumper Components (2 Of 2)**  
Courtesy of TOYOTA MOTOR SALES, U.S.A., INC.

### REPLACEMENT

HINT:

- The installation procedures are the removal procedures in reverse order. However, only installation procedures requiring additional information are included.
- A bolt without a torque specification is shown in the standard bolt chart (see **SPECIFIED TORQUE FOR STANDARD BOLTS** ).

#### 1. REMOVE FRONT FENDER LINER LH

- a. Remove the 2 screws and 2 clips.
- b. Partially remove the fender liner.

HINT:

It is not necessary to fully remove the fender liner completely. Partially remove it so that the bumper cover can be removed in step 5.

**Fig. 3: Removing Front Fender Liner LH**  
Courtesy of TOYOTA MOTOR SALES, U.S.A., INC.

#### 2. REMOVE FRONT FENDER LINER RH

HINT:

Use the same procedure described for the LH side.

#### 3. REMOVE RADIATOR SIDE DEFLECTOR LH

- a. Remove the 3 clips and deflector.

4. REMOVE RADIATOR SIDE DEFLECTOR RH

- a. Remove the 3 clips and deflector.



5. REMOVE FRONT BUMPER COVER

- a. Remove the 4 nuts.

**Fig. 4: Removing Front Bumper Cover Nuts**

Courtesy of TOYOTA MOTOR SALES, U.S.A., INC.

- b. Remove the 3 clips and 7 screws.
- c. Using a screwdriver, disengage the 2 claws and remove the bumper cover.
- d. Disconnect the 2 fog lamp connectors.
- e. w/ Clearance sonar system:

Disconnect the 6 sensor connectors.

**Fig. 5: Removing Front Bumper Cover**

Courtesy of TOYOTA MOTOR SALES, U.S.A., INC.

6. REMOVE HEADLAMP CLEANER (FROM MOTOR TO JOINT) HOSE (W/ HEADLAMP CLEANER)

- a. Disconnect the cleaner hose joint from the actuator.

HINT:

Be careful when removing the cleaner hose from the actuator, because washer fluid will spill.

- b. Disconnect the cleaner hose from the bumper cover.

7. REMOVE FRONT BUMPER ENERGY ABSORBER

8. REMOVE RADIATOR SUPPORT REINFORCEMENT LOWER

- a. Remove the 2 bolts.
- b. Unlock the 2 claws and partially remove the reinforcement lower by angling it towards yourself.

HINT:

It is not necessary to fully remove the reinforcement lower completely. Partially remove it so that the bumper reinforcement can be removed in step (9).

**Fig. 6: Removing Radiator Support Reinforcement Lower**

Courtesy of TOYOTA MOTOR SALES, U.S.A., INC.

9. **REMOVE FRONT BUMPER REINFORCEMENT SUB-ASSY**

- a. Remove the 6 bolts and reinforcement.

10. **REMOVE LASER SENSOR (W/ RADAR CRUISE)**

11. **REMOVE FOG LAMP ASSY LH**

- a. Using a screwdriver, disengage the 2 claws and remove the fog lamp.

HINT:

Tape the screwdriver tip before use.

**Fig. 7: Removing Fog Lamp Assy LH**  
Courtesy of TOYOTA MOTOR SALES, U.S.A., INC.

12. **REMOVE FOG LAMP ASSY RH**

HINT:

Use the same procedures described for the LH side.

13. **REMOVE HEADLAMP CLEANER WASHER NOZZLE (W/ HEADLAMP CLEANER)**

- a. Using a screwdriver, pull out the 2 washer nozzles.

HINT:

Tape the screwdriver tip before use.

**Fig. 8: Removing Headlamp Cleaner Washer Nozzle (W/Headlamp Cleaner)**  
Courtesy of TOYOTA MOTOR SALES, U.S.A., INC.

14. **REMOVE HEADLAMP WASHER ACTUATOR SUB-ASSY LH (W/ HEADLAMP CLEANER)**

- a. Remove the screw and actuator.

15. **REMOVE HEADLAMP WASHER ACTUATOR SUB-ASSY RH (W/ HEADLAMP CLEANER)**

- a. Remove the screw and actuator.

16. **REMOVE ULTRASONIC SENSOR NO. 1 (w/ CLEARANCE SONAR SYSTEM)**

- a. Using a screwdriver, remove the retainer and sensor.

HINT:

Tape the screwdriver tip before use.

17. REMOVE FRONT BUMPER EXTENSION MOUNTING BRACKET

- a. Remove the 2 screws and mounting bracket.



18. REMOVE FRONT BUMPER SIDE RETAINER LH

- a. Use a drill that has a tip of less than plus 4 mm (0.16 in.).  
b. Tape the drill tip as shown in Fig. 9 .

**Dimension: 5 mm (0.20 in.)**

**Fig. 9: Taping Drill Tip**

Courtesy of TOYOTA MOTOR SALES, U.S.A., INC.

HINT:

Taping the drill tip is done to prevent excessive drilling.

- c. Gently place the drill tip onto the rivet, cut the rivet flanges and then remove the rivet.

**NOTE:**

- **Pressing the drill tip onto the rivet strongly will cause the rivet to turn with the drill and the rivet will not be cut.**
- **Do not prize the rivet hole with the drill. Doing so may damage the rivet hole and/or the drill.**
- **Be careful as the cut rivet will be very hot.**

- d. Remove the retainer from the bumper cover.

19. REMOVE FRONT BUMPER SIDE RETAINER RH

HINT:

Use the same procedures described for the LH side.

20. REMOVE FRONT BUMPER MOLDING

HINT:

Remove the double-sided tape completely from the bumper. Double-sided tape interferes with the installation of the molding to the bumper.



21. REMOVE FRONT BUMPER SIDE SEAL LH

- a. Using a screwdriver, disengage the 4 claws and remove the side seal.

HINT:

Tape the screwdriver tip before use.

22. REMOVE FRONT BUMPER SIDE SEAL RH (W/O RADAR CRUISE)

HINT:

Use the same procedures described for the LH side.

23. REMOVE FRONT BUMPER HOLE COVER LH

- a. Using a screwdriver, disengage the 2 claws and remove the hole cover.

HINT:

Tape the screwdriver tip before use.

24. REMOVE FRONT BUMPER HOLE COVER RH (W/ RADAR CRUISE)

- a. Using a screwdriver, disengage the 4 claws and remove the hole cover.

HINT:

Tape the screwdriver tip before use.

25. INSTALL FRONT BUMPER REINFORCEMENT SUB-ASSY

- a. Install the reinforcement with the 6 bolts.

**Torque: 12.5 N.m (130 kgf.cm, 9 ft.lbf)**

26. INSTALL FRONT BUMPER SIDE RETAINER LH

- a. Using an air riveter or hand riveter with nose piece, strike waterproof rivets of this 4.9 mm (0.19 in.) into the side retainer to install the rivet to the bumper cover.

**NOTE:** If the rivet is not positioned perpendicularly to the bumper, the mandrel will bend and become damaged.

**Fig. 10: Installing Front Bumper Side Retainer LH**  
Courtesy of TOYOTA MOTOR SALES, U.S.A., INC.

27. INSTALL FRONT BUMPER SIDE RETAINER RH

HINT:

Use the same procedures described for the LH side.

## 2005 Lexus LS 430

### Fig. 1: Removing And Installing Of Front Bumper (1 Of 2)

Courtesy of TOYOTA MOTOR SALES, U.S.A., INC.

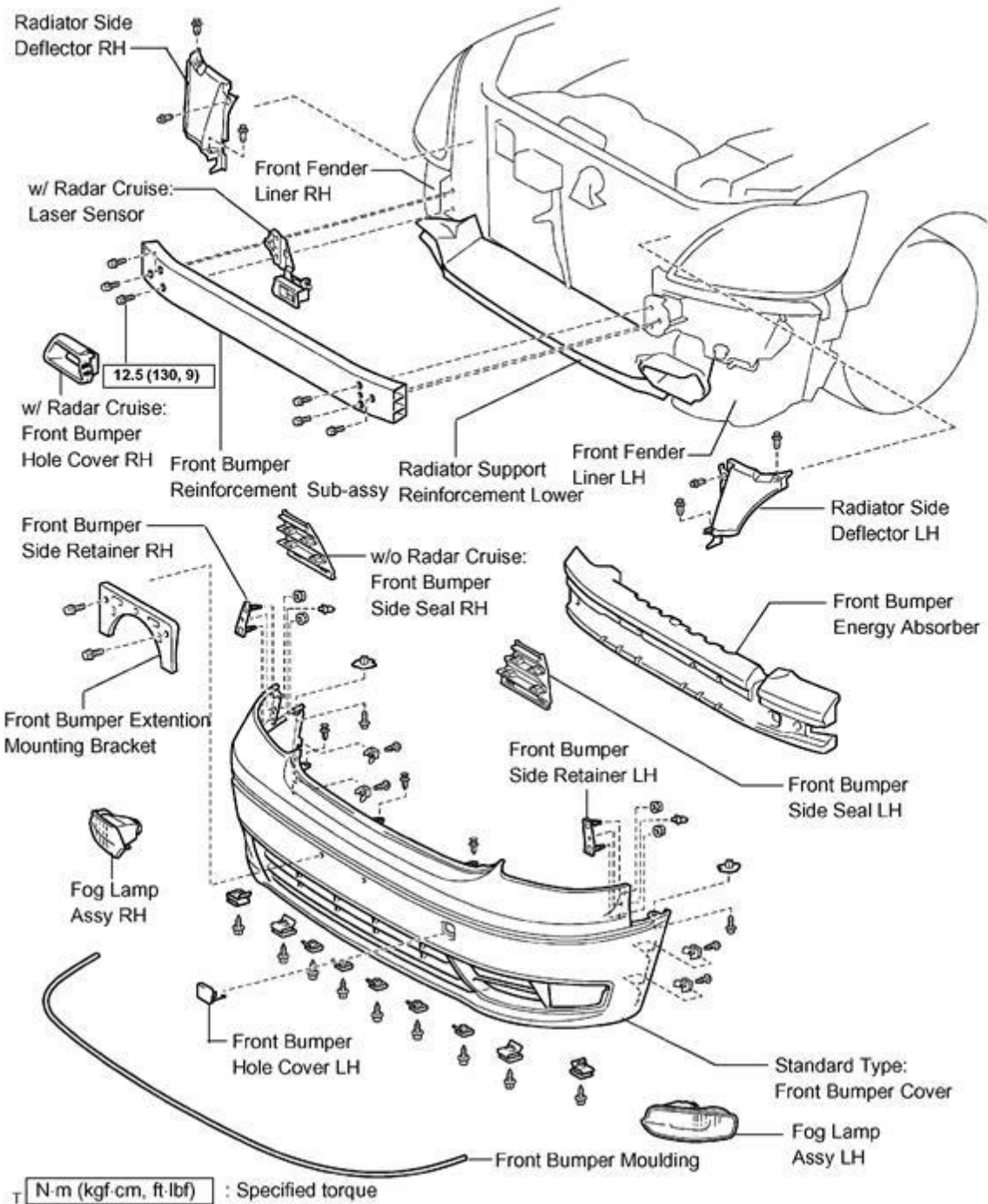

2005 Lexus LS 430

Fig. 2: Removing And Installing Of Front Bumper Components (2 Of 2)

Courtesy of TOYOTA MOTOR SALES, U.S.A., INC.

w/ Headlamp Cleaner

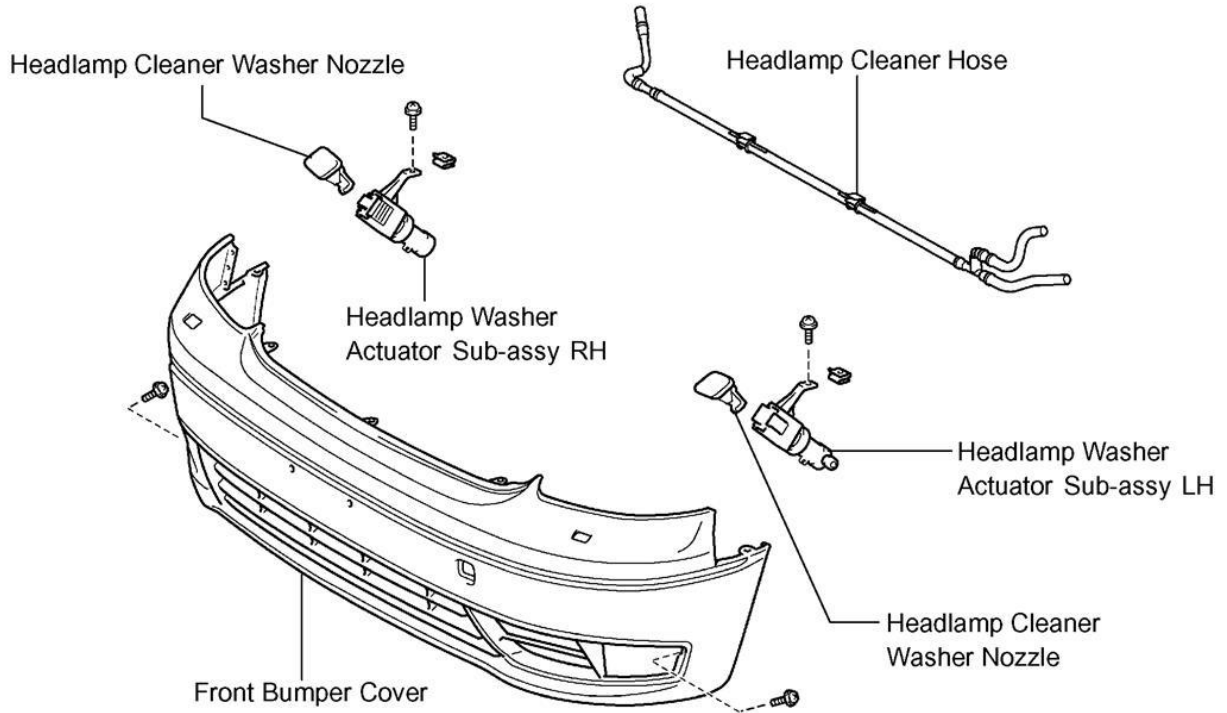

w/ Clearance Sonar System

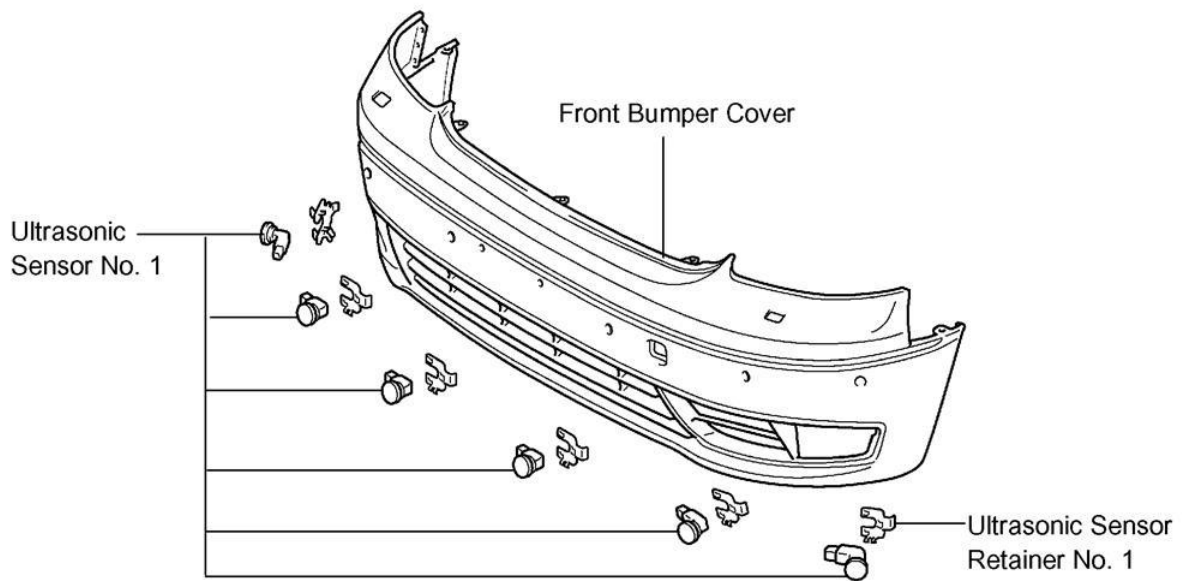

2005 Lexus LS 430

Fig. 3: Removing Front Fender Liner LH

Courtesy of TOYOTA MOTOR SALES, U.S.A., INC.

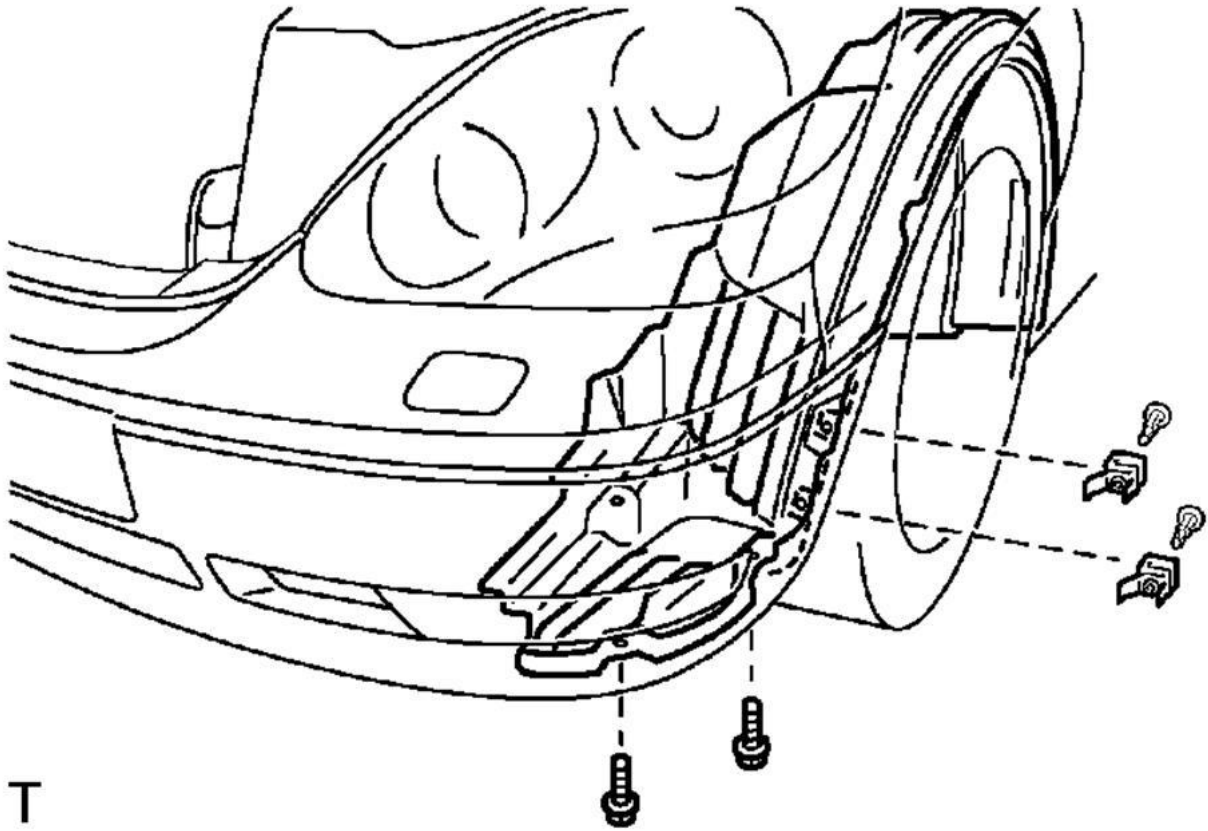



2005 Lexus LS 430

Fig. 4: Removing Front Bumper Cover Nuts

Courtesy of TOYOTA MOTOR SALES, U.S.A., INC.

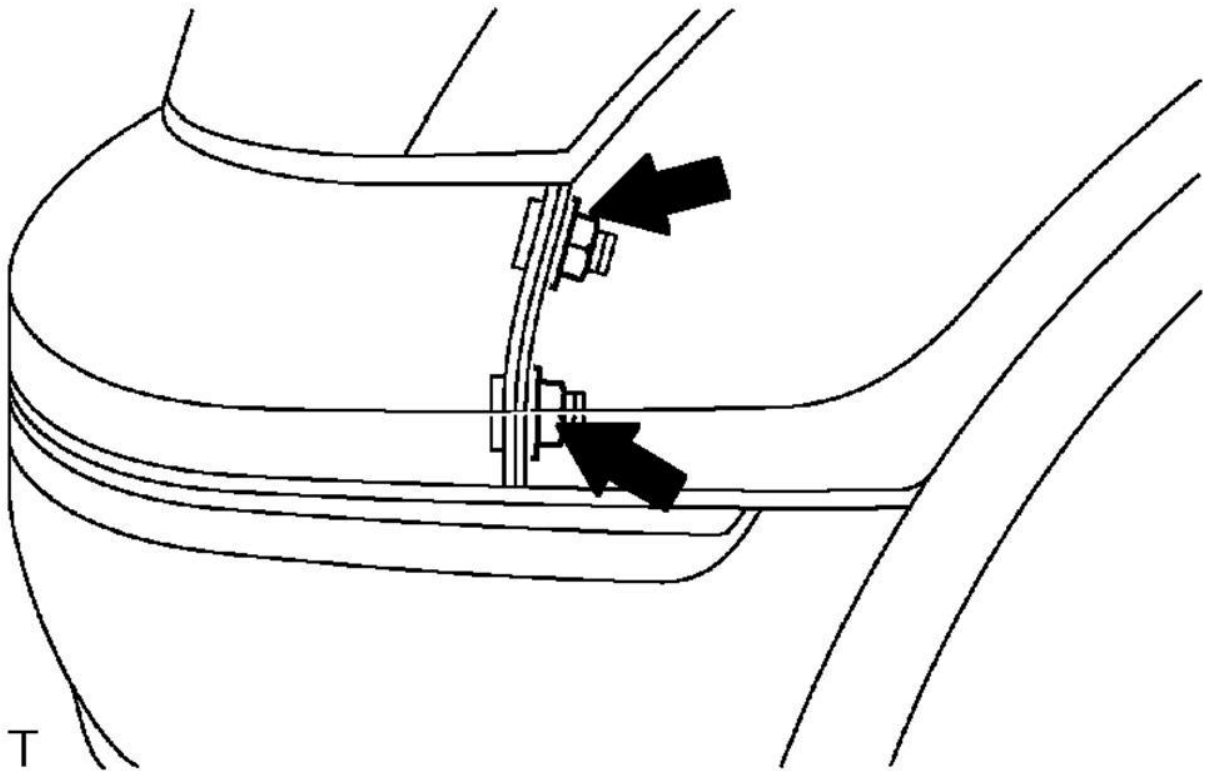

2005 Lexus LS 430

Fig. 5: Removing Front Bumper Cover

Courtesy of TOYOTA MOTOR SALES, U.S.A., INC.

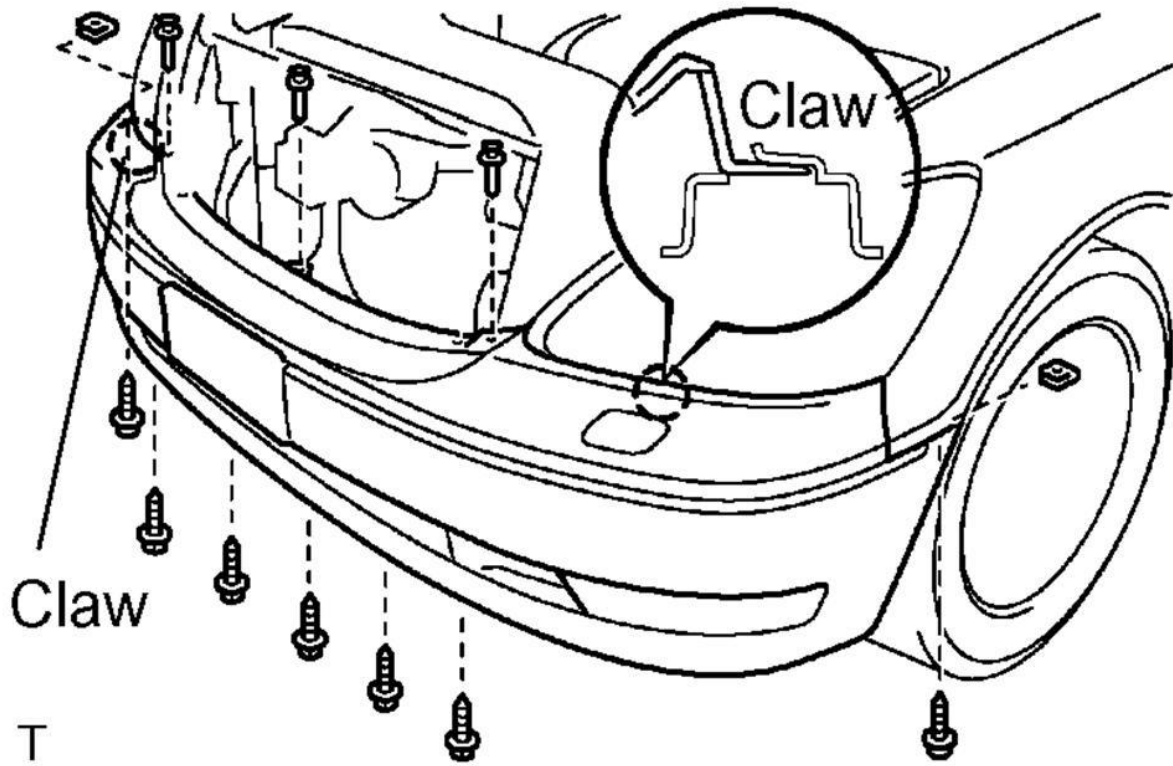

2005 Lexus LS 430

Fig. 6: Removing Radiator Support Reinforcement Lower  
Courtesy of TOYOTA MOTOR SALES, U.S.A., INC.

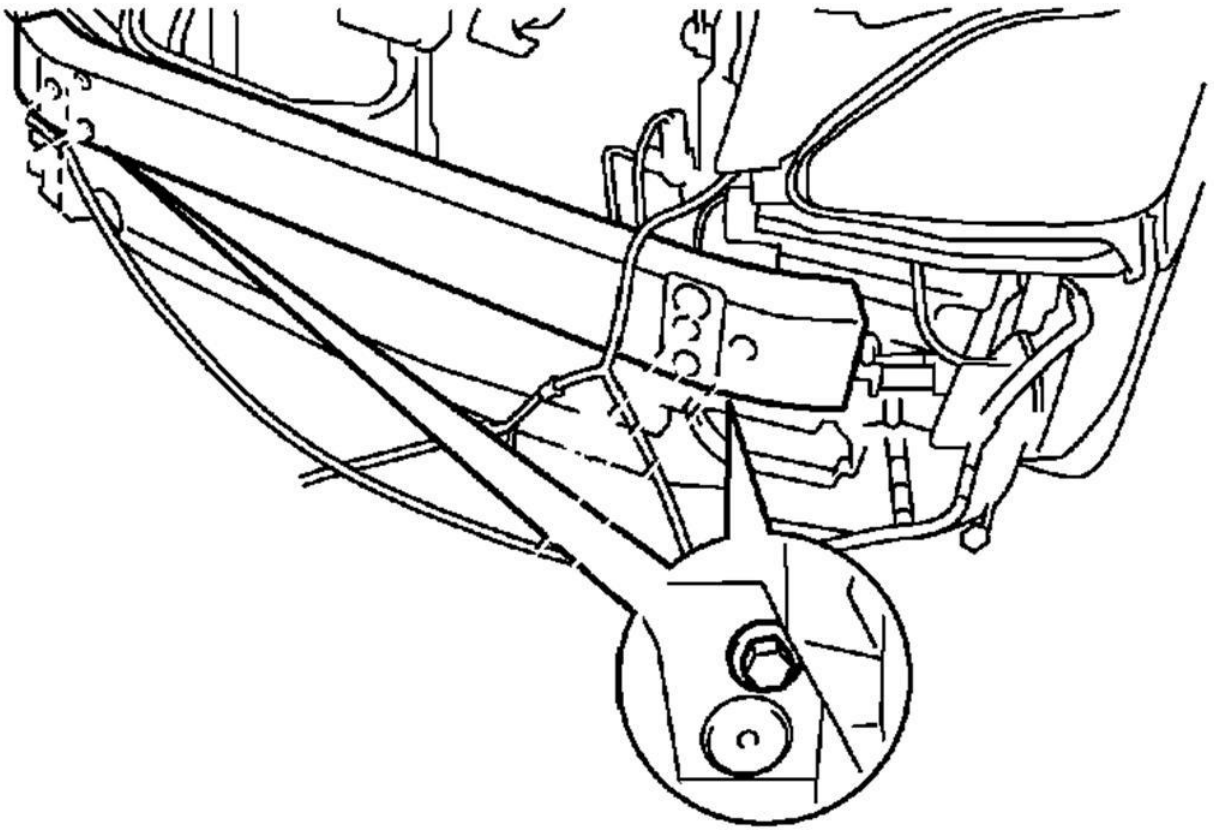

2005 Lexus LS 430

Fig. 7: Removing Fog Lamp Assy LH

Courtesy of TOYOTA MOTOR SALES, U.S.A., INC.

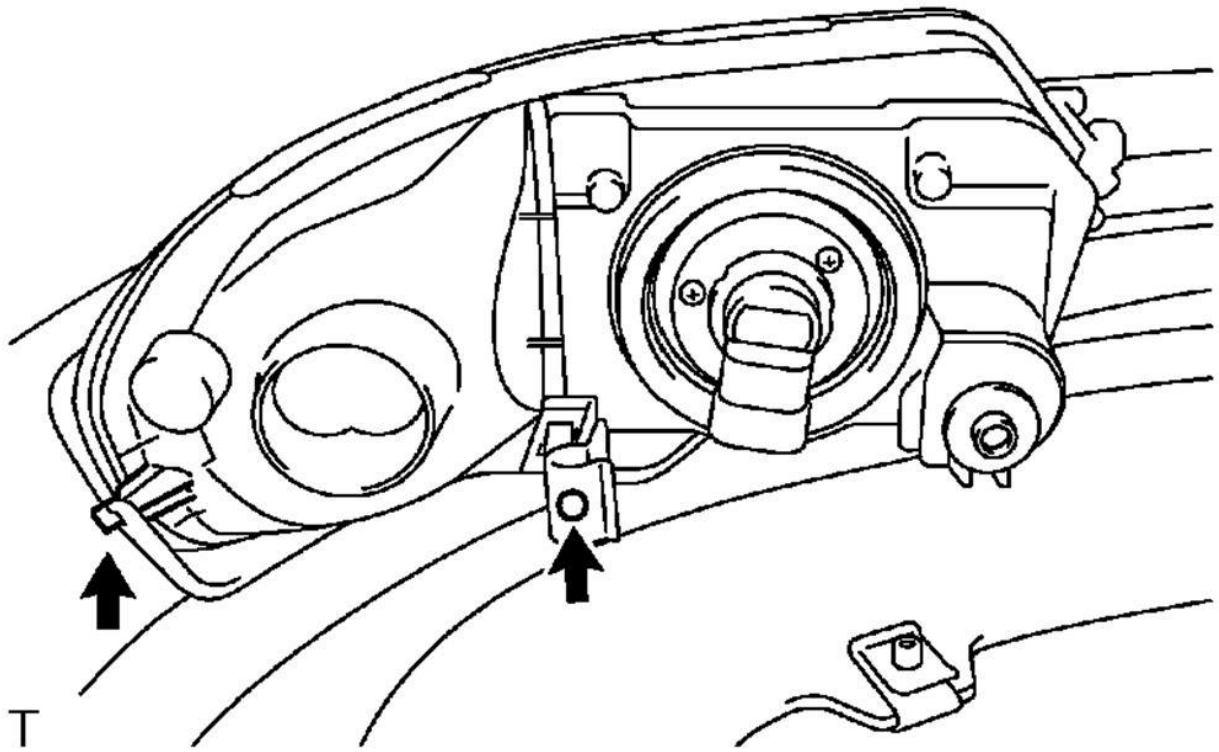

2005 Lexus LS 430

Fig. 8: Removing Headlamp Cleaner Washer Nozzle (W/Headlamp Cleaner)

Courtesy of TOYOTA MOTOR SALES, U.S.A., INC.

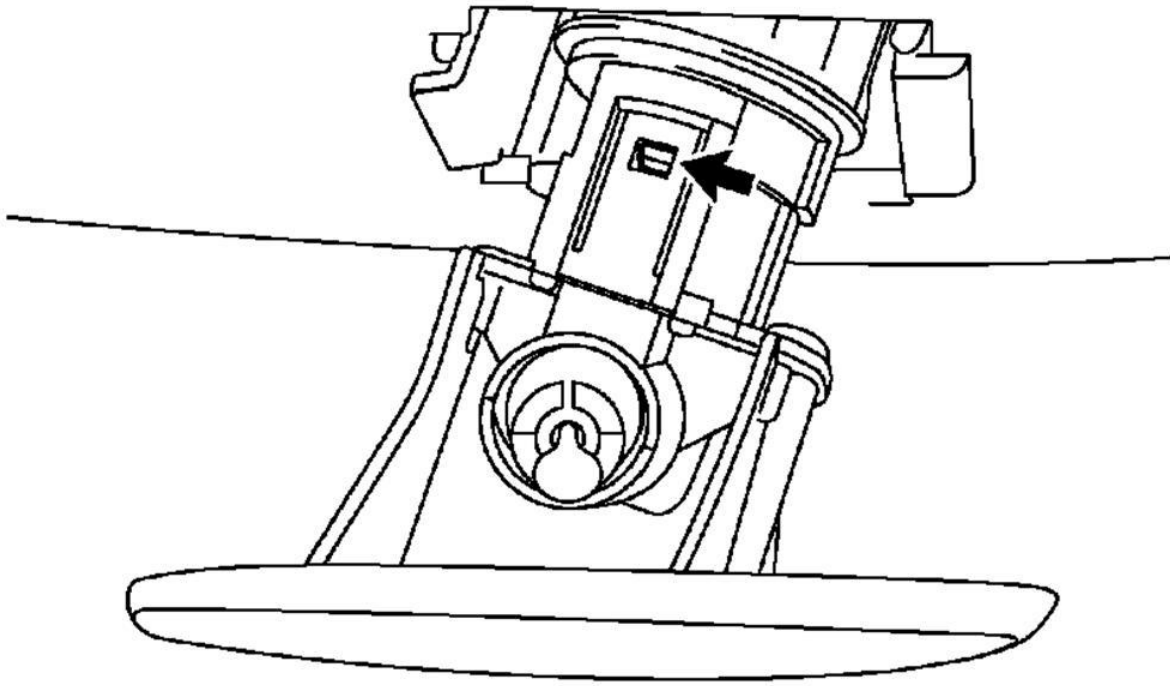

2005 Lexus LS 430

Fig. 9: Taping Drill Tip

Courtesy of TOYOTA MOTOR SALES, U.S.A., INC.

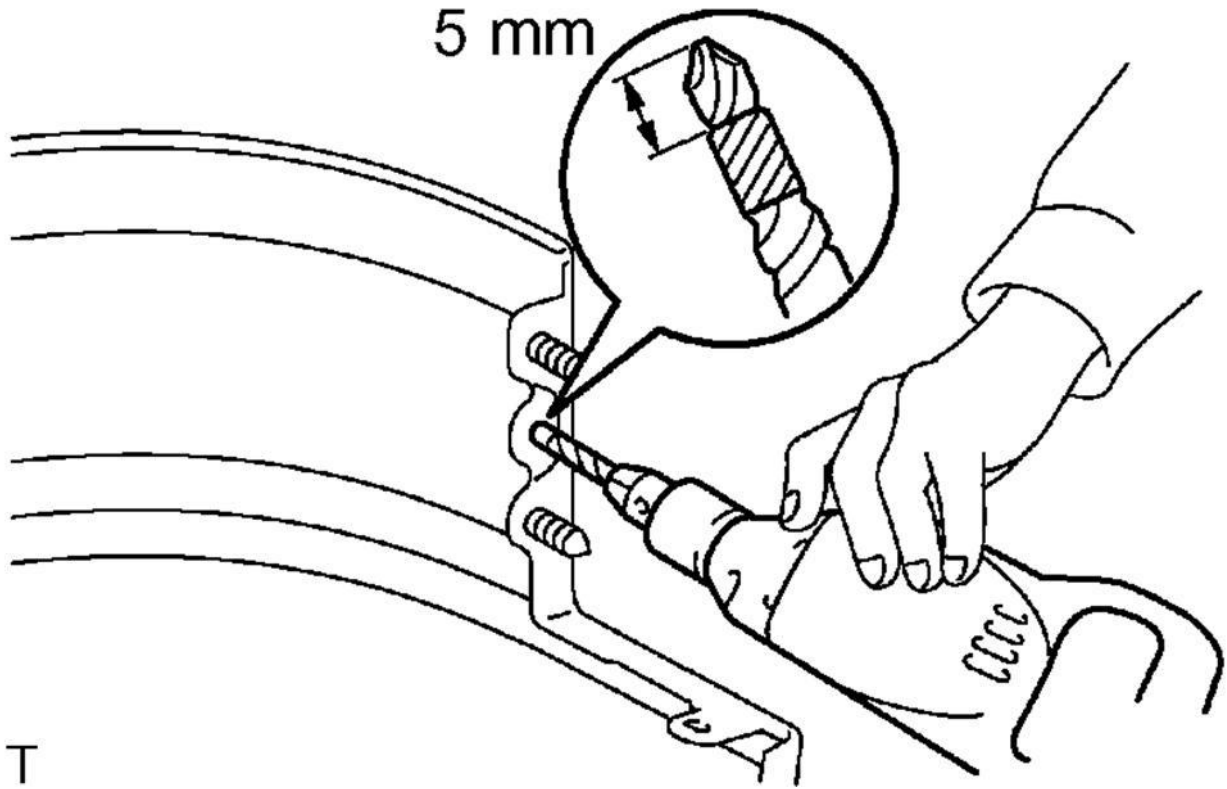

2005 Lexus LS 430

**Fig. 10: Installing Front Bumper Side Retainer LH**  
Courtesy of TOYOTA MOTOR SALES, U.S.A., INC.

