

# OXYGEN SENSOR COMPONENTS

FIOYL-01

## Bank 1 Sensor 1

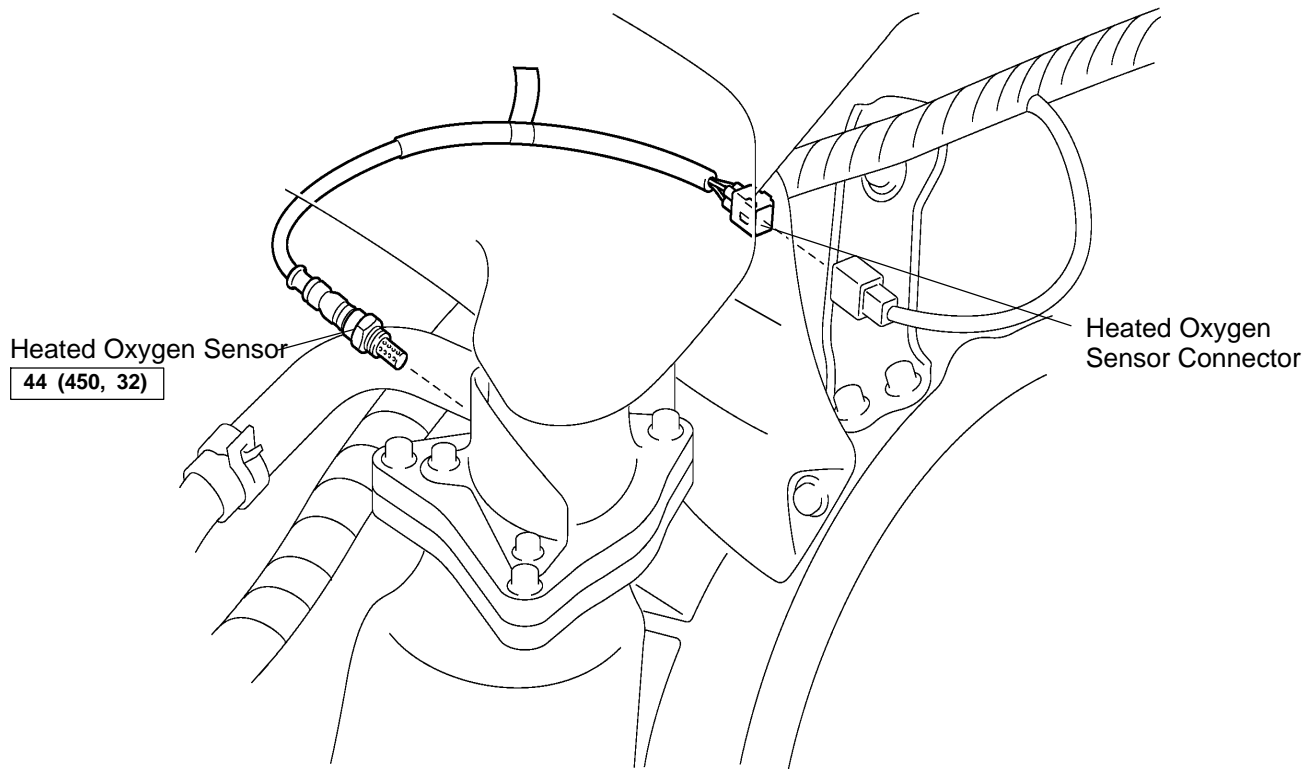

## Bank 2 Sensor 1

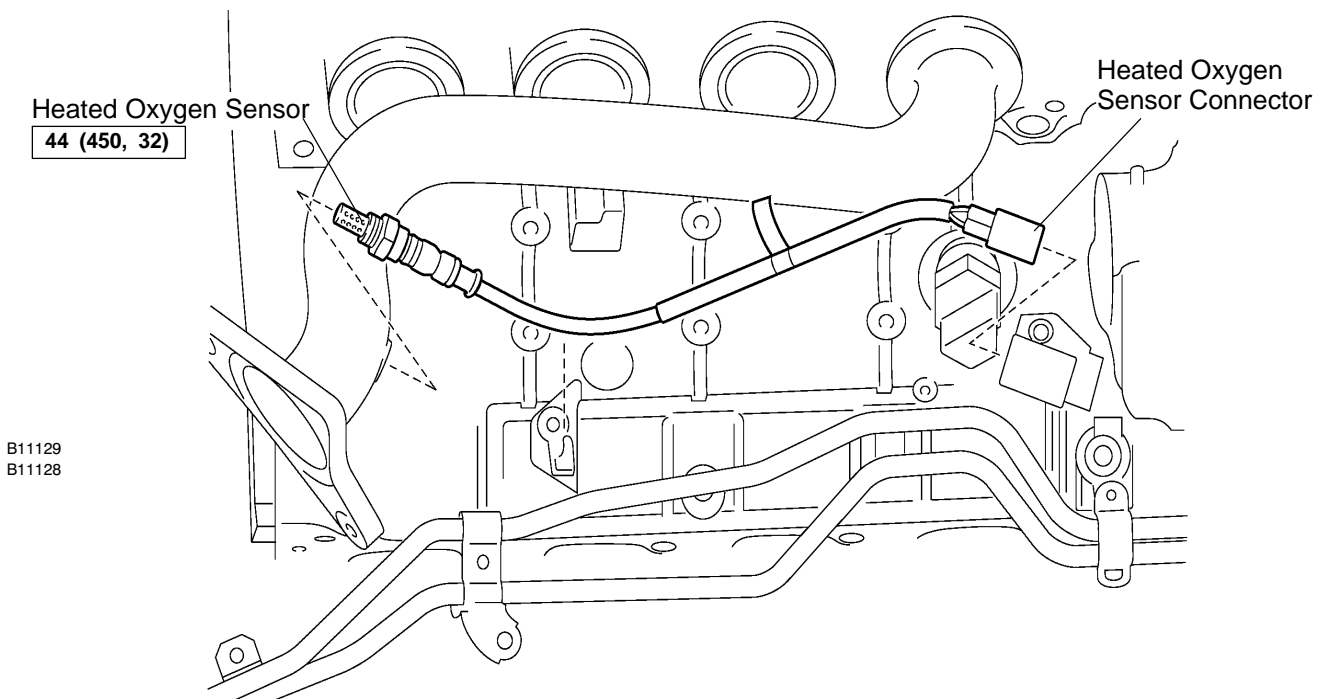

N·m (kgf·cm, ft·lbf) : Specified Torque

B12792

Bank1 Sensor2

Accelerator Pedal

Heater Air Duct Guide

Heated Oxygen Sensor  
44 (450, 32)

Bank2 Sensor2

Instrument Panel Under Cover

Heater Air Duct Guide

Heated Oxygen Sensor  
44 (450, 32)

N·m (kgf·cm, ft·lbf) : Specified Torque

B12791

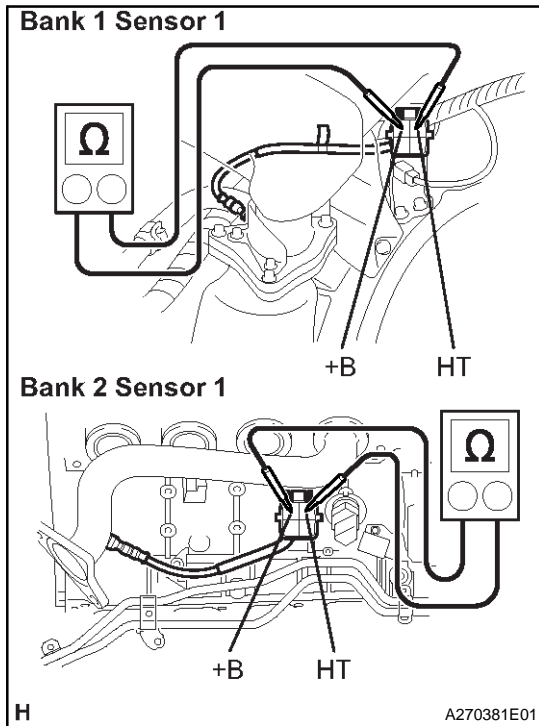

## INSPECTION

### 1. INSPECT HEATER RESISTANCE OF HEATED OXYGEN SENSORS (BANK 1, 2 SENSOR 1)

- Disconnect the oxygen sensor connectors.
- Using an ohmmeter, measure the resistance between the terminals +B and HT.

#### Resistance:

20°C (68°F)	11 – 16 Ω
800°C (1,472°F)	23 – 32 Ω

If the resistance is not as specified, replace the sensor.

- Reconnect the oxygen sensor connectors.

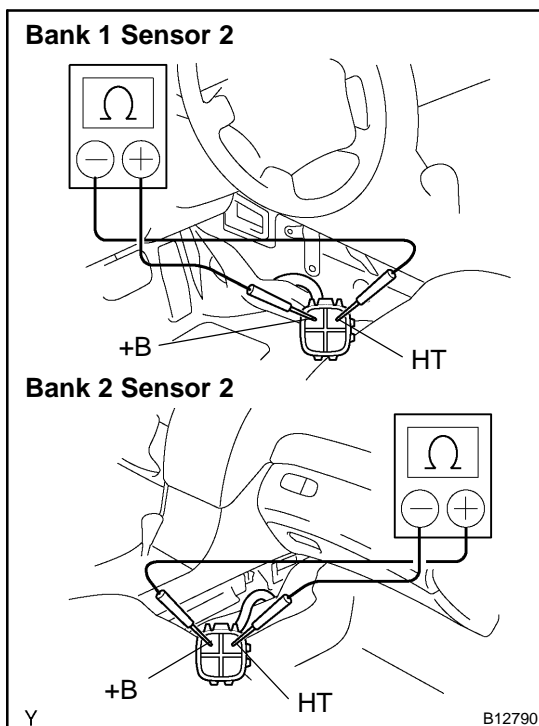

### 2. INSPECT HEATER RESISTANCE OF HEATED OXYGEN SENSORS (BANK 1, 2 SENSOR 2)

- Disconnect the oxygen sensor connectors.
- Using an ohmmeter, measure the resistance between the terminals +B and HT.

#### Resistance:

20°C (68°F)	11 – 16 Ω
800°C (1,472°F)	23 – 32 Ω

If the resistance is not as specified, replace the sensor.

- Reconnect the oxygen sensor connectors.

### 3. INSPECT OPERATION OF HEATED OXYGEN SENSORS (See page DI-71)