

COMBINATION METER ASSY OVERHAUL

710L3-01

HINT:

- COMPONENTS: SEE PAGE 71-1
- Installation is in the reverse order of removal.

NOTICE:

- There should be no oil or fingerprints on the combination meter glass and combination meter ECU.
- Wipe off any oil or fingerprints from the combination meter glass and meter display panel with a soft cloth.
- Be careful of static electricity when handling the meter display panel and combination meter ECU.
- When disassembling the combination meter assy, eliminate static electricity by touching the vehicle body to prevent the components from being damaged.

CAUTION:

Do not touch the circuit. Even after the ignition switch is turned off, the meter display panel condenser will still be charged.

1. REMOVE INSTRUMENT CLUSTER FINISH PANEL CENTER LOWER (SEE PAGE 71-6)
2. REMOVE INSTRUMENT CLUSTER FINISH PANEL END (SEE PAGE 71-6)
3. REMOVE INSTRUMENT CLUSTER FINISH PANEL (SEE PAGE 71-6)
4. REMOVE COMBINATION METER ASSY (SEE PAGE 71-6)

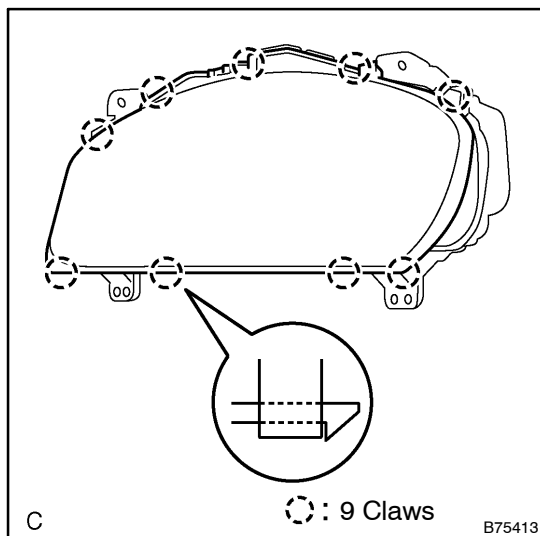

5. REMOVE COMBINATION METER GLASS

- (a) Using a screwdriver, disengage the 9 claws and remove the combination meter glass.

HINT:

Tape up the screwdriver tip before use.

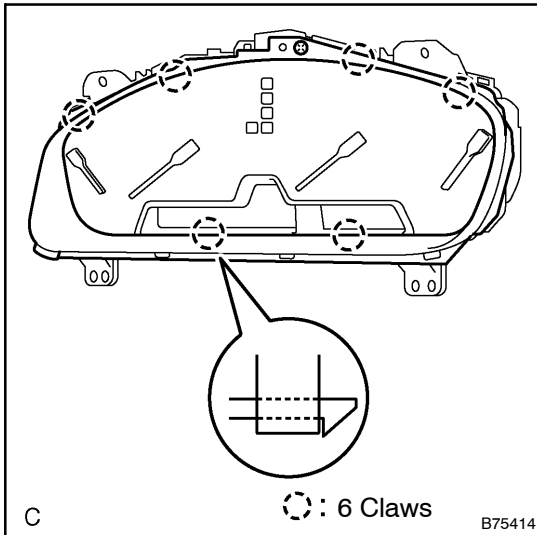
**6. REMOVE COMBINATION METER PLATE NO.1**

- (a) Remove the screw.
- (b) Using a screwdriver, disengage the 6 claws and remove the combination meter plate No.1.

HINT:

Tape up the screwdriver tip before use.

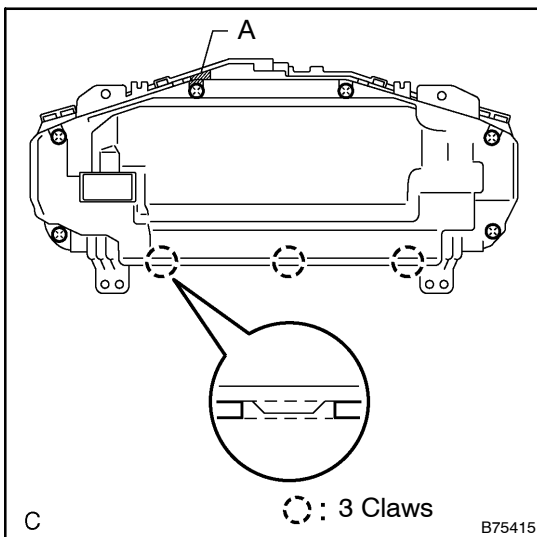
**7. REMOVE COMBINATION METER COVER NO.1**

- (a) Remove the 6 screws.
- (b) Using a screwdriver, disengage the 3 claws and remove the combination meter cover No.1.

HINT:

Tape up the screwdriver tip before use.

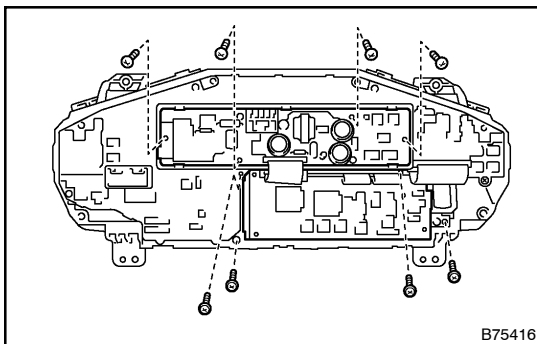
CAUTION:**A is extremely hot immediately after the ignition switch is turned off.****8. REMOVE METER DISPLAY PANEL**

- (a) Remove the 8 screws.
- (b) Remove the meter display panel.

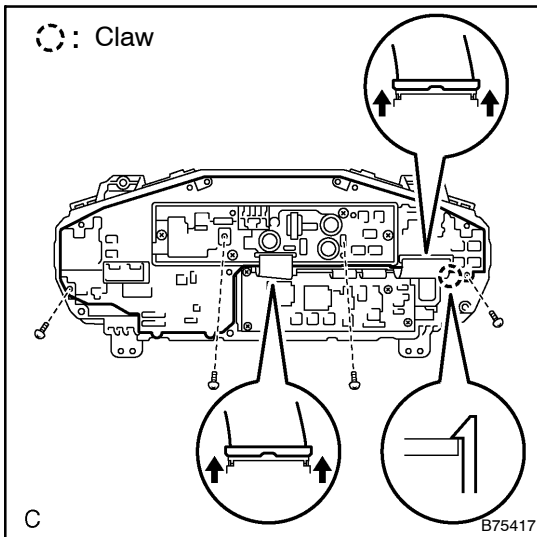
**9. REMOVE COMBINATION METER ECU**

- (a) Remove the 4 screws.
- (b) Disconnect the connectors.
- (c) Using a screwdriver, disengage the claw and remove the combination meter ECU.

HINT:

Tape up the screwdriver tip before use.

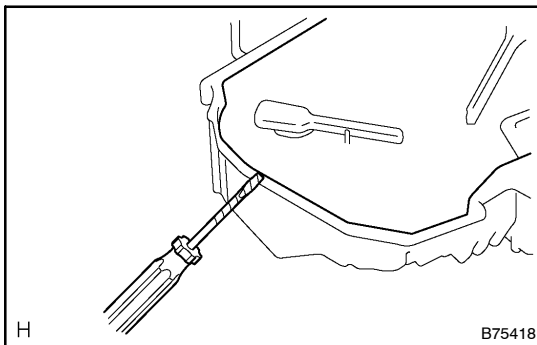

- (d) Using a screwdriver, disengage the combination meter ECU (speed meter assy).

HINT:

Tape up the screwdriver tip before use.

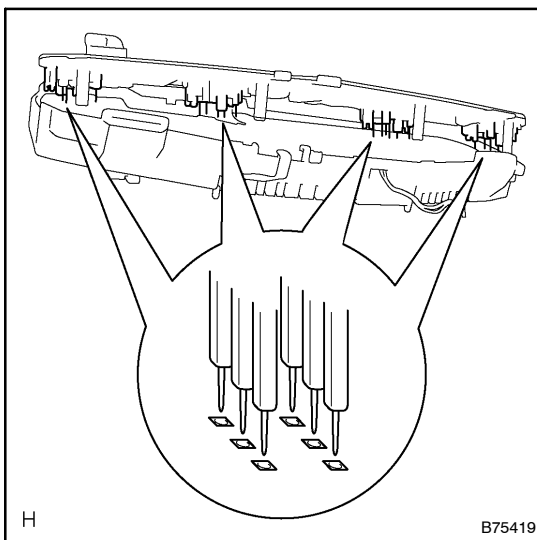

- (e) Remove the combination meter ECU (speed meter assy).

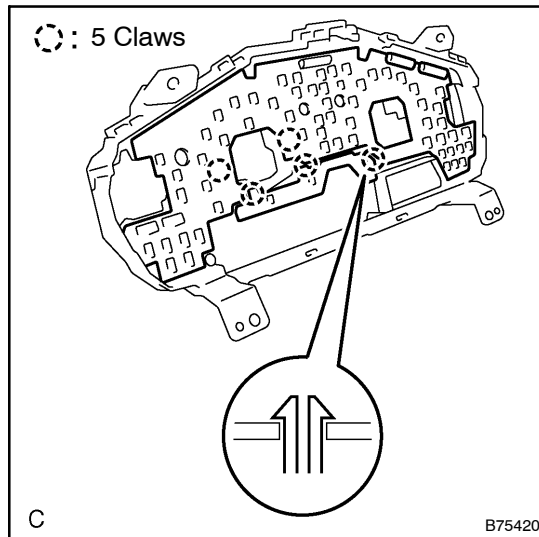
**10. REMOVE ECU METER CIRCUIT PLATE**

- (a) Using a screwdriver, disengage the 5 claws and remove the ECU meter circuit plate from the combination meter case No.1.

HINT:

Tape up the screwdriver tip before use.

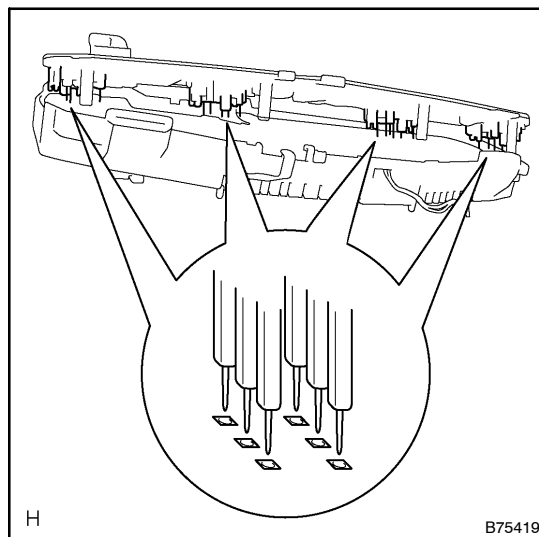
**11. INSTALL COMBINATION METER ECU**

- (a) Install the pins and the combination meter ECU (speed meter assy).

CAUTION:

- Install the pins securely.
- Hold a hand over the panel meter during installation.

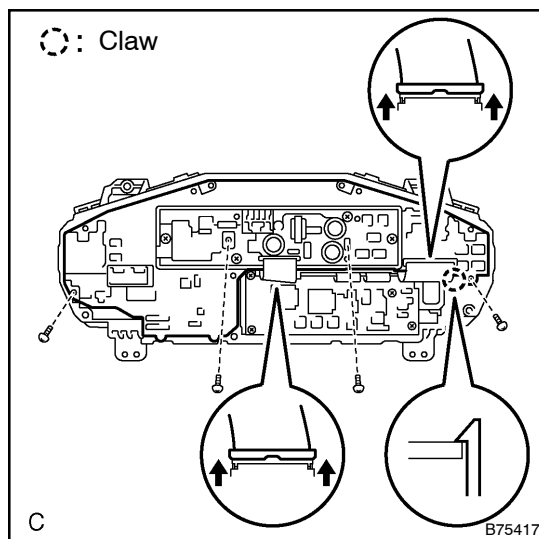

- (b) Engage the claw and install the combination meter ECU with 4 screws.

- (c) Connect the connectors.