

CAMSHAFT POSITION SENSOR COMPONENTS

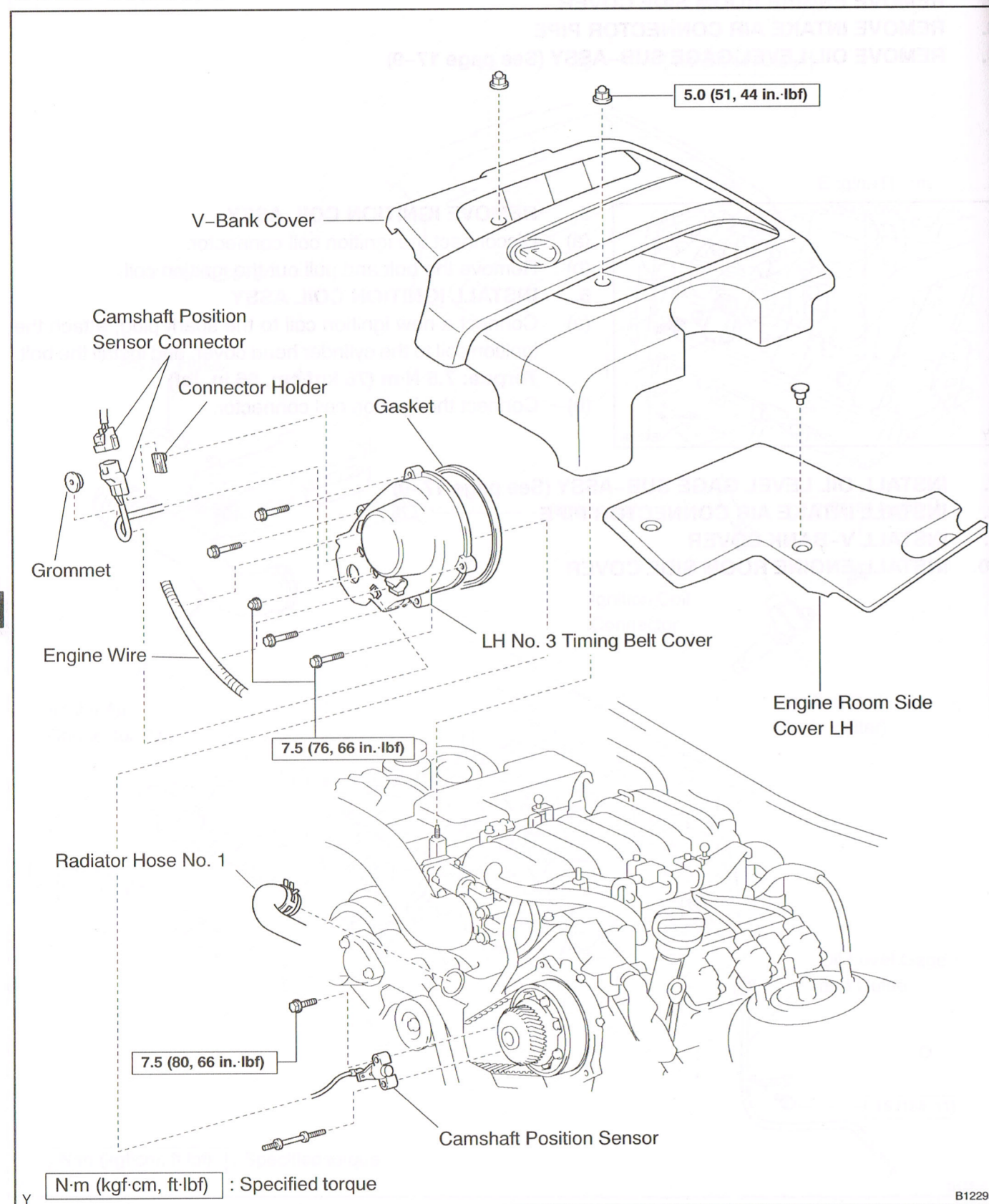

REPLACEMENT

1. REMOVE AIR CLEANER INLET NO.1 (See page 14-25)
2. DRAIN ENGINE COOLANT (See page 16-8)
3. REMOVE V-BANK COVER
4. REMOVE ENGINE ROOM SIDE COVER
5. DISCONNECT RADIATOR HOSE NO.1
6. REMOVE TIMING BELT COVER SUB-ASSY NO.3 LH (See page 14-69)

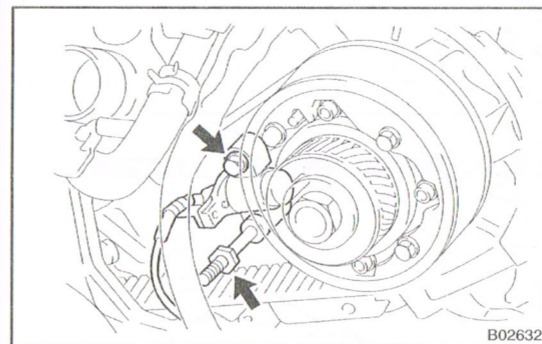

7. REMOVE CAMSHAFT POSITION SENSOR
 - (a) Remove the bolt, stud bolt and sensor.
8. INSTALL CAMSHAFT POSITION SENSOR
 - (a) Install a new sensor with the bolt and stud bolt.
Torque: 7.5 N·m (76 kgf·cm, 66 in.-lbf)

9. INSTALL TIMING BELT COVER SUB-ASSY NO.3 LH (See page 14-69)
10. CONNECT RADIATOR HOSE NO.1
11. INSTALL AIR CLEANER INLET NO.1 (See page 14-25)
12. INSTALL ENGINE ROOM SIDE COVER
13. INSTALL V-BANK COVER
14. REFILL ENGINE COOLANT (See page 16-8)
15. WARM UP ENGINE
16. CHECK FOR ENGINE COOLANT LEAKS