



LEXUS

Vehicle  
**LS 430**

Application  
**All models**

WVTA APPROVED - WVTA GENEHMIGT - WVTA GOEDGEKEURD - APPROUVE WVTA

**PARTNUMBER:**

**PZ408-F1550-00**

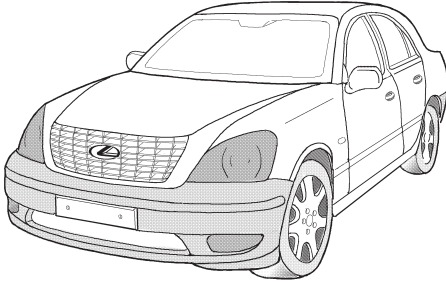

**Towbar**  
**Anhängerküplung**  
**Trekhaak**  
**Remorque d'attelage**

**KIT CONTENT - STÜCKLISTE - KIT INHOUD - CONTENU**

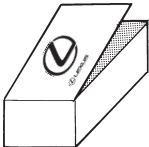

PZ408-F1550-00



Fitting instructions

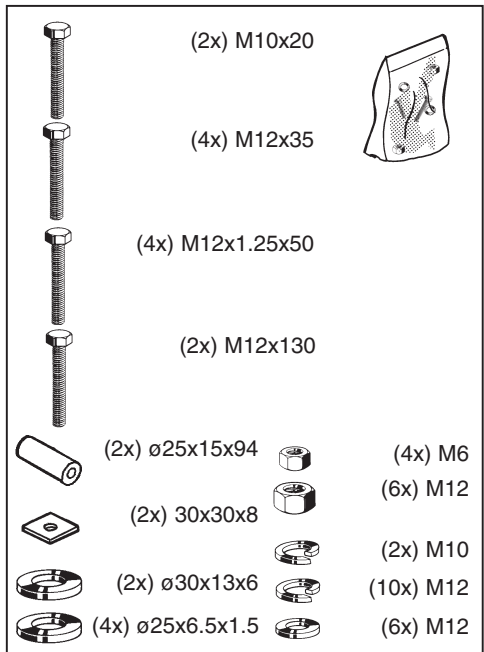
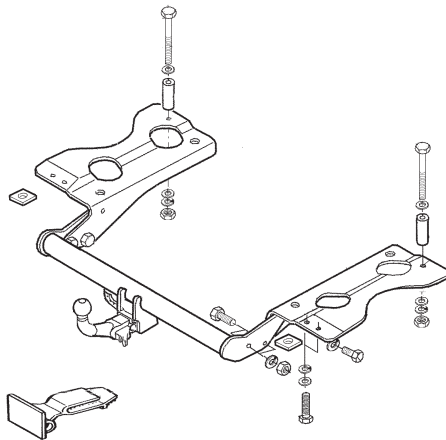

Weight: 28 kg

Gewicht: 28 kg

Gewicht: 28 kg

Poids: 28 kg

Installation time: 1.5 hour.

Anbauezeit: 1,5 Stunden.

Installatie tijd: 1,5 uur.

temps d'installation: 1,5 heure.

**INSTALLATION MANUAL - ANBAU ANLEITUNG - MONTAGE HANDLEIDING - MANUEL D'INSTALLATION**

**PARTNAME:**

Towbar / Anhangerkupplung  
Trekhaak / Remorque d'attelage

**PARTNUMBER: PZ408-F1550-00**

**APPLICATION - ANWENDUNG - APPLICATIE - APPLICATION**

**MODEL CODE LS430:  
UCF 30\* - AEAGKW**



**VEHICLE OPTION - FAHRZEUG OPTION - VOERTUIG OPTIE - OPTION VEHICULE**

Not applicable  
Nicht zutreffend  
Niet van toepassing  
Mon applicable

Not applicable  
Nicht zutreffend  
Niet van toepassing  
Mon applicable

**ACCESSORY - ZUBEHOR - ACCESSOIRE - ACCESSOIRE**

Not applicable  
Nicht zutreffend  
Niet van toepassing  
Mon applicable

Not applicable  
Nicht zutreffend  
Niet van toepassing  
Mon applicable

**SAFETY PRECAUTION - SICHERHEITSMANAHME - VEILIGHEIDSVOORSCHRIFTEN - PRECAUTIONS DE SECURITE**

Not applicable  
Nicht zutreffend  
Niet van toepassing  
Mon applicable

**TOOLS - WERKZEUGE - WERKTUIGEN - OUTILS**

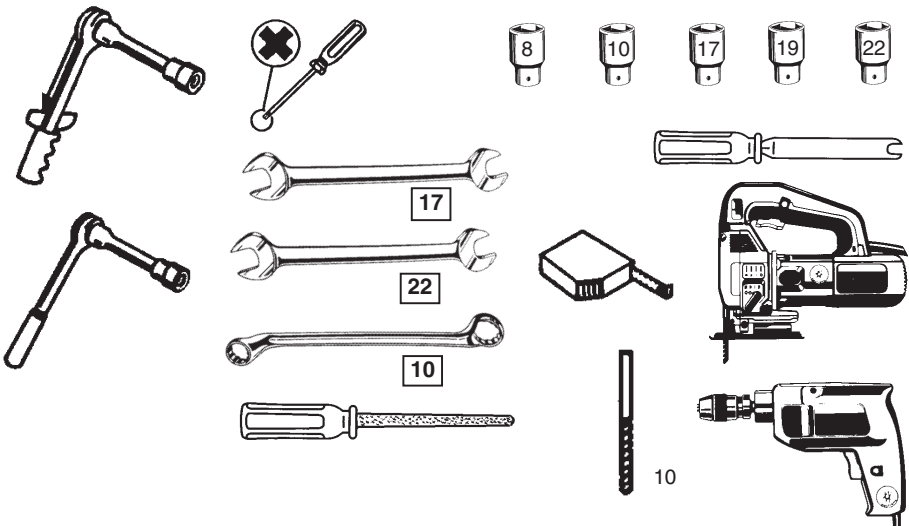

\*Number of installation steps: 18

\*Aantal installatie stappen: 18

\*Zahl der einbauschritte: 18

\*Nombre des démarches d'installation: 18

CRITICAL OPERATIONS - SICHERHEITSSMAßNAHME - KRITIEKE HANDELINGEN - OPERATION DÉLICATE

|               |    |
|---------------|----|
| Picture:      | 4  |
| Abbildung:    | 10 |
| Figuur:       | 11 |
| Illustration: | 17 |



±5%

**D-value**

$$D = \frac{2215 \text{ KIG max} + 2000 \text{ KIG max}}{2215 \text{ KIG max} + 2000 \text{ KIG max}} \times \frac{9.81}{1000} = 11.0 \text{ kN}$$

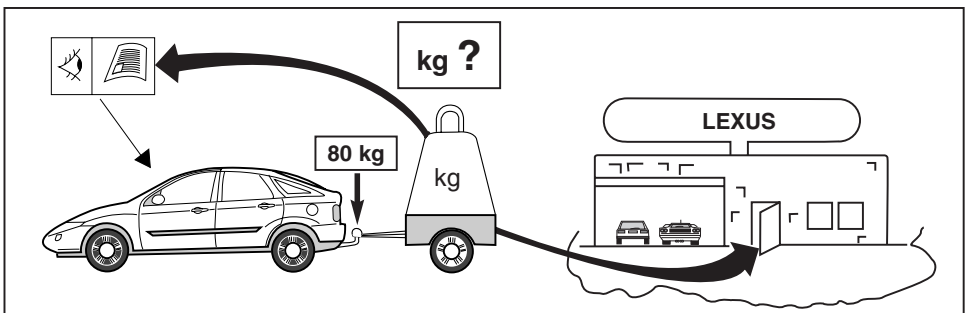
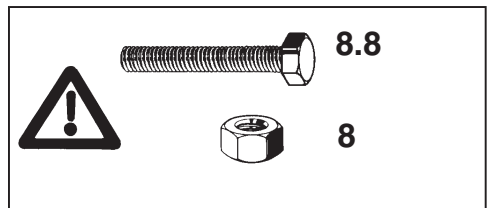
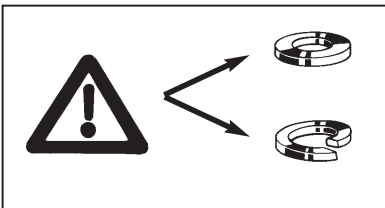

1

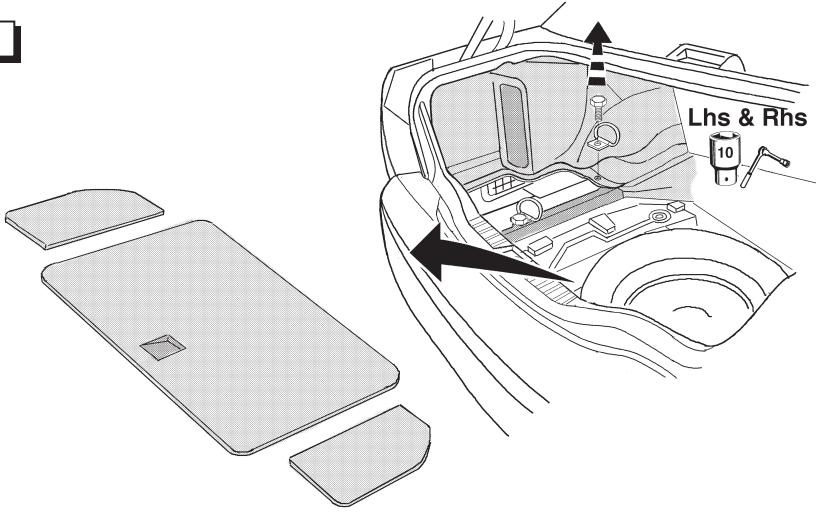

2

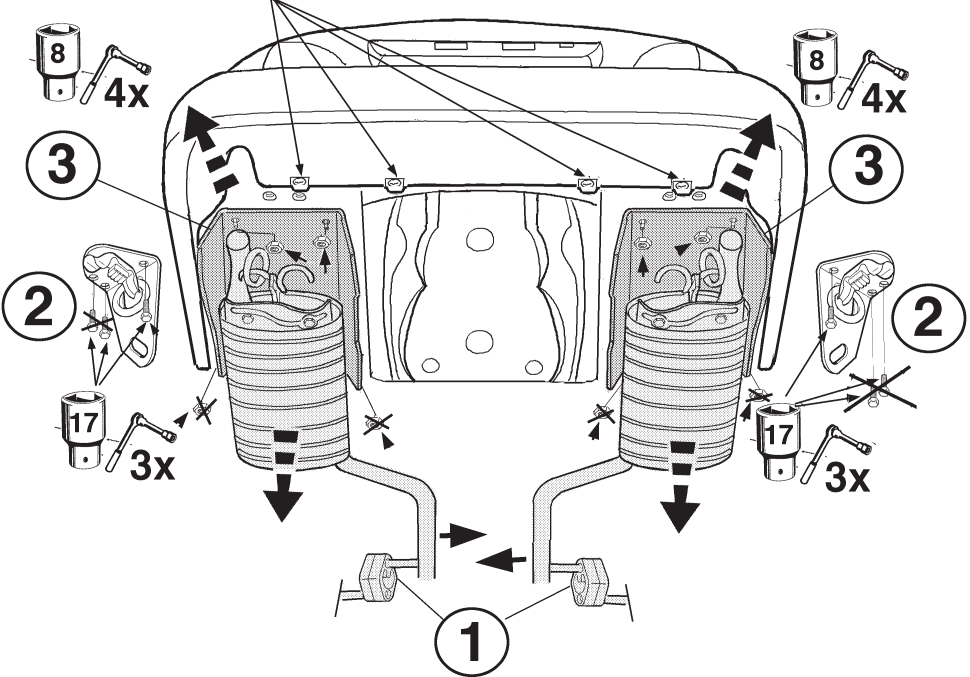
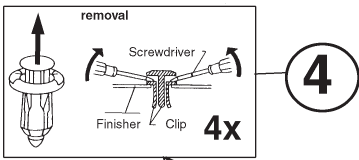

3

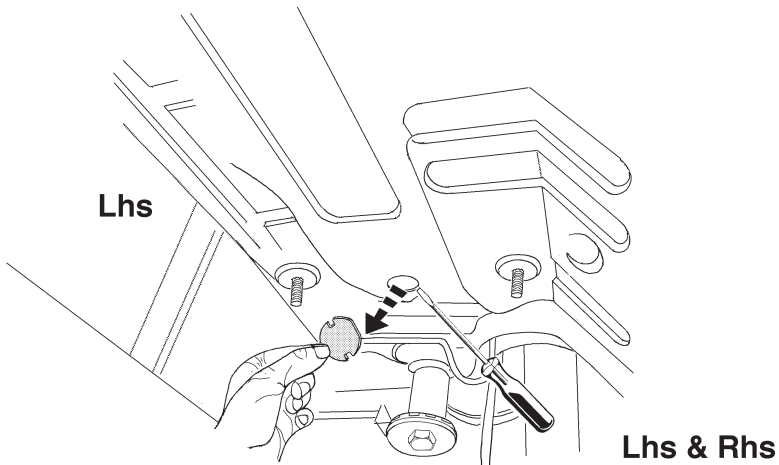

4

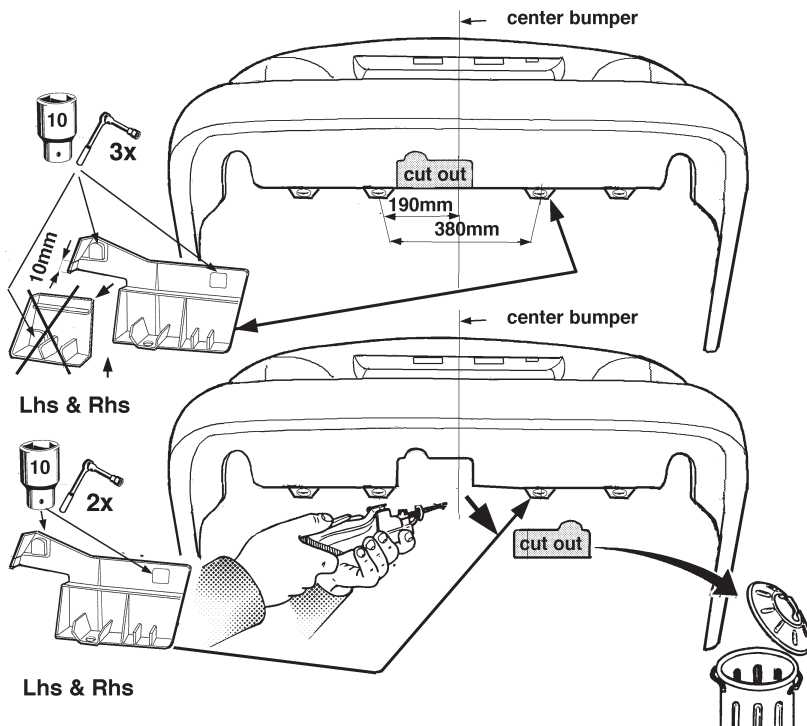
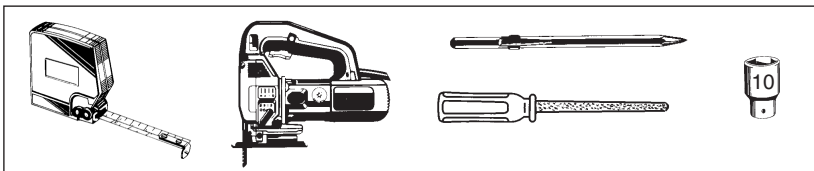

5

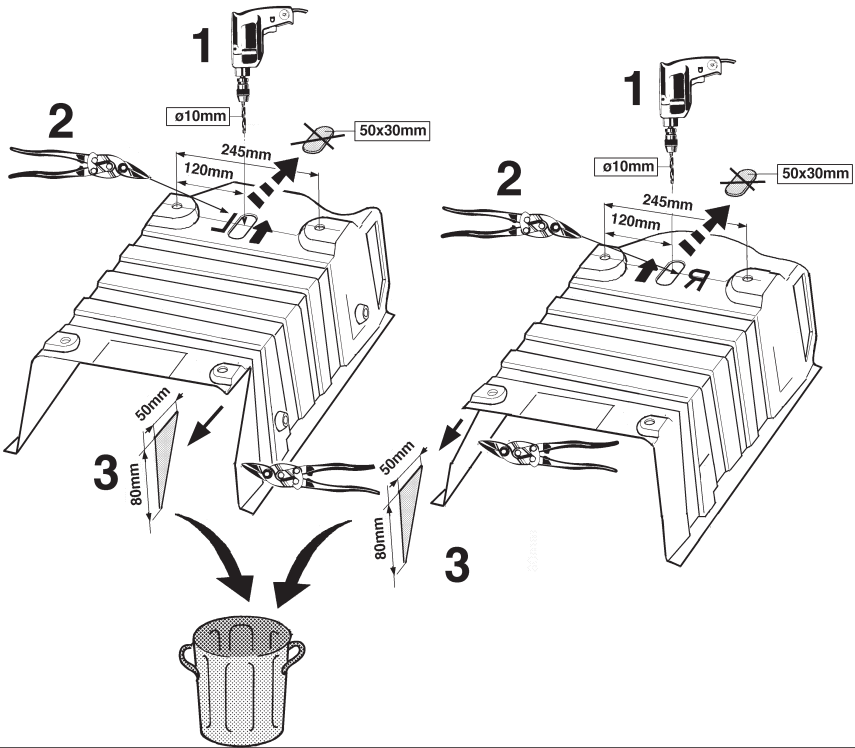
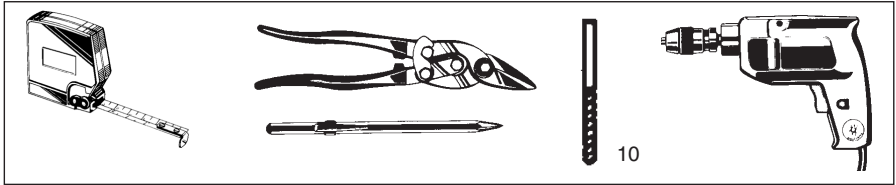

6

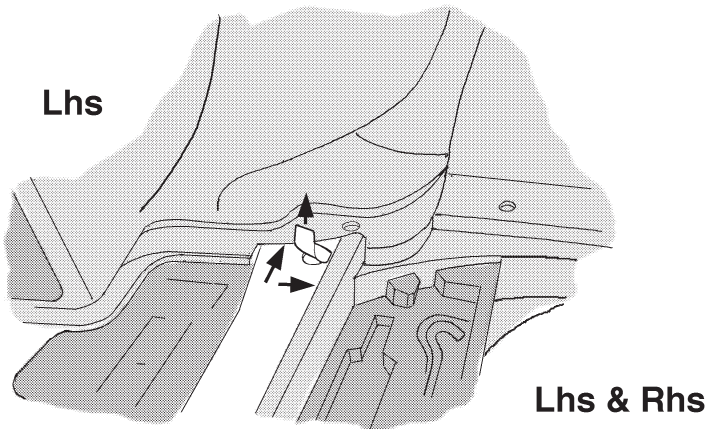

7



(2x) M12x130



(2x) M12

M12X130

Lhs

ø30X13X6



Lhs & RhS

7a

ø25x15 L=94mm

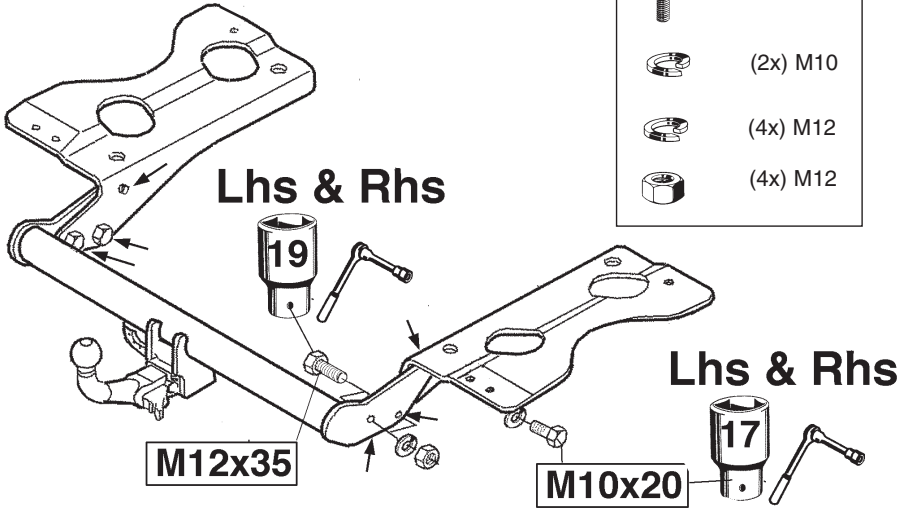
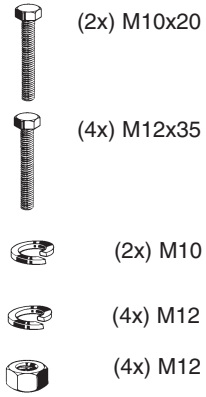



9



(4x) M12x1.25x50



(6x) M12



(2x) M12



(6x) M12



(2x) 30x30x8

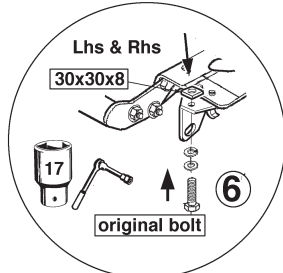
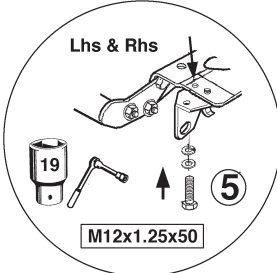
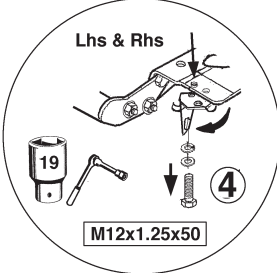
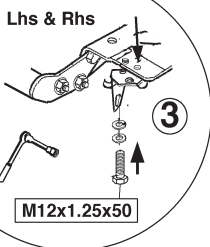
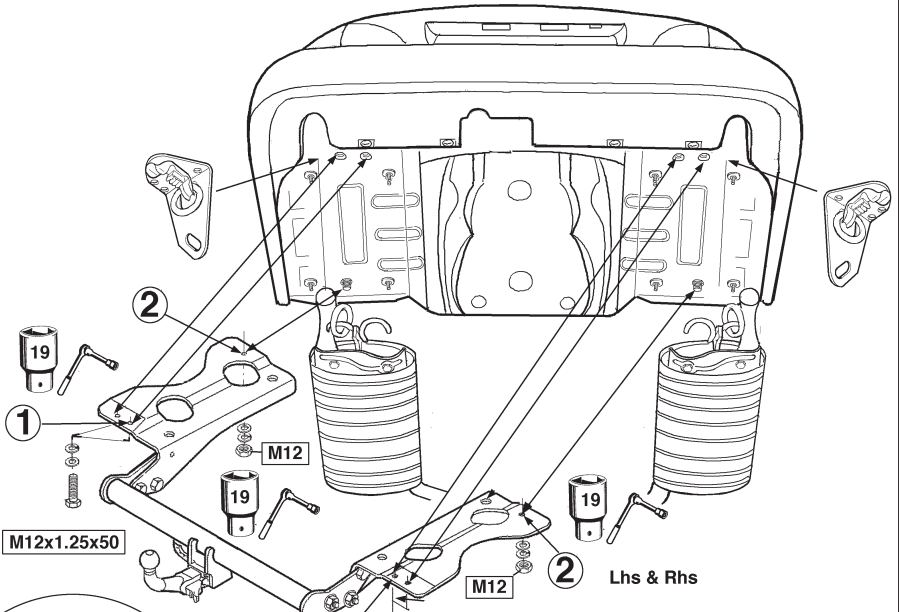

10

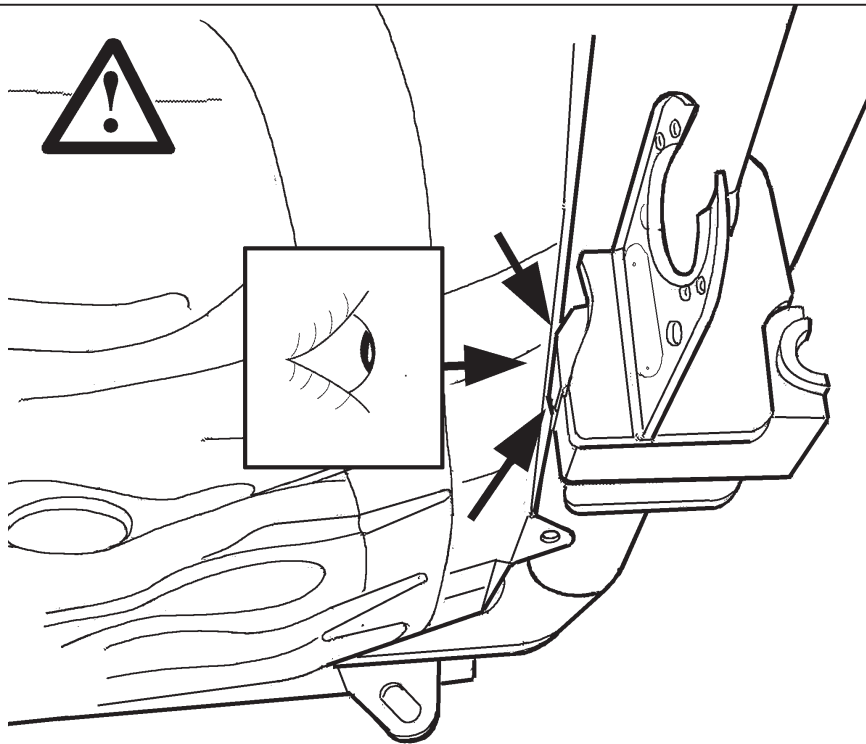

11

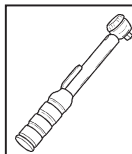

M6

9,5 Nm



M10

46 Nm



M12

79 Nm



M12x1.25

95 Nm



12

(4x) M6  
(4x)  $\varnothing 25 \times 6.5 \times 1.5$

Rhs

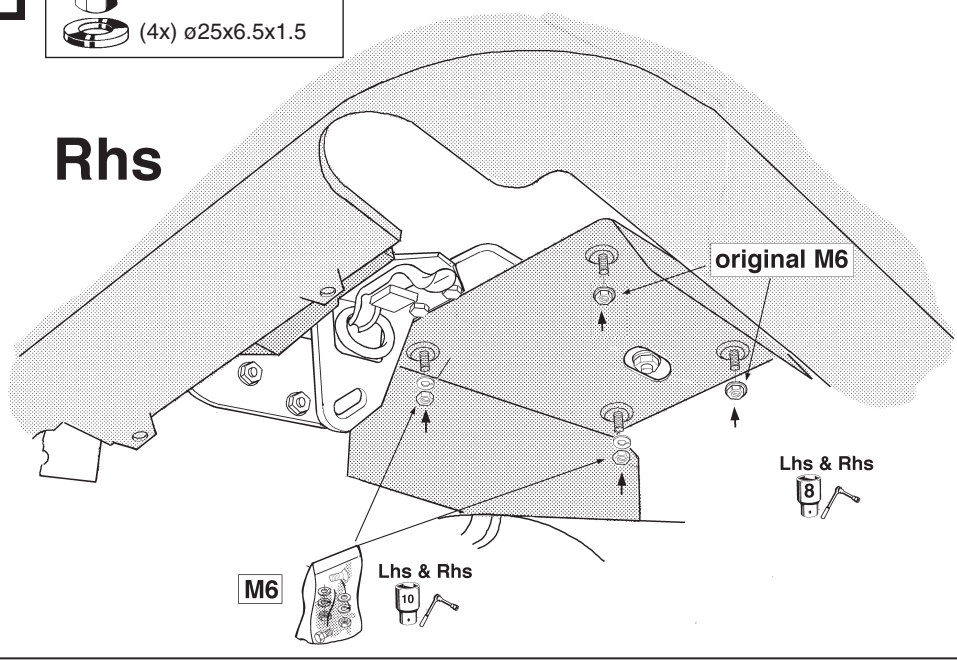

13

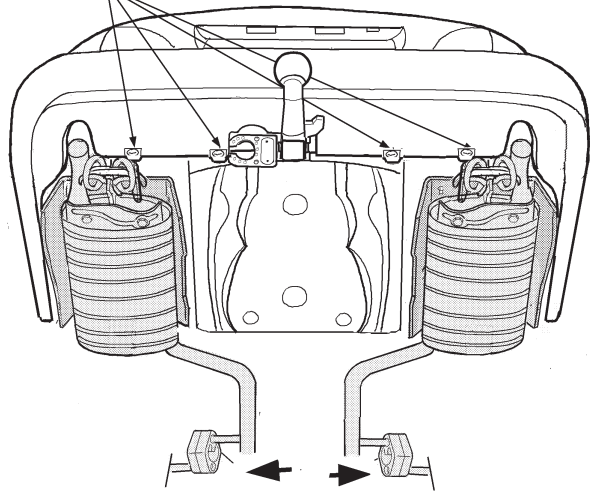
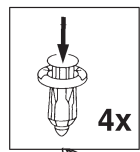

14

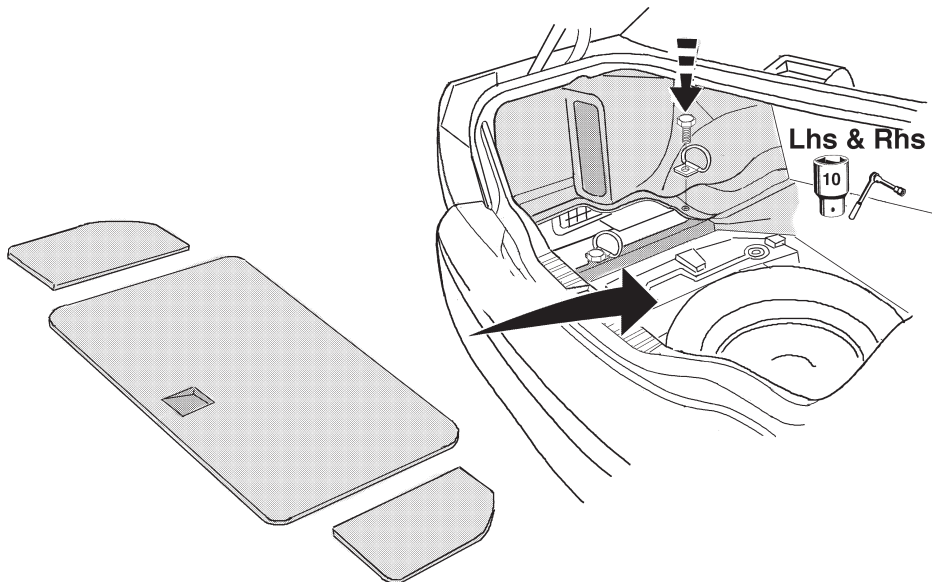

15

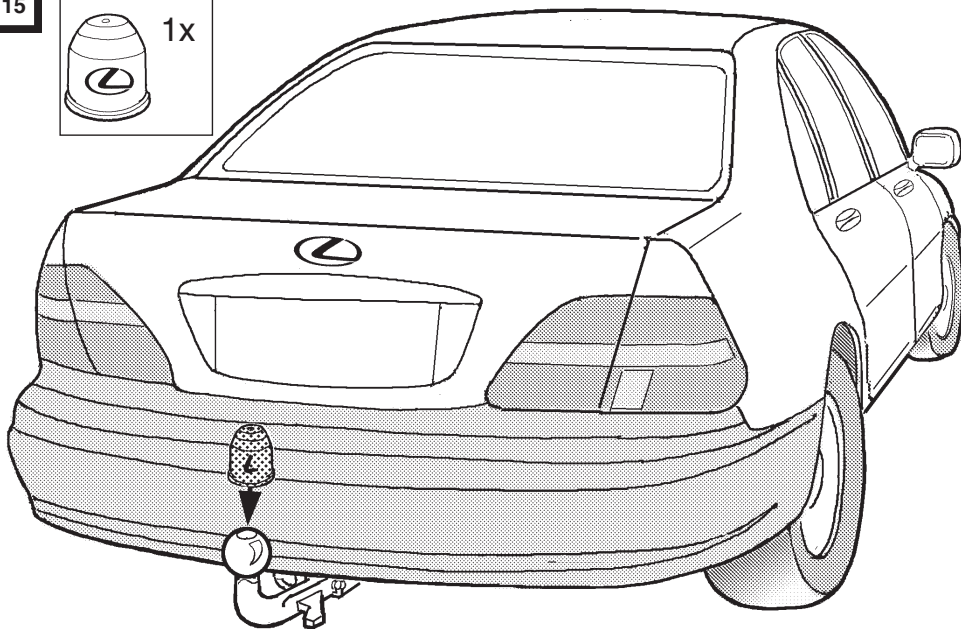
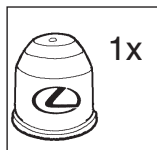

16

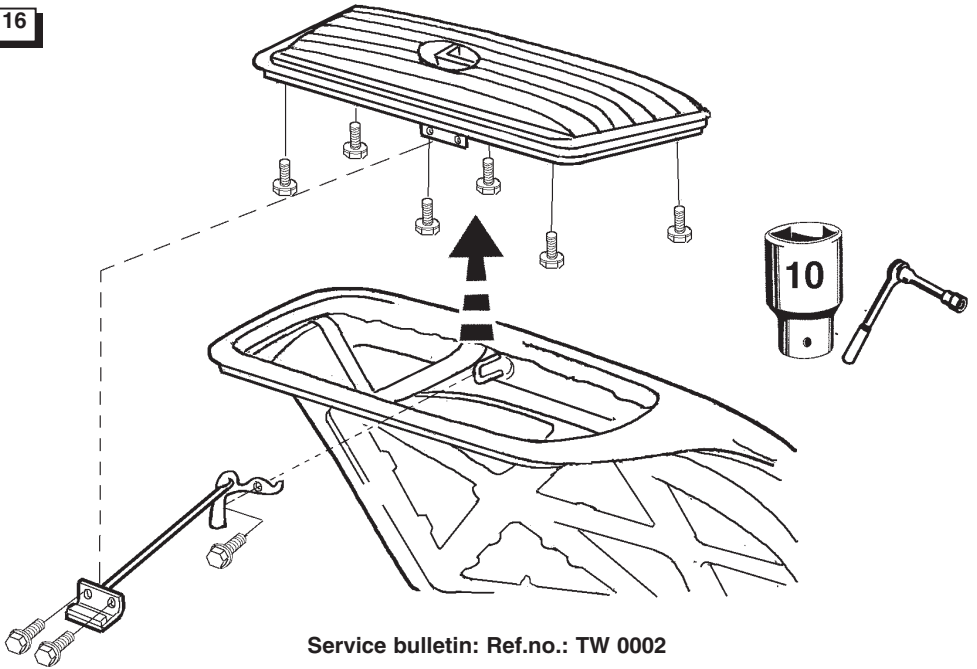

Service bulletin: Ref.no.: TW 0002

17

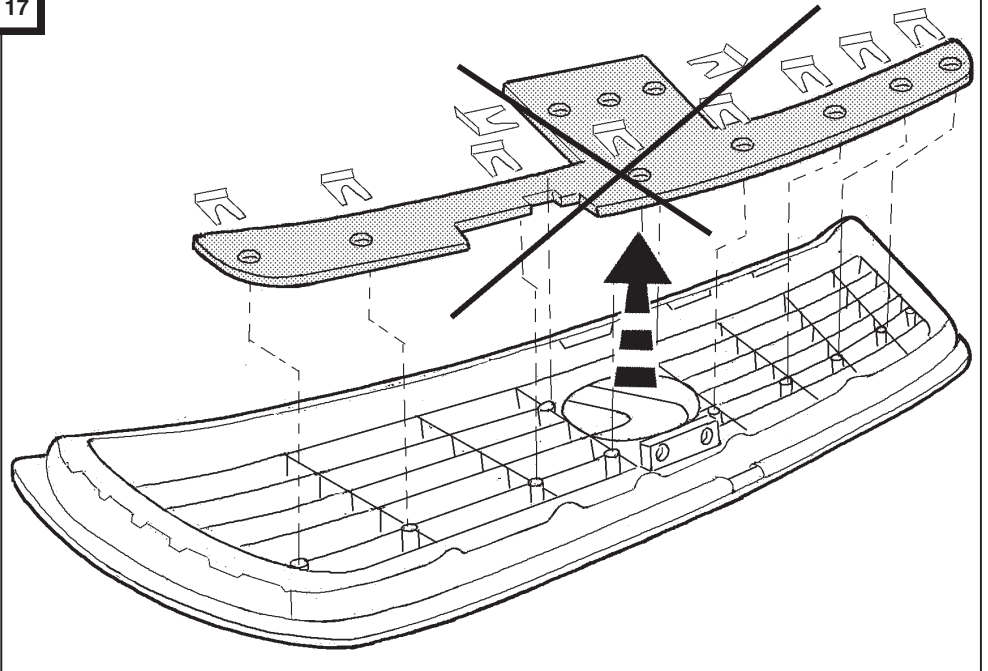

18

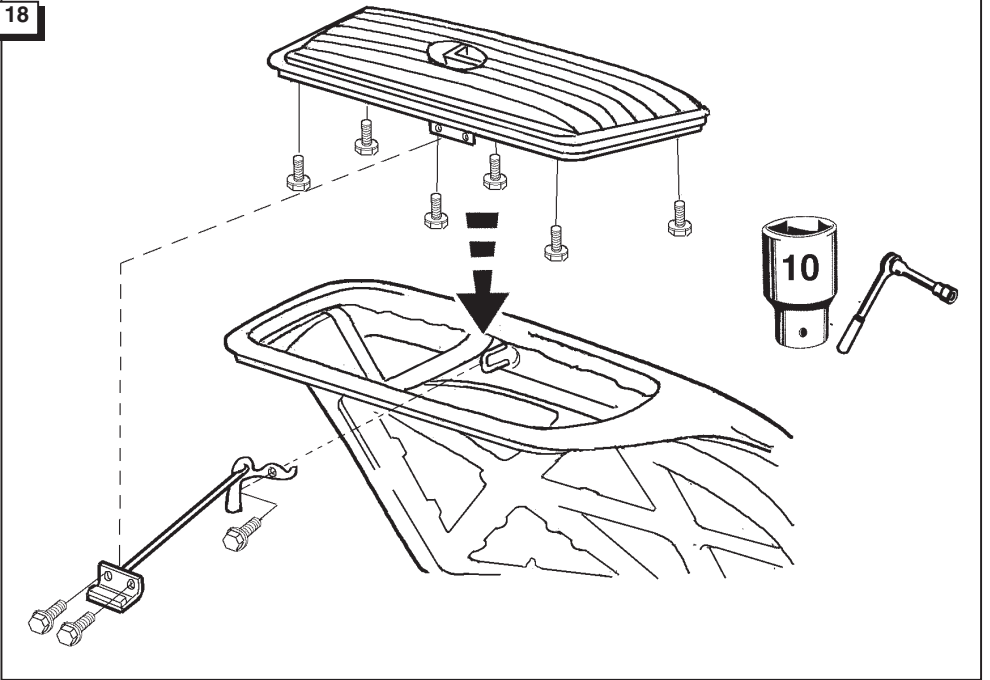

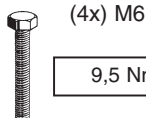
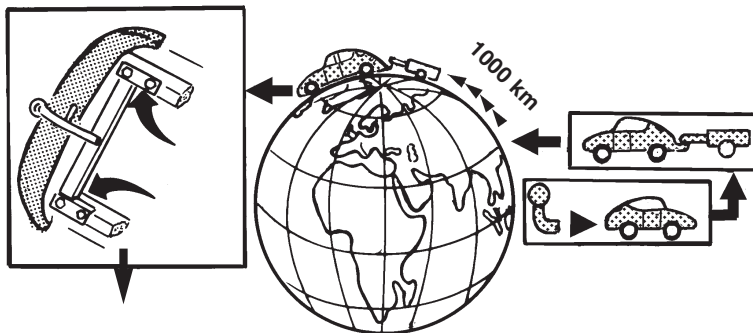

(4x) M6

9,5 Nm

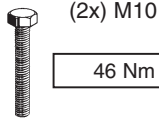

(2x) M10

46 Nm

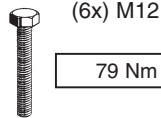

(6x) M12

79 Nm

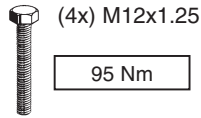

(4x) M12x1.25

95 Nm



D

### HINWEISE:

- \* Das höchstzulässige Zuggewicht und der erlaubte Kugeldruck Ihres Fahrzeugs Händler zu befragen.
- \* Elektrische Anlage gemäß StVZO anbringen.
- \* Der nachträgliche Einbau der Kupplungskugel mit Halterung nach dieser Anbauanleitung muß nach den Deutschen Vorschriften (§19 StVZO) durch einen befugten Sachverständigen oder Prüfer unter Vorlage des KfZ-Briefes überprüft werden. Danach kann von der Zulassungsstelle, der Einbau in den KfZ-Schein eingetragen werden.
- \* Klebeschild mit Stützlastangabe am KfZ an gut sichtbarer Stelle in der Nähe der Kupplungskugel anbringen (Innenseite Kofferraum ist auch zulässig).

