

MAS AIR FLOW (MAF) METER COMPONENTS FOR REMOVAL AND INSTALLATION

EG0YJ-0N

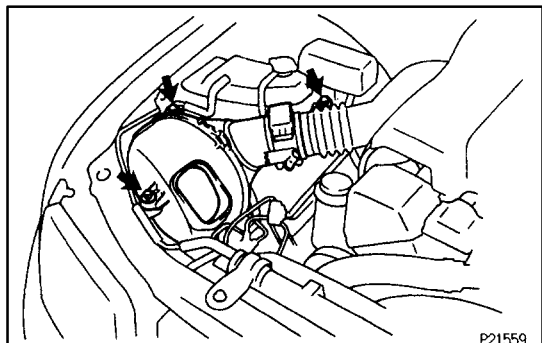
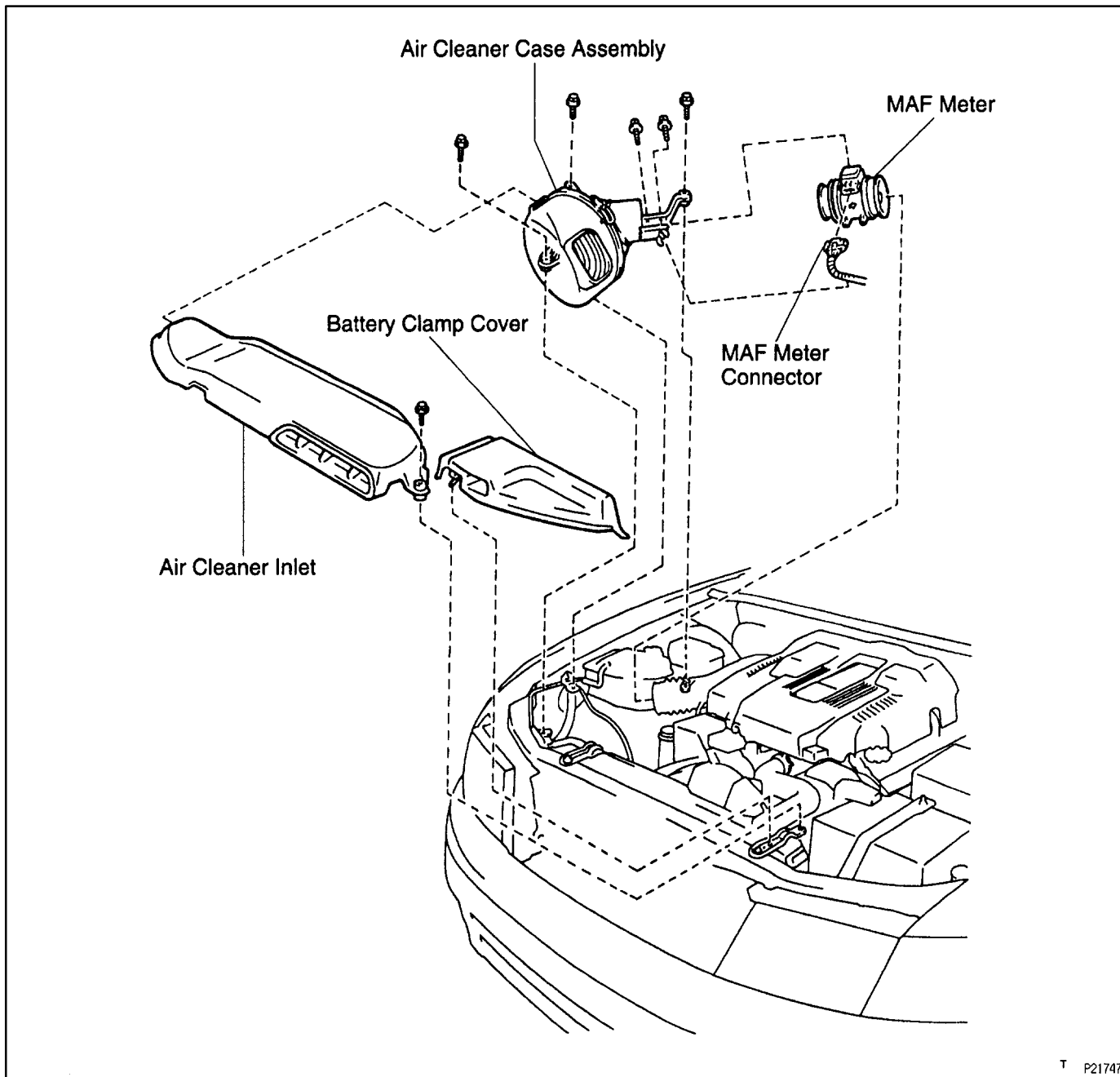

MAF METER REMOVAL

EG5F8-01

Installation is in the reverse order of removal.

1. **REMOVE BATTERY CLAMP COVER AND AIR CLEANER INLET**
2. **REMOVE AIR CLEANER CASE ASSEMBLY**
 - (a) Disconnect the MAF meter connector.
 - (b) Loosen the hose clamp.
 - (c) Remove the 3 bolts and air cleaner case assembly.

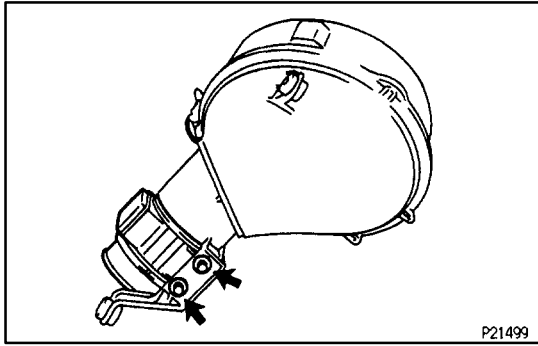

3. REMOVE MAF METER FROM AIR CLEANER CASE

Remove the 2 bolts and MAF meter.

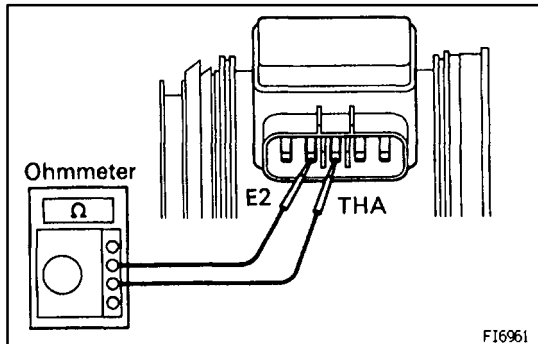

MAF METER INSPECTION

EG2ZS-04

1. INSPECT MAF METER RESISTANCE

Using an ohmmeter, measure the resistance between terminals THA and E2.

Between terminals	Resistance	Temperature
THA – E2	10 – 20 k Ω	-20°C (-4°F)
THA – E2	4 – 7 k Ω	0°C (32°F)
THA – E2	2 – 3 k Ω	20°C (68°F)
THA – E2	0.9 – 1.3 k Ω	40°C (104°F)
THA – E2	0.4 – 0.7 k Ω	80°C (140°F)

If the resistance is not as specified, replace the MAF meter.

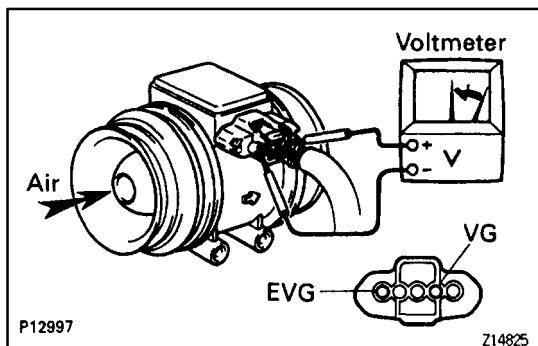

2. INSPECT MAF METER OPERATION

- Connect the MAF meter connector.
- Using a voltmeter, connect the positive (+) tester probe to terminal VG, and negative (-) tester probe to terminal EVG.
- Blow air into the MAF meter, and check that the voltage fluctuates.
If operation is not as specified, replace the MAF meter.
- Disconnect the MAF meter connector.