

Interior Trim 2015-12

2015 Lexus IS350 F-Sport AWD (with nav.)

Nebula gray exterior, Ryojo Red Interior.

Film: 3M 1080 color: Matte red metallic 1080-M203

- General notes:
 - Before wrapping, clean trim with rubbing alcohol to remove any oils etc.
 - 1080 Film is very forgiving and workable. It can be stretched (with heat per instructions) until it starts turning whitish – then it's scrap.
 - Reference YouTube for general instructions about using 1080 mfilm
 - Film can be removed and reapplied, or scrapped when things are not going well.
 - Use caution to avoid any contamination on adhesive side of film – grit will show in final product and it does not look good.
 - For all parts review what areas are exposed before removing from the vehicle, to know what needs to be wrapped. Avoid exposed cut edged of film in final product.
 - All trim pieces are rather flimsy during removal and during wrapping – easily broken. Take care to apply pressure only locally when unsnapping and when wrapping. For example, do not pull on the RH end of the dash piece to remove the LH end snaps!
 - The color is not a perfect match for Ryojo red. For me, it's close enough where the factory material is not directly adjacent/touching the wrap material, but I would not use this wrap on the door window control panel for instance, which is adjacent to factory red vinyl.

Dash Horizontal Piece

1) Snap out lower rectangular trim in front of display panel. Lift rear edge with fingernails or plastic tool. Left edge is a bit crammed under cowl, need to wiggle around to get trim piece out.

“Cowl” (wraps over instrument cluster)



2) Remove (2) screws with M1 socket – careful not to damage screen face. Display panel rotates out – top come rearward first. Then remove (2) wire connectors



3) This leaves the entire silver trim piece exposed. It snaps out – remove RH end first. Be careful not to break the piece – it’s thin in the center area behind the display. Photo show RH end loose.



4) Cowl must be loosened to remove LH end of silver trim. Grab ends and the cowl will unsnap rearward. Photos show cowl loosened.



Removing LH end requires twisting piece around a bit, even with cowl loosened. This bent/broke a tiny pre-guide finger on the part, which is inconsequential – presumably it is an assembly aid/locating finger.

It may be possible to remove without breaking the tiny finger with cowl removed further (?)



Applying film to dash piece. (YouTube has detailed instructions). For this piece, no heat was needed/used.

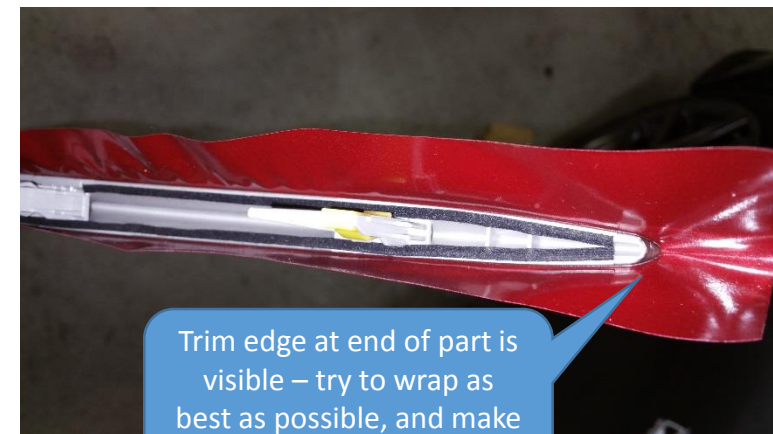
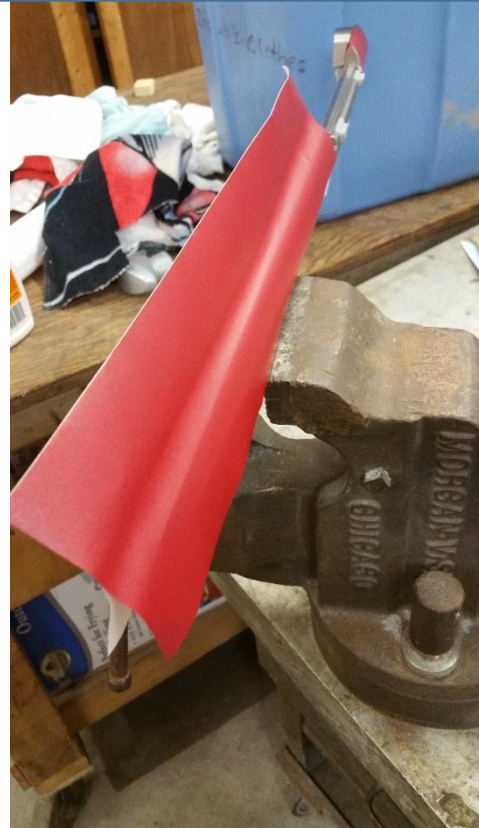

Trim edge at end of part is visible – try to wrap as best as possible, and make super-clean trim edge

Center Console Side Panels

Before removal, note which areas are exposed, and be sure to cover all visible areas completely with wrap.

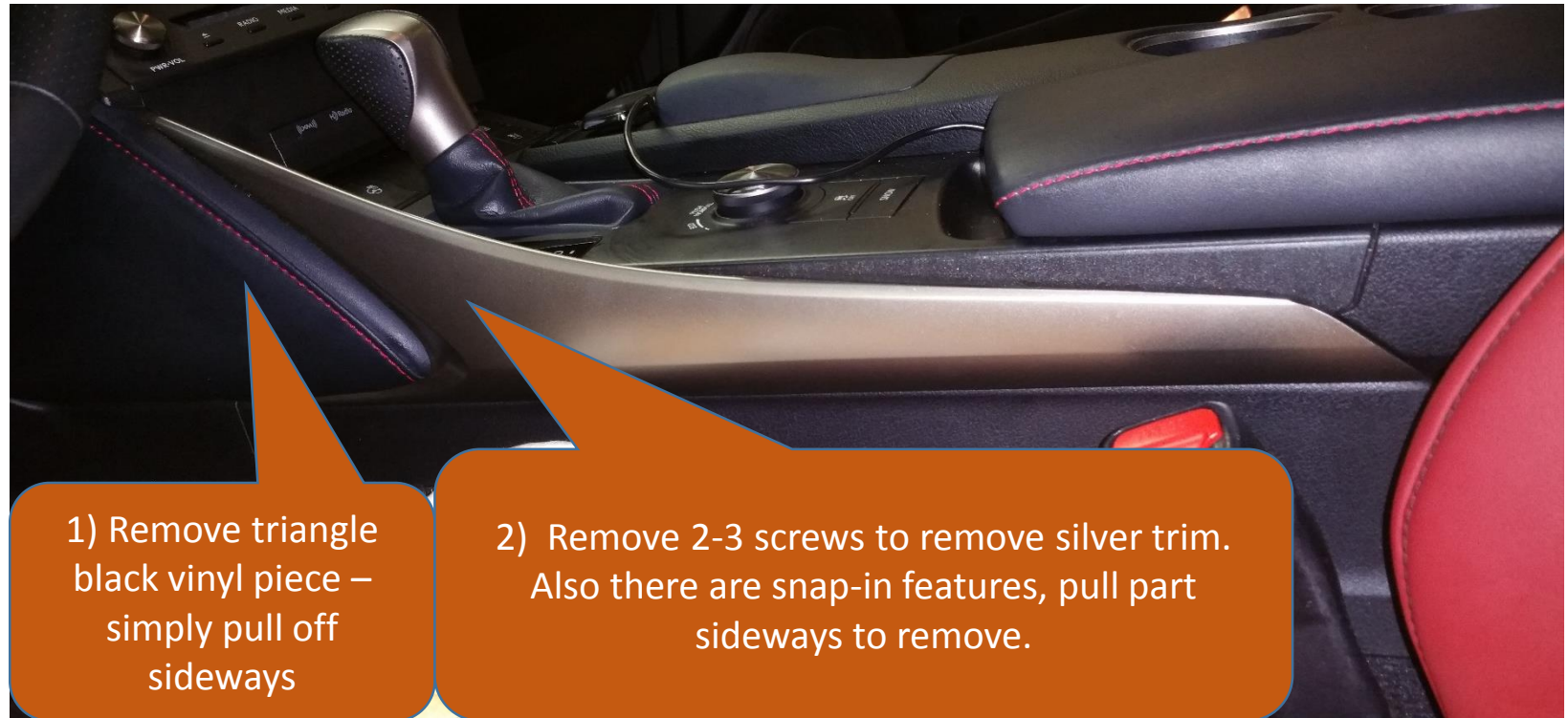

1) Remove triangle black vinyl piece – simply pull off sideways

2) Remove 2-3 screws to remove silver trim. Also there are snap-in features, pull part sideways to remove.

Before removal, note which areas of trim are exposed. Take special note at upper small visible areas – these are tricky to get wrapped with no exposed cut trim edges.

1) Remove airbag, by first unsnapping (2) thin trim pieces about 1"x2" on backside/underside of steering wheel housing.

2) Behind 2 removed panels, find (3) raw ends of round wire. Each of these can be slid across the slot it protrudes from, each wire releases 1/3 of the airbag assembly.

3) Photo below shows airbag removed and set above wheel (no need to unwire airbag)

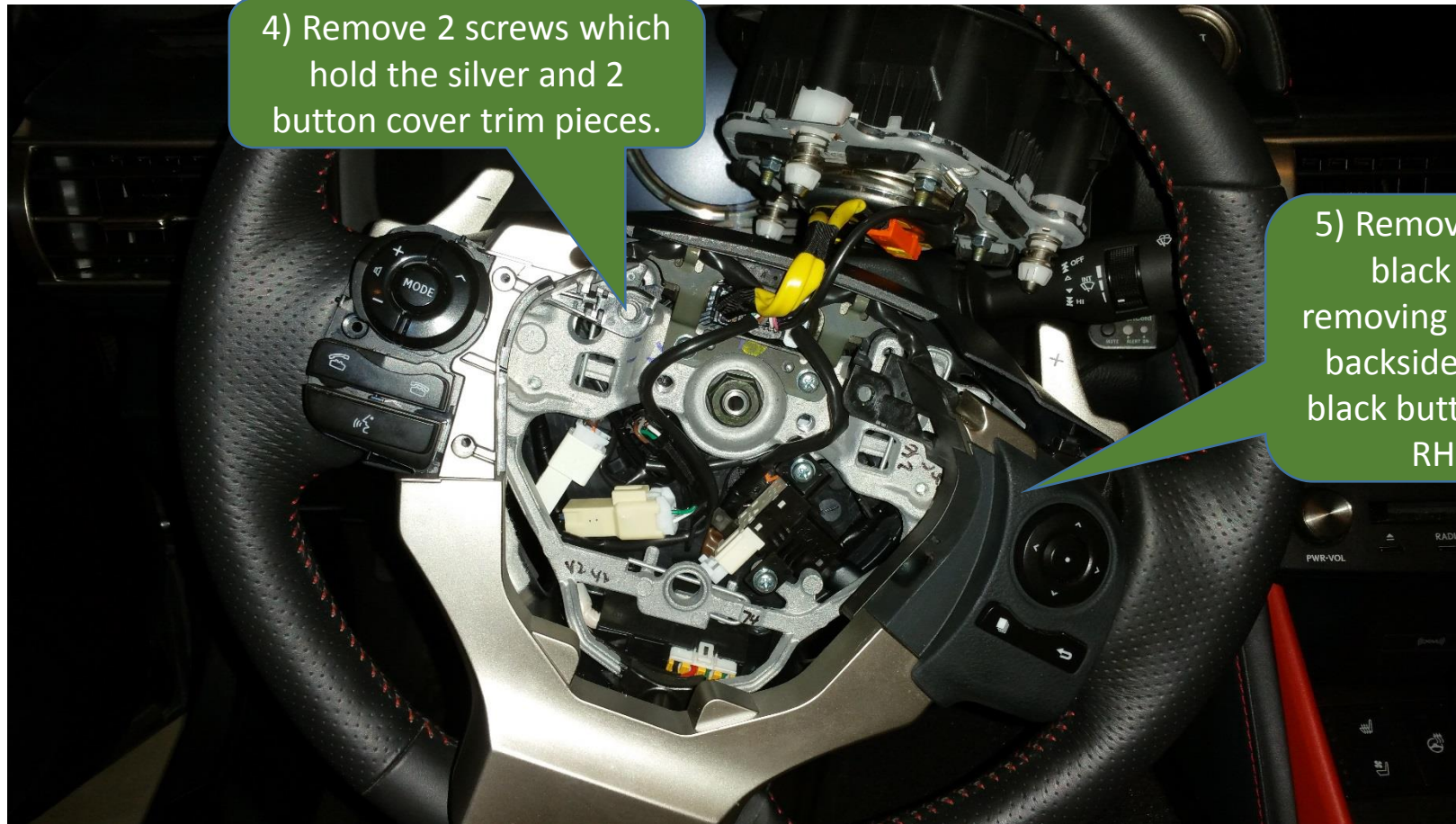

4) Remove 2 screws which hold the silver and 2 button cover trim pieces.

5) Remove (2) button-cover black trim pieces, by removing 3 screws each from backside. Photo shows LH black button cover removed, RH still in place