

TECHNICAL INSTRUCTIONS

FOR

SAFETY RECALL DLA

FRONT WIPER ARM NUTS

CERTAIN

2006 – EARLY 2012 MODEL YEAR IS250, IS350

2008 – 2011 MODEL YEAR IS F

2010 – EARLY 2012 MODEL YEAR IS 250C, IS350C

I. OPERATION FLOW CHART

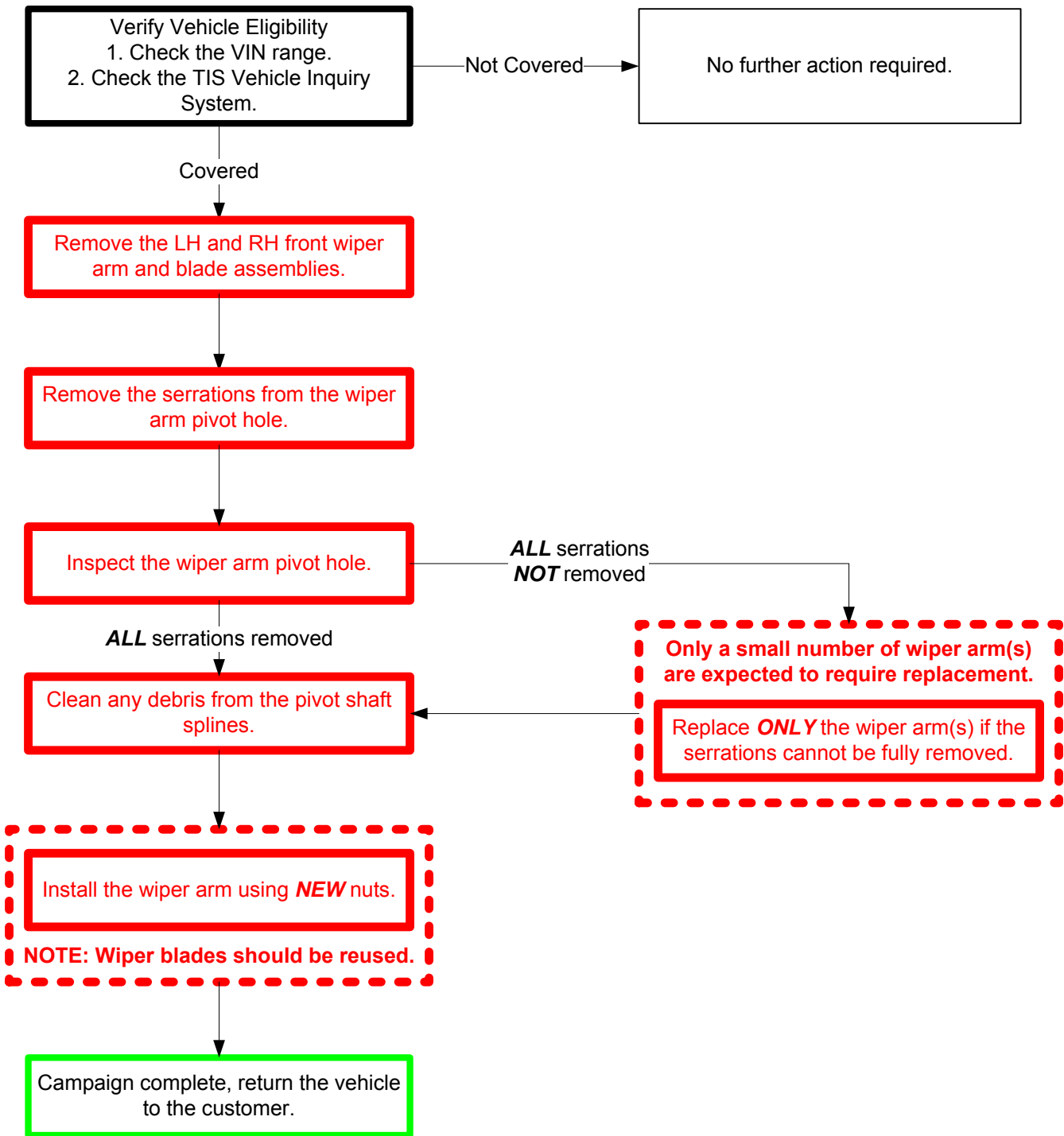

II. IDENTIFICATION OF AFFECTED VEHICLES

A. COVERED VIN RANGE

Model	WMI	Year	VIN Range		Model	WMI	Year	VIN Range	
			VDS	Range				VDS	Range
IS250	JTH	2006	BK262	2000010-2021611	IS250C	JTH	2010	FF2C2	2500062-2514637
				5000018-5025772				2011	FF2C2
		2007	BK262	2021159-2058542				2012	FF2C2
				5025773-5050845			2006	BE262	2000000-2007084
		2008	BK262	2057792-2082748					5000018-5011869
				5050849-5086447			2007	BE262	2006942-2013016
		2009	BK262	2081667-2094281					5011870-5017246
				5086449-5107246			2008	BE262	2011547-2016302
		2010	BF5C2	2094264-2100284					5017247-5021818
				5107249-5129060			2009	BE262	2016235-2017388
		2011	BF5C2	2100247-2101920					5021000-5023468
				5129064-5152530			2010	BE5C2	2017389-2017712
2012	BF5C2	2101792-2102727	5023469-5025230						
IS250 AWD	JTH	2006	CK262	2000003-2008675	IS350 AWD	JTH	2011	CE5C2	5000104-5001879
				5000013-5007908				2010	FE2C2
		2007	CK262	2008542-2019897	IS350C	JTH	2011		
				5007909-5015612			2012	FE2C2	2507139-2507504
		2008	CK262	2019898-2027723			2008	BP262	5000156-5004828
				5015613-5027611	2009	BP262			5002981-5006738
		2009	CK262	2027724-2032532			2010	BP5C2	5006743-5008082
				5027613-5036006	2011	BP5C2			5008017-5009599
		2010	CF5C2	2032534-2034898					
				5036007-5044700					
		2011	CF5C2	2034395-2035500					
				5044623-5051264					
2012	CF5C2	2035323-2035942							

NOTE:

- Check the TIS Vehicle Inquiry System to confirm the VIN is involved in this Safety Recall, and that the campaign has not already been completed prior to dealer shipment or by another dealer.
- TMS warranty will not reimburse dealers for repairs conducted on vehicles that are not affected or were completed by another dealer.

III. PREPARATION

A. PARTS

The large majority of vehicle will only require the nut kit.

Model	Part Number	Part Description	Quantity
All	04002-64153	Front Wiper Nut Kit*	1
*The kit above includes the following part.			
-	90182-10006	Nut (for front wiper arm)	2

Only a small number of vehicles will require the replacement of the wiper arm(s). Follow these instructions to determine if replacement is necessary. If it is identified that a wiper arm requires replacement, follow the MAC process outlined in the dealer letter for parts ordering. Parts will be placed on recovery and subject to claim debit for inappropriate replacement.

Model	Part Number	Part Description	Quantity
IS250, IS350	85211-53080	Arm, FR Wiper, RH	1
IS250C, IS350C	85221-53080	Arm, FR Wiper, LH	1
IS F	85211-53070	Arm, FR Wiper, RH	1
	85221-53070	Arm, FR Wiper, LH	1

B. TOOLS & EQUIPMENT

- Standard hand tools
- Torque wrench
- Wire brush
- Black marker

Campaign Tools – These tools are provided to the dealership.

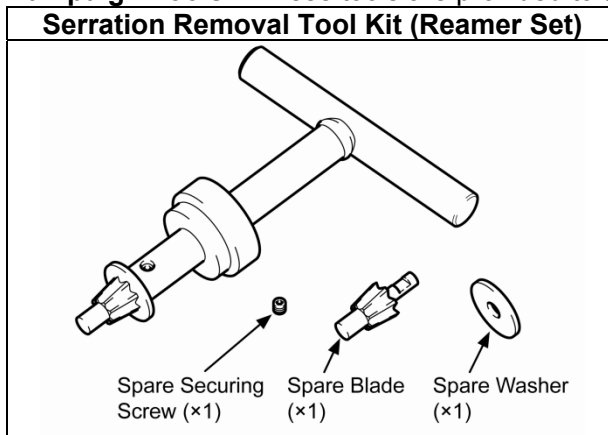

NOTE:

- The reamer is specifically designed for the models covered by this campaign, **DO NOT** use on other models.
- Each blade can be used on approximately 360 vehicles.
- When replacing the blade, press the blade toward the handle until there is no gap, then tighten the set screw.
- **These tools CANNOT be ordered through the parts or tools system. If additional tools are needed, contact your area representative.**

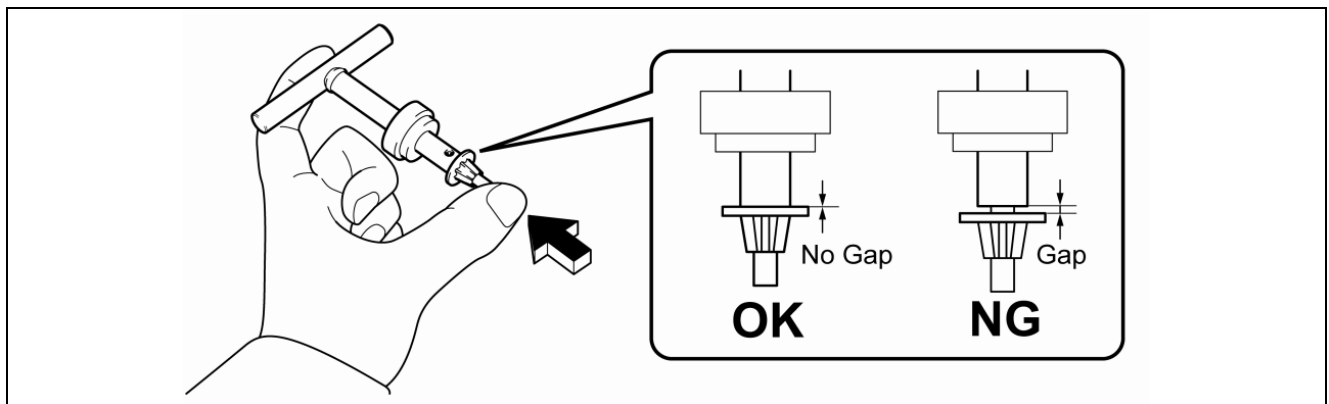

IV. BACKGROUND

Each wiper arm is installed onto a pivot shaft, which is linked to the wiper motor mechanism, by an installation nut (wiper arm nut). The wiper arm nut may not have been tightened sufficiently due to high friction between the nut and the wiper arm. Under certain usage conditions, such as a buildup of heavy snow on the windshield, one or both of the wipers could become inoperative. Inoperative wiper arms could reduce driver visibility and increase the risk of a crash.

V. COMPONENTS

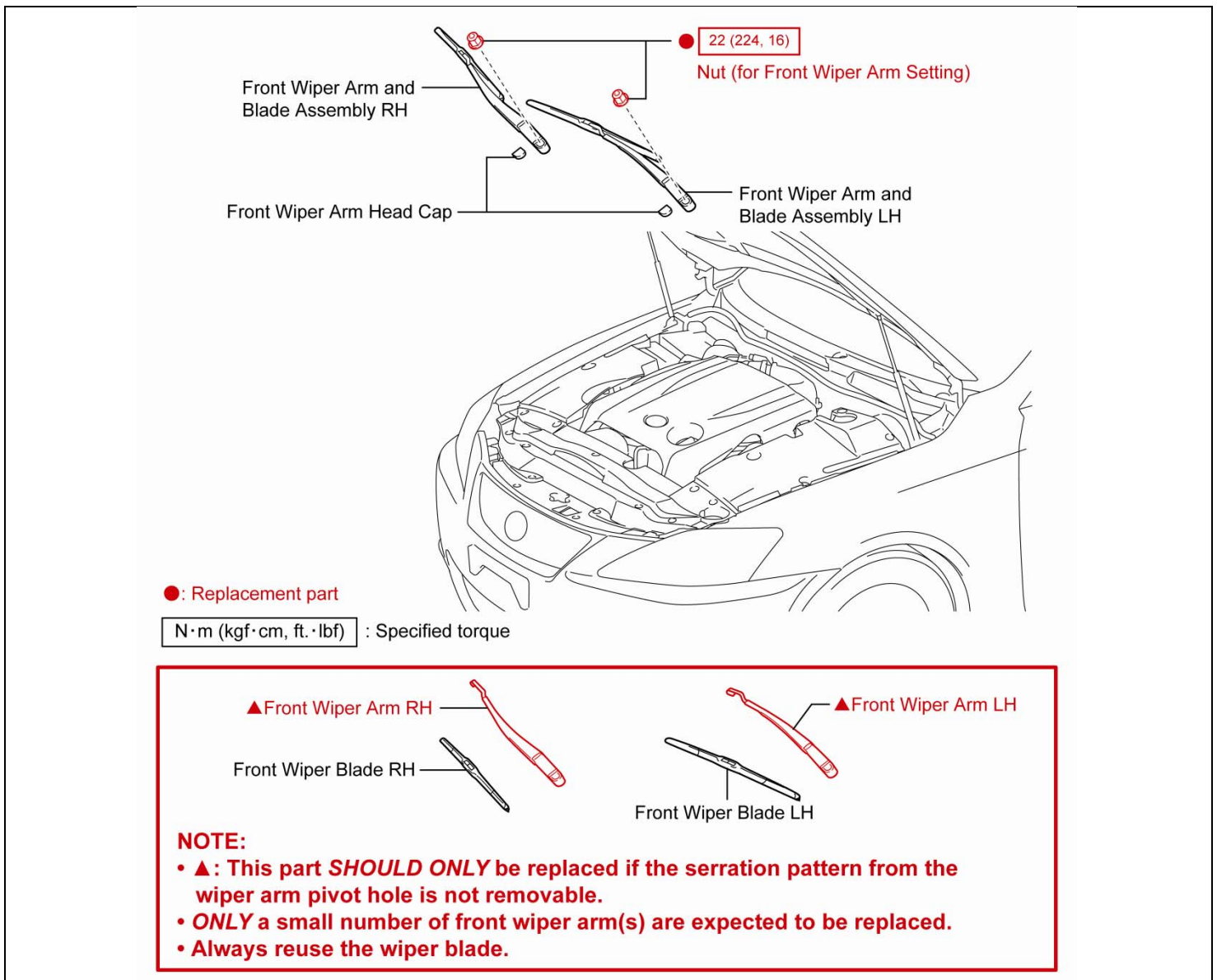

VI. WORK PROCEDURE

1. REMOVE BOTH FRONT WIPER ARM ASSEMBLIES AS OUTLINED IN THE REPAIR MANUAL ON TIS
[Wiper Arm Removal](#)

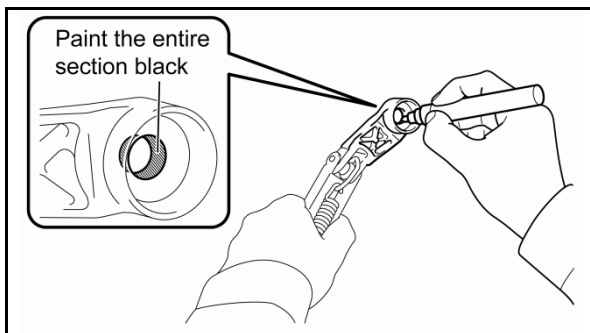
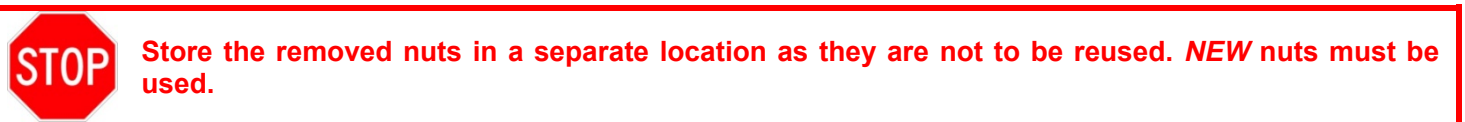

2. PAINT OUT THE SERRATION PATTERN

- a) Use a black marker to color in the entire wiper arm pivot hole. Confirm there are no gaps before proceeding.

NOTE: The coloring is critical in the next steps when determining the condition of the wiper arms.

3. REMOVE THE SERRATION PATTERN FROM THE WIPER ARM PIVOT HOLE

- a) Place a shop cloth on a workbench, then support the wiper arm on the bench.
- b) Insert the tip of the reamer into the wiper arm pivot hole and set the reamer guide.
- c) **Apply a strong downward force to the reamer and twist the tool 2-3 times or until it feels like no more metal can be removed from the pivot hole.**

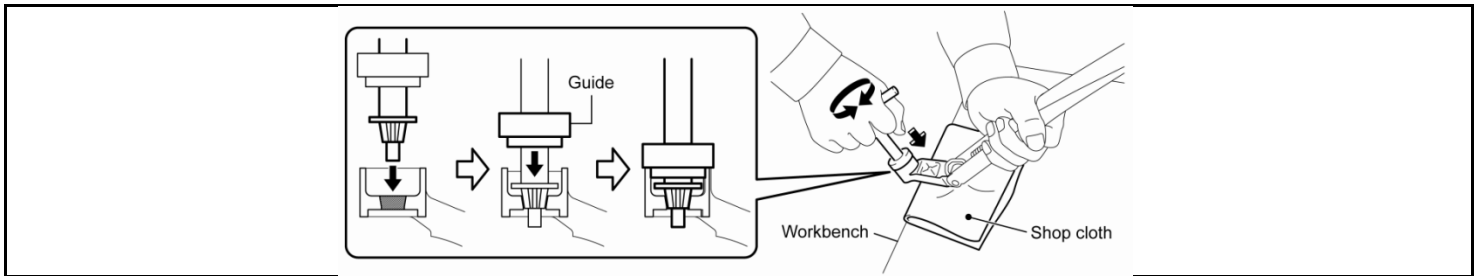

- **Maintain a position that prevents the tip of the reamer from touching the workbench.**
- **DO NOT support the wiper arm by the wiper blade.**
- **The reamer can be twisted in either or both directions.**
- **The reamer guide MUST be in place to prevent excessive side-to-side movement of the reamer.**
- **The reamer has a stopper that controls the correct reaming correction limit.**

NG Holding the wiper blade

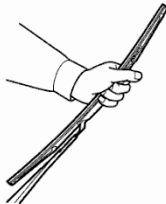

NG Holding it with both hands

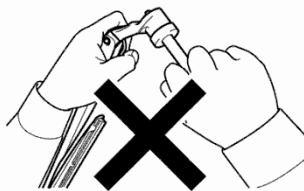

NG The tip of the serration removal tool touching the work bench

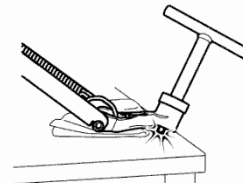

- d) Check the wiper arm pivot hole and determine the condition using the table below.

		OK	NG
Condition Example			
		<p>ALL coloring and ALL serrations have been removed.</p>	<p>ALL coloring and ALL serrations HAVE NOT been removed.</p>
Action Required		<p>OK 1. Proceed to step 4. CLEAN THE WIPER COMPONENTS</p>	<p>NG</p> <ol style="list-style-type: none"> 1. Confirm condition by attempting to remove the serration pattern multiple times. 2. Obtain a new replacement arm if the serration is still not fully removed. 3. Proceed to step 4. CLEAN THE WIPER COMPONENTS

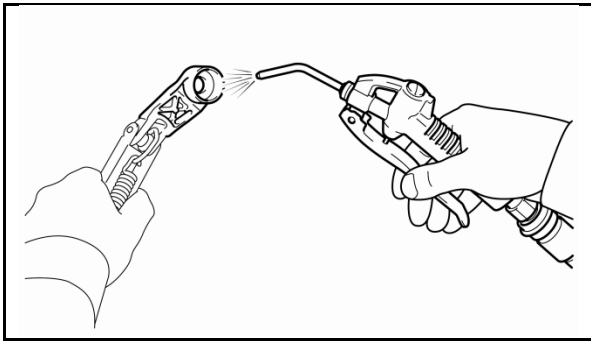

4. CLEAN THE WIPER COMPONENTS

- a) Use an air gun to remove any debris from the pivot hole and wiper arm.

NOTE: Wear protective goggles.

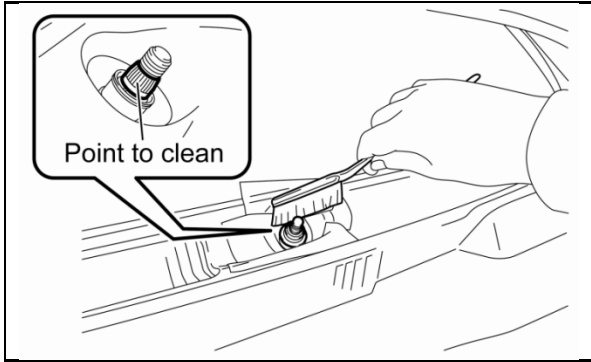

- b) Protect the cowl around the pivot shafts with tape or shop cloth.

- c) Using a wire brush, clean the splines of the pivot shafts to prevent wiper arm slippage.

- d) Use an air gun to remove any debris from the pivot shafts and surrounding area.

NOTE: Wear protective goggles.



The splines **MUST** be cleaned to prevent wiper arm slippage.

OK

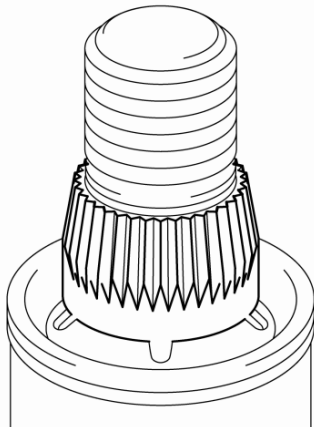

NG

Adhesion of foreign substances →

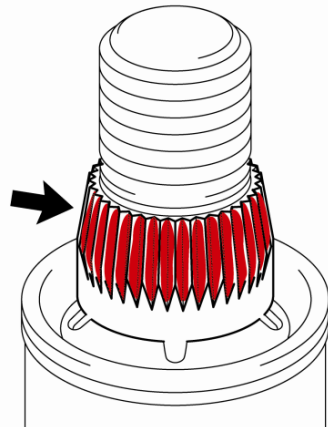

5. INSTALL THE WIPER ARM AND BLADE ASSEMBLY

- a) Install the wiper arm with a **NEW** wiper arm nut as outlined in the repair manual on TIS.

[Wiper Arm Installation](#)

Torque: 16ft. lbf (22N·m)



NEW wiper arm nuts **MUST** be used when installing the wiper arm and blade assembly.

◀ VERIFY REPAIR QUALITY ▶

- Confirm sufficient force is applied when using the reamer
- Confirm the reamer is used multiple times when confirming the condition
- Confirm the pivot shaft splines are cleaned before reinstalling the wiper arms
- Confirm **NEW** wiper arm nuts are used when reinstalling the wiper arms

If you have any questions regarding this update, please contact your area representative.

VII. APPENDIX

A. CAMPAIGN DESIGNATION DECODER

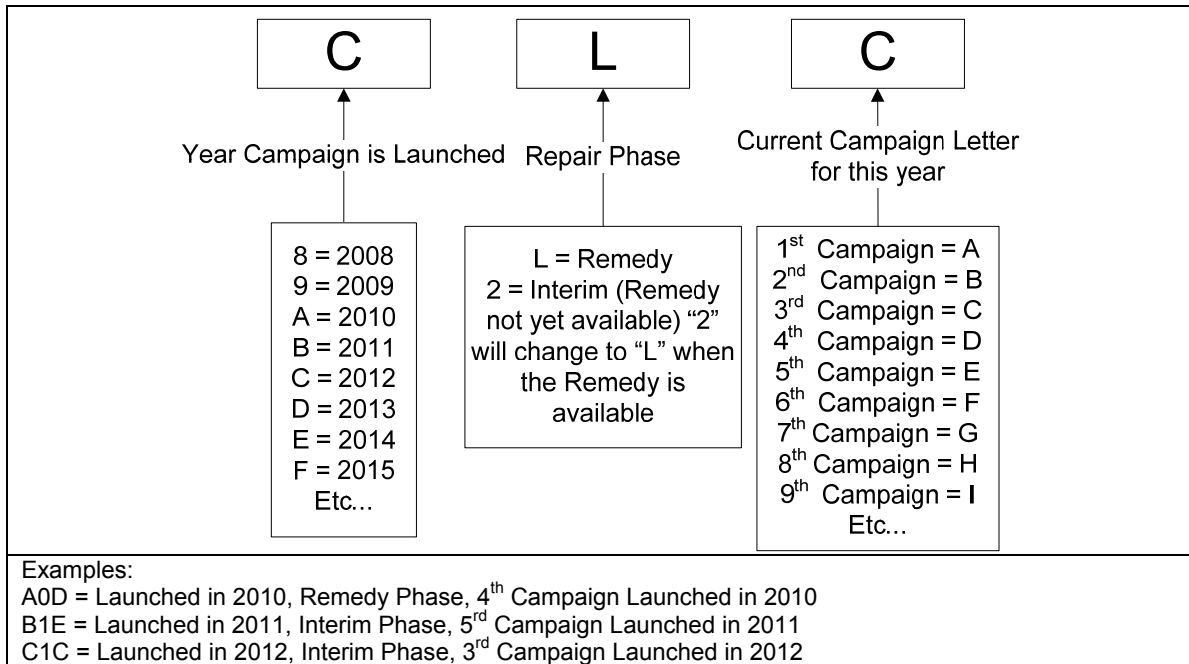

B. CAMPAIGN PARTS DISPOSAL

As required by Federal Regulations, please make sure all campaign parts (original parts) removed from the vehicle are disposed of in a manner in which they will not be reused, ***unless requested for parts recovery return.***