

## 4-3. Do-it-yourself maintenance

### Air conditioning filter

The air conditioning filter must be cleaned or changed regularly to maintain air conditioning efficiency.

#### n Removal method

**STEP 1** Turn the "POWER" switch off.

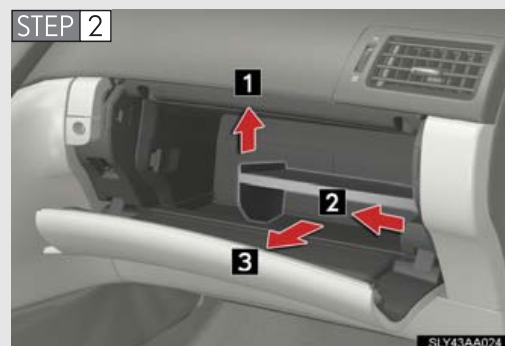

Open the glove box. Lift and remove the partition.

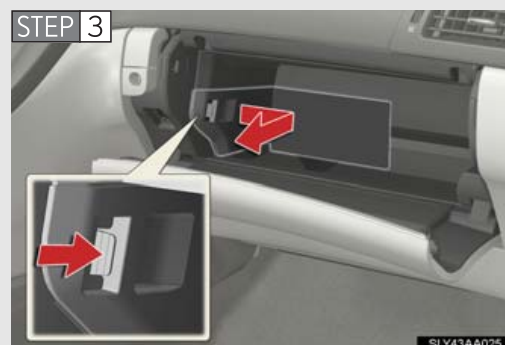

Remove the glove box cover.

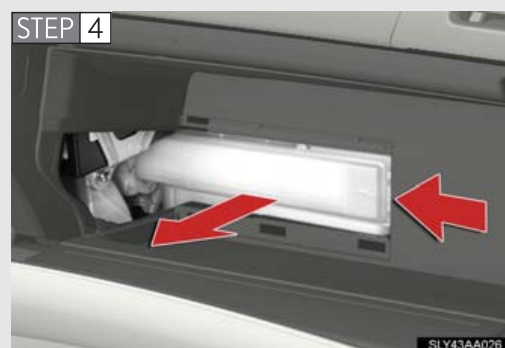

Remove the filter cover.

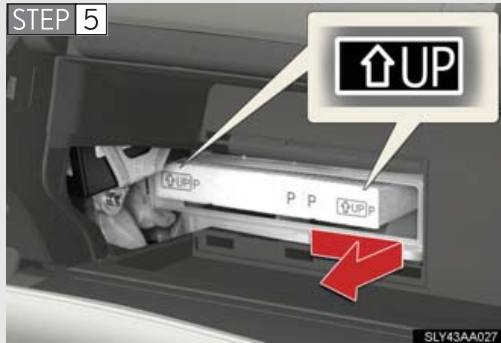

Slide and pull out the filter. Replace the filter with a new one.

The “↑UP” mark shown on the filter should be pointing up.

### n Cleaning method

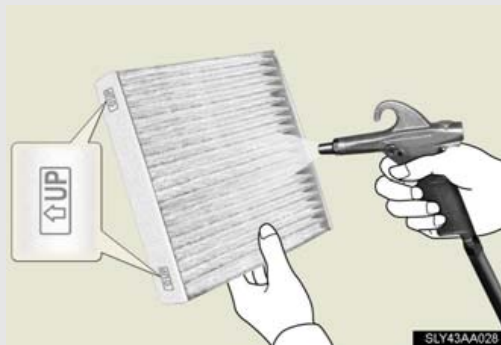

If the filter is dirty, clean by blowing compressed air through the filter from the underside.

Hold the air gun 2 in. (5 cm) from the filter and blow for approximately 2 minutes at 72 psi (500 kPa, 5.0 kgf/cm<sup>2</sup> or bar).

If an air gun is not available, have the filter cleaned by your Lexus dealer.

### n Checking interval

Inspect, clean and replace the air conditioning filter according to the maintenance schedule. In dusty areas or areas with heavy traffic flow, early replacement may be required. (For scheduled maintenance information, please refer to the “Owner’s Manual Supplement” or “Scheduled Maintenance”.)

### n If air flow from the vents decreases dramatically

The filter may be clogged. Check the filter and replace if necessary.

## 4-3. Do-it-yourself maintenance

### NOTICE

#### **n To prevent damage to the system**

- 1** When using the air conditioning system, make sure that a filter is always installed.
- 1** When cleaning the filter, do not clean with water.