

2017 Luxury (stock Crawl)- Added MTS		1 (https://www.clublexus.com/forums/gx-2nd-gen-2010-present/poll-6038-crawl-mts-model-year-trim-upgrade-survey.html)	3.13%
2018 Base - Added Crawl		0	0%
2018 Base - Added Crawl/MTS		0	0%
2018 Premium - Added Crawl		0	0%
2018 Premium - Added Crawl/MTS		0	0%
2018 Luxury - Added Crawl		0	0%
2018 Luxury - Added Crawl/MTS		1 (https://www.clublexus.com/forums/gx-2nd-gen-2010-present/poll-6038-crawl-mts-model-year-trim-upgrade-survey.html)	3.13%
2018 Luxury (stock Crawl)- Added MTS		1 (https://www.clublexus.com/forums/gx-2nd-gen-2010-present/poll-6038-crawl-mts-model-year-trim-upgrade-survey.html)	3.13%

Voters: **32**. You have already voted on this poll

DAC versus Crawl Control

Reply
(<https://www.clublexus.com/forums/newreply.php?do=newreply&noquote=1&p=9899361>)

Page 1 of 148 **1**

2
(<https://www.clublexus.com/forums/gx-2nd-gen-2010-present/859762-dac-versus-crawl-control-2.html>)

3
(<https://www.clublexus.com/forums/gx-2nd-gen-2010-present/859762-dac-versus-crawl-control-3.html>)

4
(<https://www.clublexus.com/forums/gx-2nd-gen-2010-present/859762-dac-versus-crawl-control-4.html>)

Subscribed
(<https://www.clublexus.com/forums/subscription.php?do=removesubscription&t=859762>)

Thread Tools (https://www.clublexus.com/forums/gx-2nd-gen-2010-present/859762-dac-versus-crawl-control.html?nojs=1#goto_threadtools)

Search this Thread (https://www.clublexus.com/forums/gx-2nd-gen-2010-present/859762-dac-versus-crawl-control.html?nojs=1#goto_threadsearch)

Rate Thread (https://www.clublexus.com/forums/gx-2nd-gen-2010-present/859762-dac-versus-crawl-control.html?nojs=1#goto_threadrating)

#1 (<https://www.clublexus.com/forums/gx-2nd-gen-2010-present/859762-dac-versus-crawl-control.html#post9899361>)

⚠ Crawl Control - ADD?

.....If you have trouble... this quote from Coinball may help.

"To get the VSC light to go away (in lieu of making another video), you need to press the Crawl Control on/off button BEFORE clicking the final Exit button in the ABS test. You'll get the warning the CC isn't available unless you're in P or D and 4L (on the cluster display), and you'll be good to go from there."

=====

FAQ for adding Crawl Control and MTS (last updated 10.31.2018)

- MTS and/or Crawl can be added to any model year or trim GX 460
- MTS can be installed by itself - plug and play module swap
- Crawl can be installed by itself - in addition to console switch you need to do a [zero point calibration](https://www.clublexus.com/forums/attachments/gx-2nd-gen-2010-present/473989d1517870509-dac-versus-crawl-control-calibration.pdf) (<https://www.clublexus.com/forums/attachments/gx-2nd-gen-2010-present/473989d1517870509-dac-versus-crawl-control-calibration.pdf>).
- Crawl and MTS can obviously be installed together as well.
- MTS is NOT included with US 460's optioned with Crawl Control but Canadian top tier models include MTS with their Crawl optioned models
- If you don't have adaptive suspension (AVS) or rear air bags AHC on your 460 you will end up with two dummy switches. [Here is an option that Nickk6 did on his.](https://www.clublexus.com/forums/gx-2nd-gen-2010-present/859762-dac-versus-crawl-control-43.html#post10234535) (<https://www.clublexus.com/forums/gx-2nd-gen-2010-present/859762-dac-versus-crawl-control-43.html#post10234535>).

[Part Numbers]

[MTS]
2010-2013
Part Number: [859A1-60020](https://www.oemvehicleparts.com/oem-parts/lexus-computer-driving-su-859a160020) (<https://www.oemvehicleparts.com/oem-parts/lexus-computer-driving-su-859a160020>).
Part Name: Computer, Driving Support Switch Control

2014+
Part Number: [859A1-60040](https://www.oemvehicleparts.com/oem-parts/lexus-computer-driving-su-859a160040) (<https://www.oemvehicleparts.com/oem-parts/lexus-computer-driving-su-859a160040>).

06-17-17, 01:59 PM

Acrad35751
(<https://www.clublexus.com/forums/members/296923-acrad35751.html>)
Lexus Champion



(<https://www.clublexus.com/forums/members/296923-acrad35751.html>)

Join Date: Mar 2017
Location: WA
Posts: 3,418
Thanks: 599
(https://www.clublexus.com/forums/post_thanks.php?do=findthanks_user_gave&u=296923)
Thanked 485 Times in 395 Posts
(https://www.clublexus.com/forums/post_thanks.php?do=findthanks&u=296923)

Part Name: Computer, Driving Support Switch Control

[Crawl Control]

2010-2019

Part Number: 84970-60070 (<https://www.oemvehicleparts.com/oem-parts/lexus-combo-switch-8497060070>)

Part Name: Combo Switch

If you buy parts through oemvehicleparts.com use this promo code to get 50% off shipping: CLUBLEXUS
No Sales Tax either.

[Calibration Guide Download \(https://www.clublexus.com/forums/attachments/gx-2nd-gen-2010-present/473989d1517870509-dac-versus-crawl-control-calibration.pdf\)](https://www.clublexus.com/forums/attachments/gx-2nd-gen-2010-present/473989d1517870509-dac-versus-crawl-control-calibration.pdf)

[Detailed Removal of dash components including the knee airbag / used for Remote start Install \(https://www.clublexus.com/forums/attachments/gx-2nd-gen-2010-present/401606d1483228918-gx460-remote-engine-start-ac6a39f2.pdf\)](https://www.clublexus.com/forums/attachments/gx-2nd-gen-2010-present/401606d1483228918-gx460-remote-engine-start-ac6a39f2.pdf) (Do not do Fig 1-2, 1-4 or 1-5)

2012 GX460 Crawl Control Reset



(Thanks coinball)

[Zero Point OBD method example on FJ \(https://www.clublexus.com/forums/gx-2nd-gen-2010-present/859762-dac-versus-crawl-control-9.html#post10123190\)](https://www.clublexus.com/forums/gx-2nd-gen-2010-present/859762-dac-versus-crawl-control-9.html#post10123190) . / [Momentary contact button that might make this method easier \(https://www.clublexus.com/forums/gx-2nd-gen-2010-present/859762-dac-versus-crawl-control-21.html#post10130361\)](https://www.clublexus.com/forums/gx-2nd-gen-2010-present/859762-dac-versus-crawl-control-21.html#post10130361)

[Techstream Zero Point Calibration screenshots \(https://www.clublexus.com/forums/gx-2nd-gen-2010-present/859762-dac-versus-crawl-control-2.html#post10095237\)](https://www.clublexus.com/forums/gx-2nd-gen-2010-present/859762-dac-versus-crawl-control-2.html#post10095237)

[Glovebox disassembly #1 \(https://www.clublexus.com/forums/gx-2nd-gen-2010-present/859762-dac-versus-crawl-control-2.html#post10095370\)](https://www.clublexus.com/forums/gx-2nd-gen-2010-present/859762-dac-versus-crawl-control-2.html#post10095370)

[Glovebox disassembly #2 \(https://www.clublexus.com/forums/gx-2nd-gen-2010-present/859762-dac-versus-crawl-control-3.html#post10096164\)](https://www.clublexus.com/forums/gx-2nd-gen-2010-present/859762-dac-versus-crawl-control-3.html#post10096164) / Driver support computer location

[Glovebox disassembly #3 \(https://www.clublexus.com/forums/gx-2nd-gen-2010-present/859762-dac-versus-crawl-control-9.html#post10123166\)](https://www.clublexus.com/forums/gx-2nd-gen-2010-present/859762-dac-versus-crawl-control-9.html#post10123166)

[Wiring and removal of for console switch and Driver Support Computer \(https://www.clublexus.com/forums/gx-2nd-gen-2010-present/859762-dac-versus-crawl-control-6.html#post10118821\)](https://www.clublexus.com/forums/gx-2nd-gen-2010-present/859762-dac-versus-crawl-control-6.html#post10118821)

[Console Switch suggestions \(https://www.clublexus.com/forums/gx-2nd-gen-2010-present/859762-dac-versus-crawl-control-7.html#post10122384\)](https://www.clublexus.com/forums/gx-2nd-gen-2010-present/859762-dac-versus-crawl-control-7.html#post10122384)

[Operational - Crawl Control \(https://www.clublexus.com/forums/gx-2nd-gen-2010-present/859762-dac-versus-crawl-control-7.html#post10122475\)](https://www.clublexus.com/forums/gx-2nd-gen-2010-present/859762-dac-versus-crawl-control-7.html#post10122475)

[Operational - MTS \(Multi Terrain Select\) \(https://www.clublexus.com/forums/gx-2nd-gen-2010-present/859762-dac-versus-crawl-control-8.html#post10123035\)](https://www.clublexus.com/forums/gx-2nd-gen-2010-present/859762-dac-versus-crawl-control-8.html#post10123035)



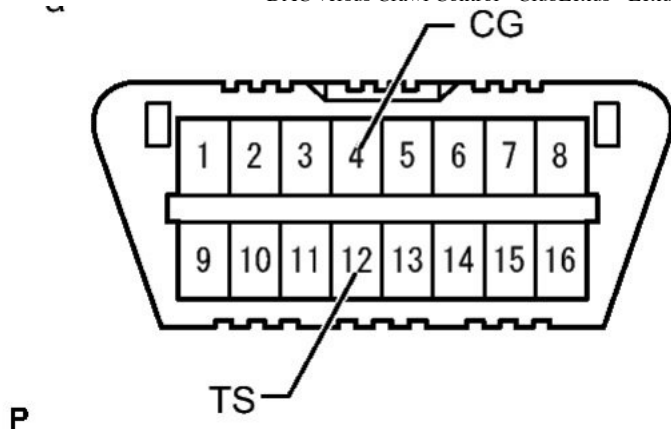

P

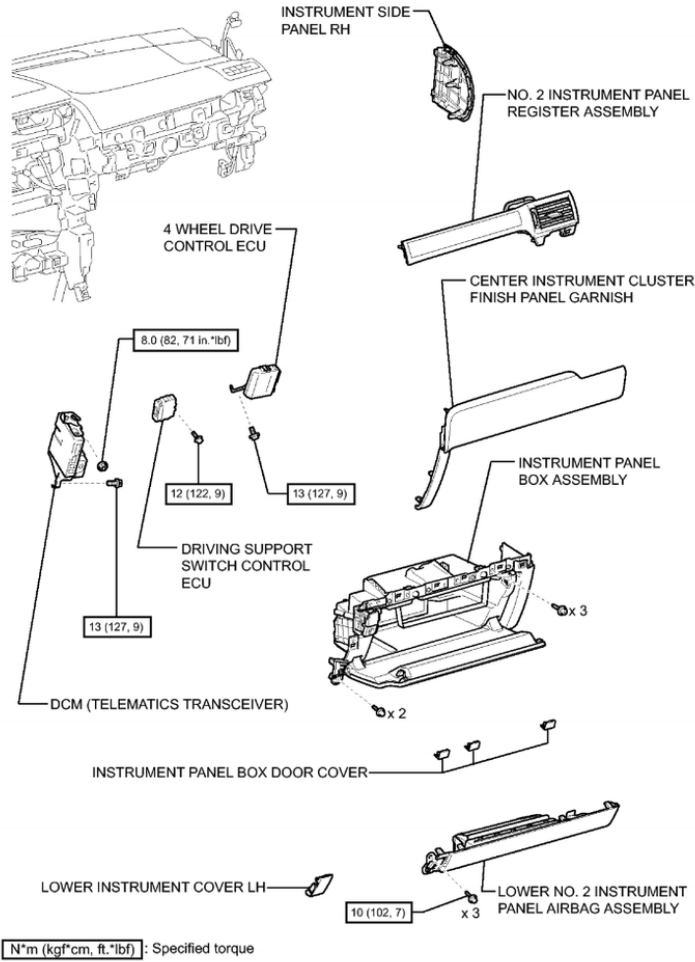

[Return to the Search page](#)

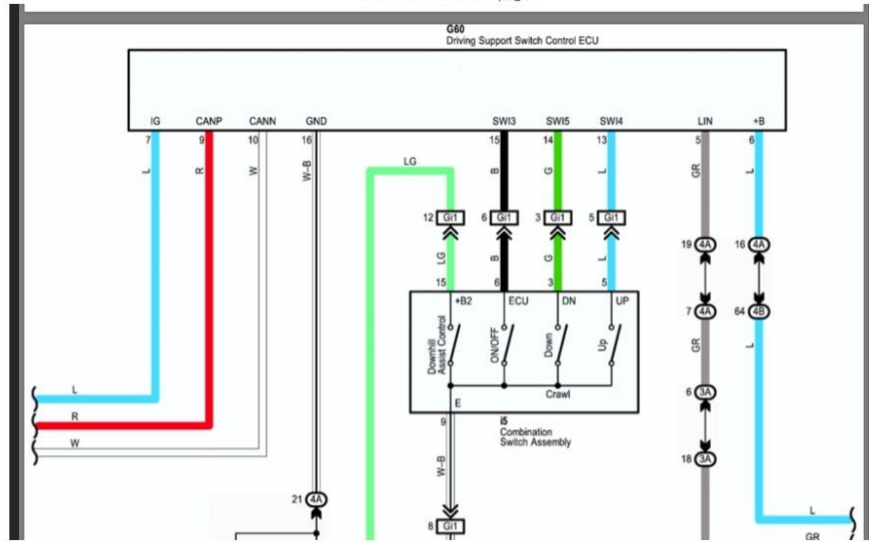

[Internal pics of a 080 switch which lacks crawl function](#)
 (<https://www.clublexus.com/forums/members/296923-acrad35751.html>).

[4Runner conversion \(one known conversion\)](#) (<http://tctmagazine.net/spring-2016/2015-4runner-sr5-crawl-control-retrofit>).

[FJ Conversion \(no known conversions\)](#) (<https://www.fjcruserforums.com/forums/4x4-off-road-tech/484073-crawl-control-parts-list.html>).

•••••If you have trouble... this quote from Coinball may help.

"To get the VSC light to go away (in lieu of making another video), you need to press the Crawl Control on/off button BEFORE clicking the final Exit button in the ABS test. You'll get the warning the CC isn't available unless you're in P or D and 4L (on the cluster display), and you'll be good to go from there."

'12 GX 460 Premium (Fire Agate Pearl) - 53k miles / Crawl / MTS / Budbuilt / FAQ- lexusgxr.com
 (<http://lexusgxr.com>).

Last edited by [Acrad35751](https://www.clublexus.com/forums/posthistory.php?p=9899361) (<https://www.clublexus.com/forums/posthistory.php?p=9899361>); 10-31-18 at 02:05 PM.

[Edit](https://www.clublexus.com/forums/editpost.php?do=editpost&p=9899361) (<https://www.clublexus.com/forums/editpost.php?do=editpost&p=9899361>)

[Quote](https://www.clublexus.com/forums/newreply.php?do=newreply&p=9899361) (<https://www.clublexus.com/forums/newreply.php?do=newreply&p=9899361>)

[Multi Quote](https://www.clublexus.com/forums/newreply.php?do=newreply&p=9899361) (<https://www.clublexus.com/forums/newreply.php?do=newreply&p=9899361>)

[Quick Reply](https://www.clublexus.com/forums/newreply.php?do=newreply&p=9899361) (<https://www.clublexus.com/forums/newreply.php?do=newreply&p=9899361>)

06-18-17, 01:34 PM

[Acrad35751](https://www.clublexus.com/forums/members/296923-acrad35751.html)
 (<https://www.clublexus.com/forums/members/296923-acrad35751.html>)
 Lexus Champion

#2 (<https://www.clublexus.com/forums/gx-2nd-gen-2010-present/859762-dac-versus-crawl-control.html#post9899948>).

2016 Toyota Tacoma - Demonstrating Crawl Control