

AIRBAG SYSTEM > GENERAL

OUTLINE

- a. The Supplemental Restraint System (SRS) driver and front passenger airbags are used as supplements to the seat belts to help to reduce the shocks to the head and chest of the driver or front passenger in the event of a frontal impact collision.
- b. The SRS knee airbag is used as a supplement to the seat belt to help to reduce the shock to the knees of the driver and front passenger in the event of a frontal impact collision.
- c. The SRS side airbags are used during a side collision to help reduce the impact to the chests of the driver, front passenger and passengers in the rear seats.
- d. The SRS curtain shield airbags are used in the event of a side or side rear collision to help reduce the impact to the head of the front passenger or rear passenger.

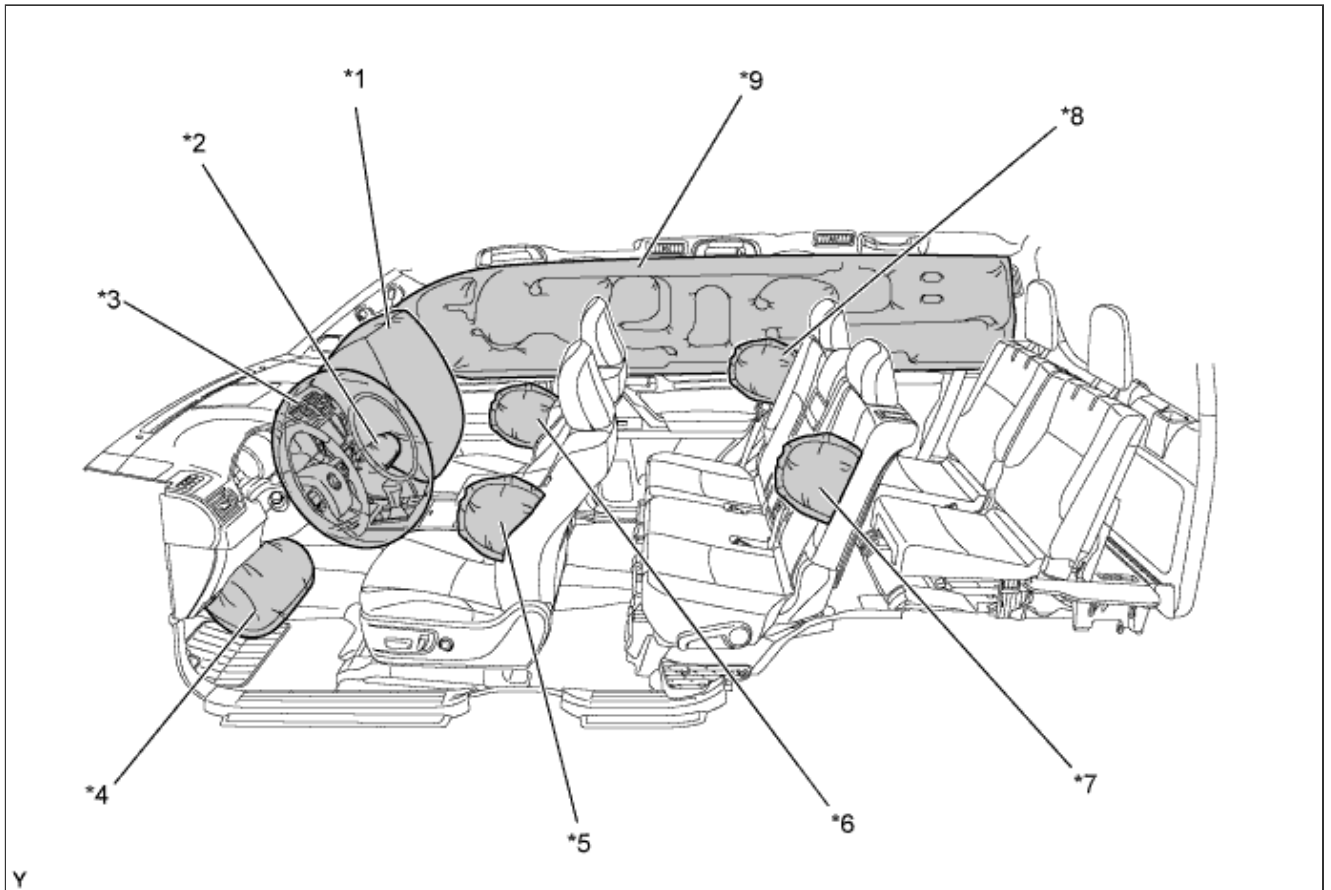

Text in Illustration

*1	SRS Front Passenger Airbag	*2	SRS Front Passenger Knee Airbag
*3	SRS Driver Airbag	*4	SRS Driver Knee Airbag
*5	SRS Side Airbag LH	*6	SRS Side Airbag RH
*7	SRS Rear Side Airbag LH	*8	SRS Rear Side Airbag RH

*9	SRS Curtain Shield Airbag	-	-
----	---------------------------	---	---