

# REAR BUMPER COMPONENTS

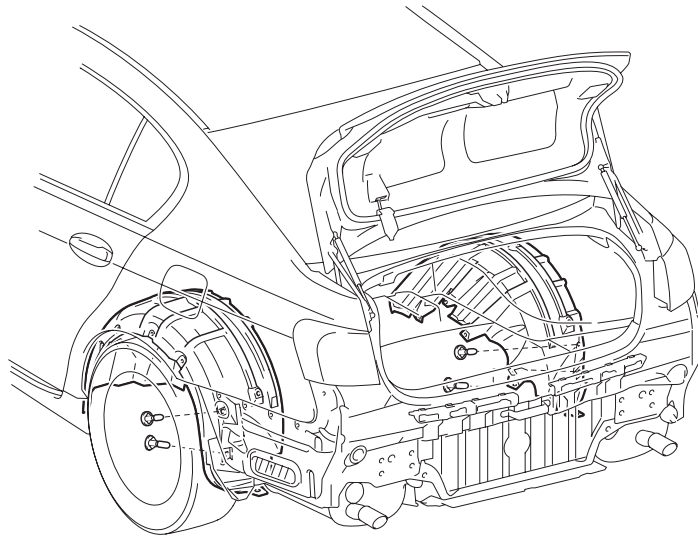

REAR BUMPER NO. 2 SIDE SUPPORT RH

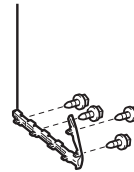

REAR BUMPER RETAINER UPPER RH



REAR BUMPER BAR

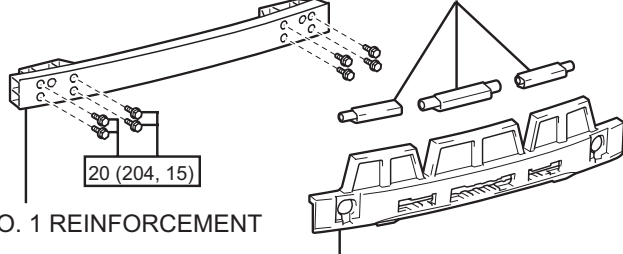

REAR BUMPER RETAINER UPPER LH

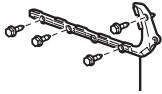

REAR BUMPER NO. 2 SIDE SUPPORT LH

REAR BUMPER NO. 1 REINFORCEMENT

20 (204, 15)

REAR BUMPER ENERGY ABSORBER

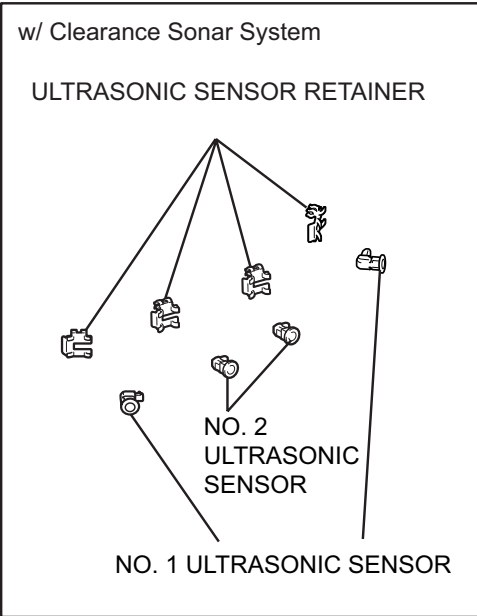

REAR BUMPER NO. 1 PLATE

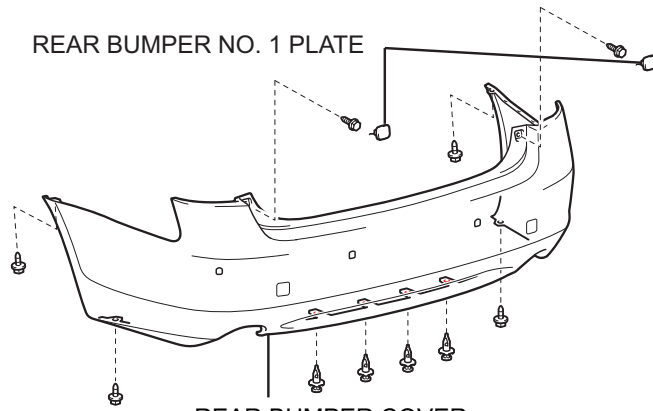

REAR BUMPER COVER

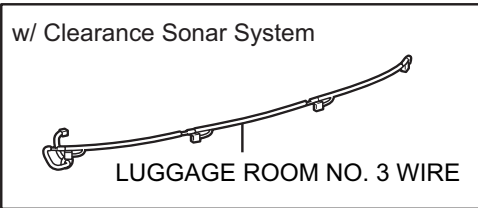

P N\*m (kgf\*cm, ft.\*lbf): Specified torque

ET

## REMOVAL

1. **DISCONNECT CABLE FROM NEGATIVE BATTERY TERMINAL**

### CAUTION:

Wait at least 90 seconds after disconnecting the cable from the negative (-) battery terminal to prevent airbag and seat belt pretensioner activation.

2. **REMOVE REAR BUMPER NO. 1 PLATE**

- (a) Using a screwdriver, remove the 2 bumper plates.

### HINT:

Tape the screwdriver tip before use.

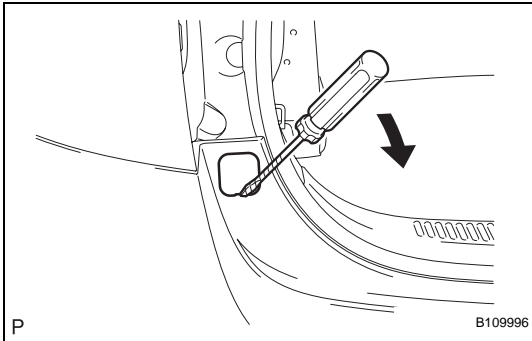

3. **REMOVE REAR BUMPER COVER**

- (a) Remove the 4 clips and 6 screws.

### HINT:

Put protective tape under the quarter panel.

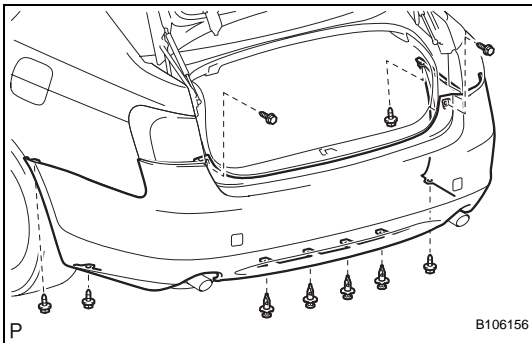

- (b) Pull the bumper cover to detach the 7 claws on the LH side.
- (c) Pull the bumper cover to detach the 7 claws on the RH side.
- (d) w/ Clearance sonar system:  
Disconnect the 4 ultrasonic sensor connectors.
- (e) Remove the bumper cover.

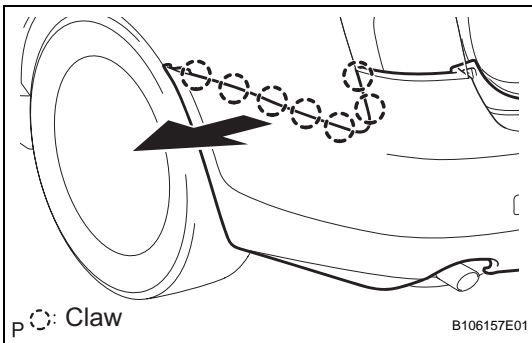

4. **REMOVE REAR BUMPER ENERGY ABSORBER**

- (a) Remove the energy absorber.

5. **REMOVE REAR BUMPER BAR**

- (a) Remove the 3 bumper bars.

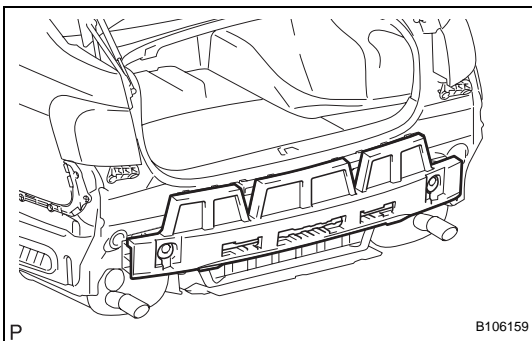

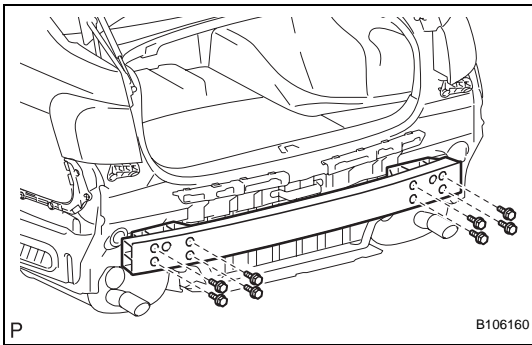

- 6. REMOVE REAR BUMPER NO. 1 REINFORCEMENT**  
 (a) Remove the 8 bolts and reinforcement.

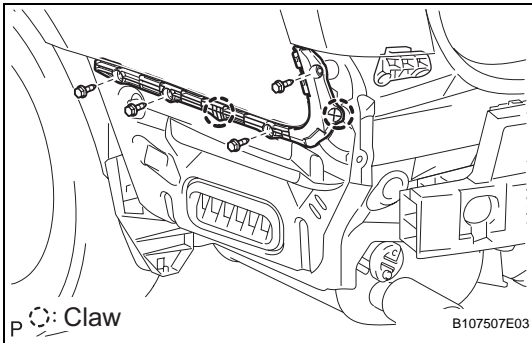

- 7. REMOVE REAR BUMPER NO. 2 SIDE SUPPORT LH**  
 (a) Remove the 4 screws and detach the 2 claws to remove the side support.

- 8. REMOVE REAR BUMPER NO. 2 SIDE SUPPORT RH**  
 HINT:  
 Use the same procedures described for the LH side.

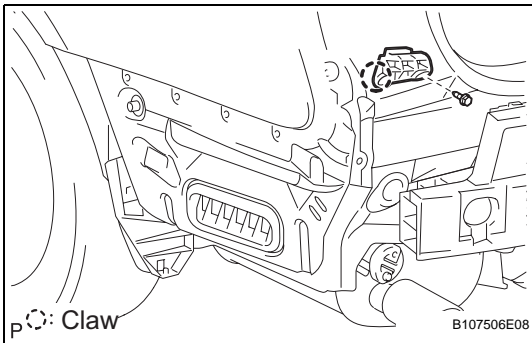

- 9. REMOVE REAR BUMPER RETAINER UPPER LH**  
 (a) Remove the screw and detach the claw to remove the retainer.

- 10. REMOVE REAR BUMPER RETAINER UPPER RH**  
 HINT:  
 Use the same procedures described for the LH side.

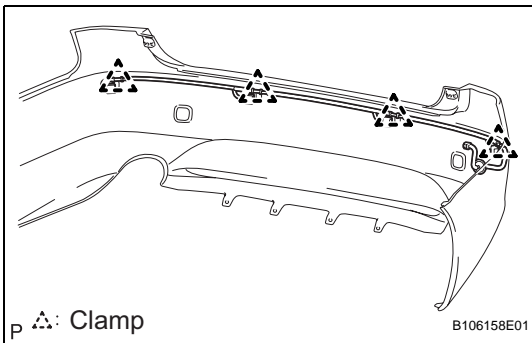

## DISASSEMBLY

- 1. REMOVE LUGGAGE ROOM NO. 3 WIRE (w/ Clearance Sonar System)**  
 (a) Detach the 4 clamps and remove the wire.
- 2. REMOVE NO. 1 ULTRASONIC SENSOR (w/ Clearance Sonar System) (See page [PM-107](#))**
- 3. REMOVE NO. 2 ULTRASONIC SENSOR (w/ Clearance Sonar System) (See page [PM-106](#))**

## REASSEMBLY

1. **INSTALL NO. 1 ULTRASONIC SENSOR (w/ Clearance Sonar System)** (See page [PM-108](#))
2. **INSTALL NO. 2 ULTRASONIC SENSOR (w/ Clearance Sonar System)** (See page [PM-108](#))
3. **INSTALL LUGGAGE ROOM NO. 3 WIRE (w/ Clearance Sonar System)**
  - (a) Attach the 4 clamps to install the wire.

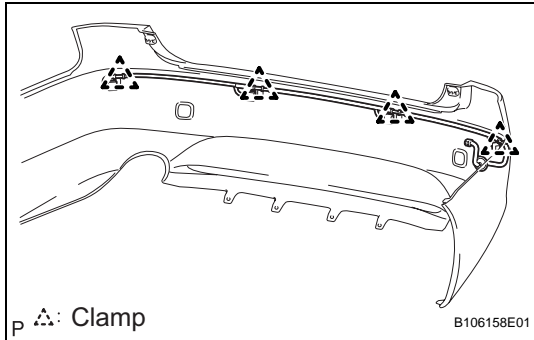

## INSTALLATION

1. **INSTALL REAR BUMPER RETAINER UPPER LH**
  - (a) Install the retainer with the screw and claw.
2. **INSTALL REAR BUMPER RETAINER UPPER RH**

HINT:  
Use the same procedures described for the LH side.

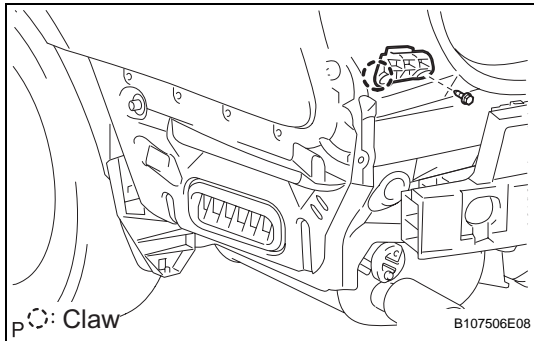

3. **INSTALL REAR BUMPER NO. 2 SIDE SUPPORT LH**
  - (a) Install the side support with the 4 screws and 2 claws.
4. **INSTALL REAR BUMPER NO. 2 SIDE SUPPORT RH**

HINT:  
Use the same procedures described for the LH side.

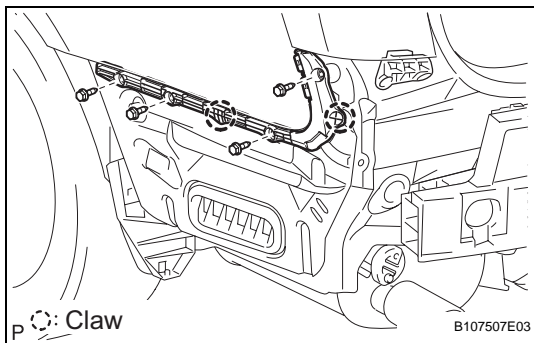

5. **INSTALL REAR BUMPER NO. 1 REINFORCEMENT**
  - (a) Install the reinforcement with the 8 bolts.  
**Torque: 20 N\*m (204 kgf\*cm, 15 ft.\*lbf)**
6. **INSTALL REAR BUMPER BAR**
  - (a) Install the 3 bumper bars.

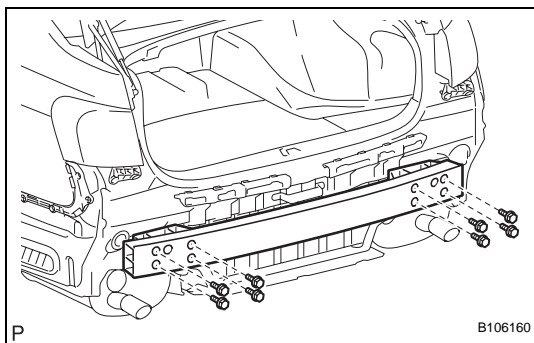

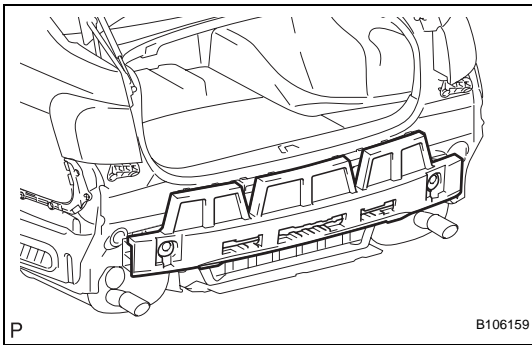
**7. INSTALL REAR BUMPER ENERGY ABSORBER**

- (a) Install the energy absorber to the reinforcement.

**8. INSTALL REAR BUMPER COVER**

- (a) w/ Clearance sonar system:  
Connect the 4 ultrasonic sensor connectors.

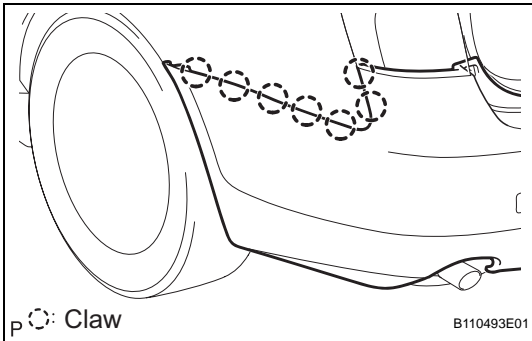

- (b) Attach the 7 claws on the LH side.  
(c) Attach the 7 claws on the RH side.

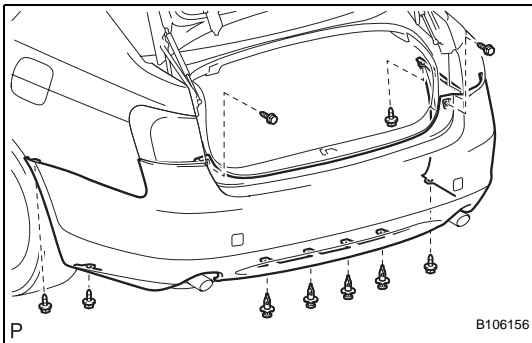

- (d) Install the bumper cover with the 4 clips and 6 screws.

**9. INSTALL REAR BUMPER NO. 1 PLATE**

- (a) Install the 2 bumper plates.

**10. CONNECT CABLE TO NEGATIVE BATTERY TERMINAL****11. PERFORM INITIALIZATION**

- (a) Perform initialization (see page [IN-37](#)).

**CAUTION:**

Certain systems need to be initialized after disconnecting and reconnecting the cable from the negative (-) battery terminal.

**12. CHECK SRS WARNING LIGHT**

- (a) Check the SRS warning light (see page [RS-34](#)).