

# B-Pillar Lower Garnish Damaged

**Service Category** Vehicle Interior

**Section** Interior Panels/Trim

**Market** USA

Lexus Supports  
ASE Certification 

## Applicability

YEAR(S)	MODEL(S)	ADDITIONAL INFORMATION
2006	GS300	
2007 – 2008	GS350	
2006 – 2007	GS430	
2007 – 2008	GS450H	
2008	GS460	

## Introduction

Some 2006-2008 model year GS vehicles may exhibit gouging and scratching on the lower center “B” pillar garnish moldings. A countermeasured garnish molding has been developed to remedy this condition. This bulletin provides updated parts information and recommended repair procedures for replacement of both the RH and LH lower “B” pillar garnish moldings.

## Production Change Information

This TSB applies to vehicles produced **BEFORE** the Production Change Effective VINs shown below.

MODEL	DRIVETRAIN	PLANT	PRODUCTION CHANGE EFFECTIVE VIN
GS350	2WD	Tahara	JTHBE96S#80036681
	AWD		JTHCE96S#80017685
GS460	2WD		JTHBL96S#85002321
GS450h			JTHBC96S#85015065

## Parts Information

PREVIOUS PART NUMBER	CURRENT PART NUMBER	PART NAME	QTY
62413-30211-A0	62413-30250-A0	Garnish Center Pillar, Lower RH	1
62413-30211-B0	62413-30250-B0		1
62413-30211-C0	62413-30250-C0		1

## B-Pillar Lower Garnish Damaged

### Parts Information (Continued)

PREVIOUS PART NUMBER	CURRENT PART NUMBER	PART NAME	QTY
62414-30141-A0	62414-30180-A0	Garnish Center Pillar, Lower LH	1
62414-30141-B0	62414-30180-B0		1
62414-30141-C0	62414-30180-C0		1

### Warranty Information

OP CODE	DESCRIPTION	TIME	OFF	T1	T2
BO7008	Replace Center Pillar Garnish (both sides)	0.4	6241#-50080-##	97	19

#### APPLICABLE WARRANTY

- This repair is covered under the Lexus Comprehensive Warranty. This warranty is in effect for 48 months or 50,000 miles, whichever occurs first, from the vehicle's in-service date.
- Warranty application is limited to correction of a problem based upon a customer's specific complaint.

### Repair Procedure

1. Remove the front door scuff plate LH.

Using a molding remover, detach the 5 claws and remove the scuff plate.

Figure 1.

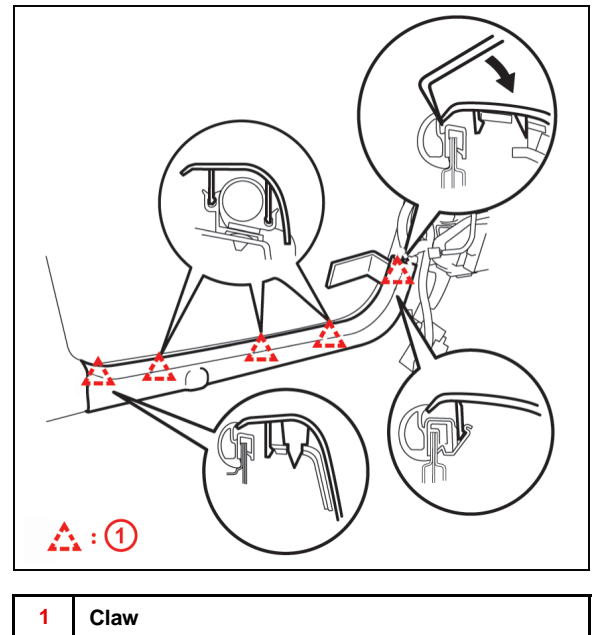

## B-Pillar Lower Garnish Damaged

### Repair Procedure (Continued)

2. Remove the front door scuff plate RH.

**HINT**

Use the same procedures described for the LH side.

3. Remove the front door opening trim cover LH.

Using a molding remover, detach the 3 claws and remove the trim cover.

4. Remove the front door opening trim cover RH

**HINT**

Use the same procedures described for the LH side.

5. Remove the rear door scuff plate LH

Detach the 5 claws and remove the scuff plate.

Figure 2.

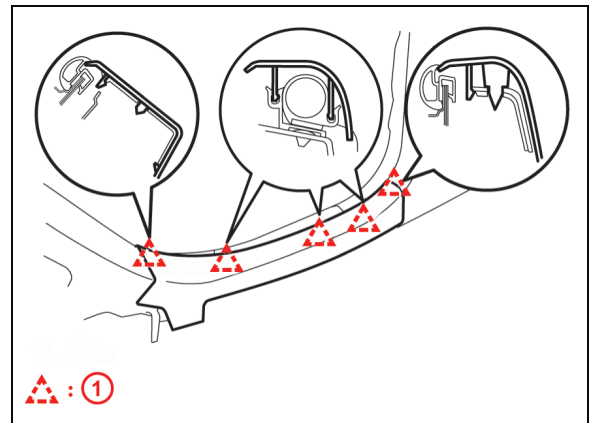

1	Claw
---	------

6. Remove the rear door scuff plate RH

**HINT**

Use the same procedures described for the LH side.

## B-Pillar Lower Garnish Damaged

### Repair Procedure (Continued)

- Remove the center pillar garnish Lower LH

Detach the 2 claws and 5 clips, and remove the garnish.

Figure 3.

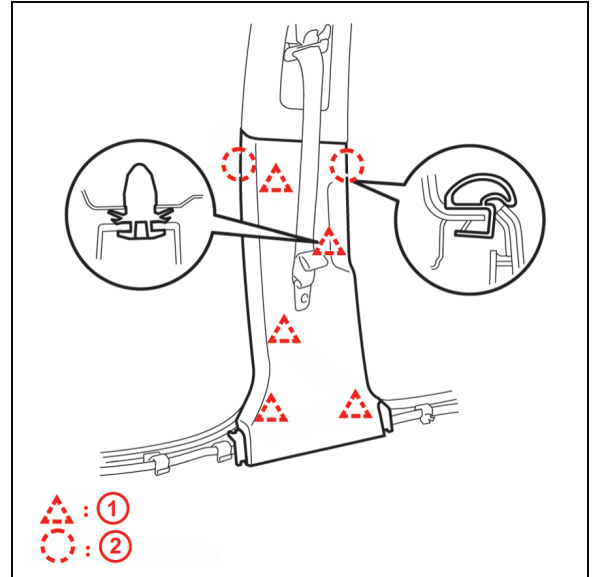

1	Clip
2	Claw

- Remove the center pillar garnish lower RH

**HINT**

Use the same procedures described for the LH side.

- Reinstall in reverse order.