

## Lexus (EU) GS

2JZ-GE/3 (97-05)

### Remote alarm/central locking

#### System operation

##### Type A

- Pressing lock button [Fig102406.1](#) activates alarm and central locking.
- With double locking: Pressing lock button twice within 5 seconds activates double locking system.
- Indicators will flash once.
- Pressing unlock button [Fig102406.2](#) deactivates alarm and central locking.
- Indicators will flash twice and interior lamps illuminate for 15 seconds.
- Some models (if programmed):
  - Holding key lock button [Fig102406.1](#) longer than 3 seconds in depressed position closes windows and sunroof.
  - Holding key unlock button [Fig102406.2](#) longer than 3 seconds in depressed position opens windows and sunroof.
- Pressing key boot/tailgate release button [Fig102406.3](#) for 1 second activates boot/tailgate release.
- If vehicle unlocked and doors or boot/tailgate not opened within 30 seconds, locks are reactivated.

**Note: Alarm/central locking functions can be altered.**

- Interior movement sensors can be deactivated as detailed in owner's handbook.

##### Type B

- Pressing lock button [Fig102406.1](#) activates alarm and central locking.
- With double locking: Pressing lock button twice within 5 seconds activates double locking system.
- Indicators will flash once.
- Pressing unlock button [Fig102406.2](#) deactivates alarm and central locking.
- Indicators will flash twice and interior lamps illuminate for 15 seconds.
- Some models (if programmed):
  - Holding key lock button [Fig102406.1](#) longer than 3 seconds in depressed position closes windows and sunroof.
  - Holding key unlock button [Fig102406.2](#) longer than 3 seconds in depressed position opens windows and sunroof.
- If vehicle unlocked and doors or boot/tailgate not opened within 30 seconds, locks are reactivated.

**Note: Alarm/central locking functions can be altered.**

- Interior movement sensors can be deactivated as detailed in owner's handbook.

[View more information](#)

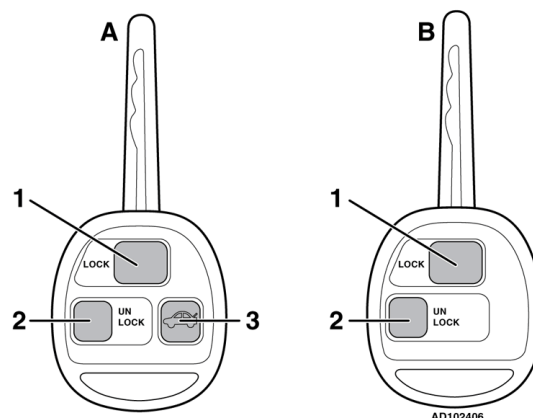

## Programming

### When

- Key added or replaced.
- System malfunction.

### How

- Driver's door open and key removed from ignition switch.
- Insert key into ignition switch, then remove it.
- Within 40 seconds:
  - Press lock and unlock on the vehicle door lock control switch at 1 second intervals 5 times.
  - Close and re-open driver's door.
- Within 40 seconds:
  - Press lock and unlock on the vehicle door lock control switch at 1 second intervals 5 times.
  - Insert key into ignition switch.
  - Switch ignition ON and OFF once to program a new key code whilst retaining the original codes or twice to program a new key code whilst erasing the original codes.
  - Remove key from ignition switch.
- System should now lock and unlock vehicle, once or twice depending which mode has been selected.
- Within 40 seconds:
  - Simultaneously press and hold key lock and unlock buttons for a maximum of 1,5 seconds.
  - Within 3 seconds: Press any key button for a minimum of 1 second.
- System should now lock and unlock vehicle once.

**Note: If system locks and unlocks vehicle twice, programming procedure has not been completed. Repeat programming procedure.**

- Within 40 seconds:
  - If required repeat button procedure to program remaining keys.

**Note: To exit programming mode: Close driver's door or insert ignition key.**

**Note: A maximum of 4 keys can be programmed.**

## Battery replacement

### Battery replacement

[View more information](#)

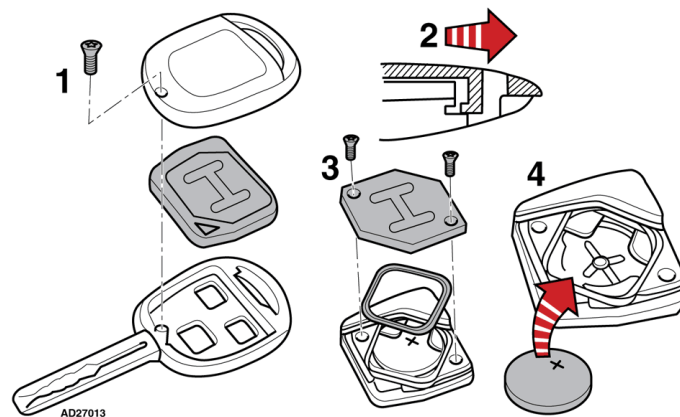

Fig27013

## Immobilizer - if fitted

---

## System operation

- Arms after switching ignition OFF.
- Immobilizer warning lamp flashes.

## Programming

### When

- System malfunction.
- Key added or replaced.

### How - black key

- Obtain 1 programmed black key.
  - Insert programmed black key into ignition switch.
- Within 15 seconds: Press and release accelerator pedal 5 times.
- Within 20 seconds:
  - Press and release brake pedal 6 times.
  - Remove black key.
- Within 10 seconds: Insert black key to be programmed into ignition switch.
- Within 10 seconds: Press and release accelerator pedal once.
- Immobilizer warning lamp will flash.
- After 1 minute immobilizer warning lamp will extinguish.
- If programming another key:
  - Within 10 seconds: Insert black key to be programmed into ignition switch.
  - Press and release accelerator pedal once.
- Immobilizer warning lamp will flash.
- After 1 minute immobilizer warning lamp will extinguish.

**Note: To exit programming mode: Remove ignition key and press brake pedal at least once within 10 seconds, or wait 10 seconds.**

- Keys can also be programmed using diagnostic equipment.

**Note: A maximum of 7 black keys can be programmed.**

### How - grey key

**Note: Grey key will not operate boot/tailgate lock.**

- Obtain 1 programmed black key.
  - Insert programmed black key into ignition switch.
- Within 15 seconds: Press and release accelerator pedal 4 times.
- Within 20 seconds:
  - Press and release brake pedal 5 times.
  - Remove black key.
- Within 10 seconds: Insert grey key to be programmed into ignition switch.
- Within 10 seconds: Press and release accelerator pedal once.
- Immobilizer warning lamp will flash.
- After 1 minute immobilizer warning lamp will extinguish.
- If programming another key:
  - Within 10 seconds: Insert grey key to be programmed into ignition switch.
  - Press and release accelerator pedal once.
- Immobilizer warning lamp will flash.
- After 1 minute immobilizer warning lamp will extinguish.

**Note: To exit programming mode: Remove ignition key and press brake pedal at least once within 10 seconds, or wait 10 seconds.**

- Keys can also be programmed using diagnostic equipment.

**Note: A maximum of 3 grey keys can be programmed.**

©Copyright and database rights: Autodata Limited 1974-2016.