

Last Modified: 7-13-2007		1.6 G
Service Category: Steering	Section: Power Assist Systems	
Model Year: 2008	Model: ES350	Doc ID: RM000001S2N00FX
Title: POWER STEERING: POWER STEERING LINK: INSPECTION (2008 ES350)		

INSPECTION

1. INSPECT POWER STEERING RACK

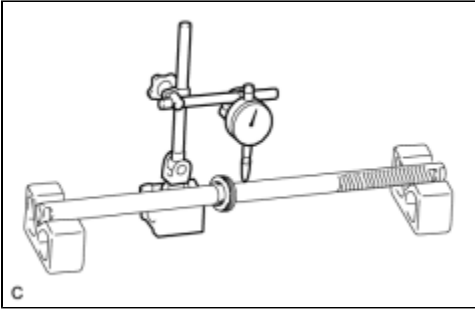

(a) Using a dial indicator, check for teeth wear and runout of the steering rack.

Maximum runout:
0.3 mm (0.0118 in.)

NOTICE:

Make sure that the steering rack is placed horizontally.

If runout exceeds the maximum, replace the power steering link assembly.

(b) Check the rack surface for wear and damage.

2. INSPECT TIE ROD ASSEMBLY LH

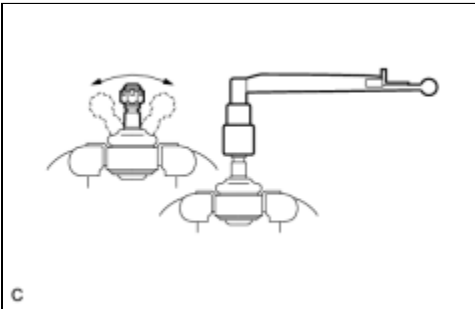

(a) Secure the tie rod end assembly LH in a vise.

(b) Install the nut to the stud bolt.

(c) Flip the ball joint back and forth 5 times or more.

(d) Using a torque wrench, turn the nut continuously at a rate of 3 to 5 seconds per turn and take the torque reading on the 5th turn.

Torque: 0.98 to 3.92 N·m (10 to 40 kgf·cm, 8.7 to 34.7 in·lbf)

If turning torque is not within the specified range, replace the tie rod assembly LH.

3. INSPECT TIE ROD ASSEMBLY RH

HINT:

Perform the same procedure as for the LH side.

4. INSPECT TOTAL PRELOAD

(a) Temporarily install the 2 steering rack ends to the power steering rack.

NOTICE:

Do not fully turn the power steering rack without the steering rack ends as it may damage the oil seal in the rack housing.

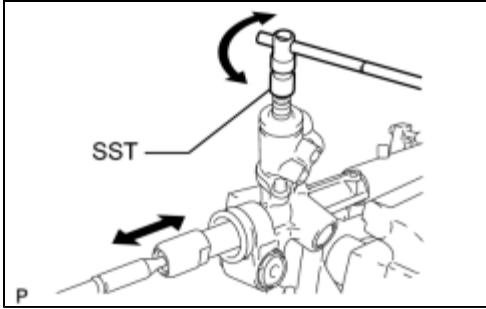

(b) Using SST, fully turn the power steering rack right and left 10 times to settle it.

SST: 09616-00011

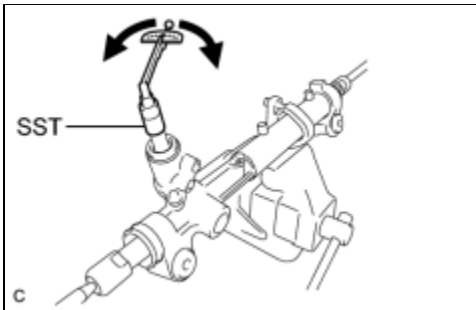

(c) Using SST, turn the control valve and measure the preload.

SST: 09616-00011

Torque: 1.5 N·m (15.3 kgf·cm, 13.3 in·lbf)

If the preload exceeds the specified value, go back to INSTALL RACK GUIDE [INFO](#).

(d) Remove the 2 steering rack ends from the power steering rack.

